

The dynamic efficiency is **0.96** for all ratios

Input speed (n_1) = 1400 min⁻¹

| Output speed n_2 [min ⁻¹] | Ratio i | Motor power P_{1M} [kW] | Output torque M_{2M} [Nm] | Service factor f_s | Nominal power P_{1R} [kW] | Nominal torque M_{2R} [Nm] | B5 motor flanges | | B14 motor flanges | | | Output shaft  | Ratio code |
|--|--------------|------------------------------|--------------------------------|-------------------------|--------------------------------|---------------------------------|------------------|---|-------------------|----------|----------|---|------------|
| | | | | | | | - | - | -Q 71 | -R 80 | -T 90 | | |
| 192 | 7.29 | 1.5 | 71 | 1.3 | 2.0 | 95 | | | C | C | | 2811 | 01 |
| 125 | 11.20 | 1.5 | 110 | 1.4 | 2.0 | 150 | | | C | C | | 288 | 02 |
| 106 | 13.18 | 1.5 | 129 | 1.2 | 1.7 | 150 | | | C | C | | 1911 | 03 |
| 92 | 15.27 | 1.1 | 109 | 1.4 | 1.5 | 150 | | | C | C | | 1711 | 04 |
| 78 | 17.93 | 1.1 | 128 | 1.2 | 1.3 | 150 | | | C | C | | 1511 | 05 |
| 69 | 20.25 | 1.1 | 145 | 1.0 | 1.1 | 150 | | | C | C | | 198 | 06 |
| 65 | 21.40 | 1.1 | 153 | 1.0 | 1.1 | 150 | | | C | C | | 1311 | 07 |
| 60 | 23.47 | 0.75 | 115 | 1.3 | 0.98 | 150 | | | C | C | | 178 | 08 |
| 51 | 27.55 | 0.75 | 135 | 1.1 | 0.83 | 150 | | | C | C | | 158 | 09 |
| 47.9 | 29.21 | 0.75 | 143 | 1.0 | 0.78 | 150 | | | C | C | | 1011 | 10 |
| 42.6 | 32.88 | 0.75 | 161 | 0.9 | 0.70 | 150 | | | C | C | | 138 | 11 |
| 36.7 | 38.12 | 0.55 | 138 | 1.1 | 0.60 | 150 | | | C | C | | 911 | 12 |
| 31.2 | 44.89 | 0.55 | 163 | 0.9 | 0.51 | 150 | | | C | C | | 108 | 13 |
| 27.8 | 50.34 | 0.37 | 122 | 1.1 | 0.40 | 131 | | | C | C | | 711 | 14 |
| 23.9 | 58.58 | 0.37 | 142 | 1.1 | 0.39 | 150 | | | C | C | | 98 | 15 |
| 18.1 | 77.36 | 0.25 | 126 | 1.2 | 0.30 | 150 | | | C | C | | 78 | 16 |

Motor flanges available
Flange motore disponibili



B) Supplied with reduction bushing
Fornito con bussola di riduzione



B) Available on request without reduction bushing
Disponibile a richiesta senza bussola di riduzione



C) Motor flange holes position
Posizione fori flangia motore

Lubrication

Lubrificazione

Unit X42I is supplied with synthetic oil to assure long life lubrication. Food grade oil is available on request.

See Table 1 for lubrication and recommended quantity.



See Table 2 for possible radial and axial loads on the gearbox.

Il riduttore tipo X42I viene fornito con olio sintetico e lubrificazione tipo "long life".

Disponibile a richiesta olio alimentare.

Vedi Tabella 1 per oli e quantità consigliati.

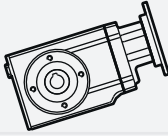
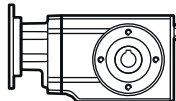
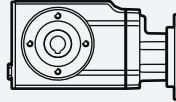
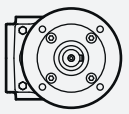
Vedi Tabella 2 per i carichi radiali e assiali applicabili al riduttore.

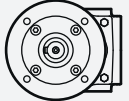
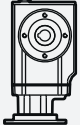
| | | | |
|------------------------------------|---|------------------------------------|---|
| Agip Telium VSF 320 | Shell Omala S4 WE 320 | V8 On request ASK |  |
| B3 Standard 0.85 LT |  | B8 On request 1.00 LT |  |
| B6 On request 0.95 LT |  | V5 On request 1.60 LT |  |
| B7 On request 0.85 LT |  | V6 On request 1.00 LT |  |

For more details on lubrication and plugs check our website.

Per maggiori dettagli su lubrificazione e tappi olio vedi il nostro sito web.

Tab. 1

Radial and axial loads

Carichi radiali e assiali

Output shaft

Albero di uscita

| n_2 [min ⁻¹] | F_A [N] | F_R [N] |
|----------------------------|-----------|-----------|
| 250 | 500 | 2500 |
| 150 | 600 | 3000 |
| 100 | 700 | 3500 |
| 75 | 800 | 4000 |
| 50 | 960 | 4800 |
| 25 | 960 | 4800 |
| 15 | 960 | 4800 |

$$F_{eq} = F_R \cdot \frac{54}{X + 28}$$

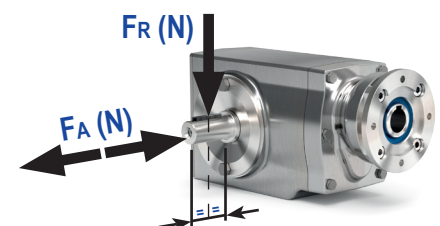
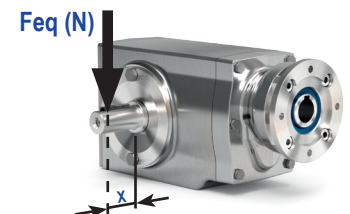

Tab. 2

150
Nm

X421

PX421I...

Basic gearbox
Riduttore base

Gearbox weight
peso riduttore **13.0 kg**

| M. flanges | Kit code | øF | A |
|------------|----------|-----|-------|
| 71B14 | KI634047 | 105 | 197.5 |
| 80B14 | KI634046 | 120 | 199.5 |
| 90B14 | KI634041 | 140 | 199.5 |

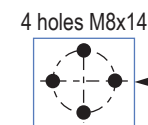
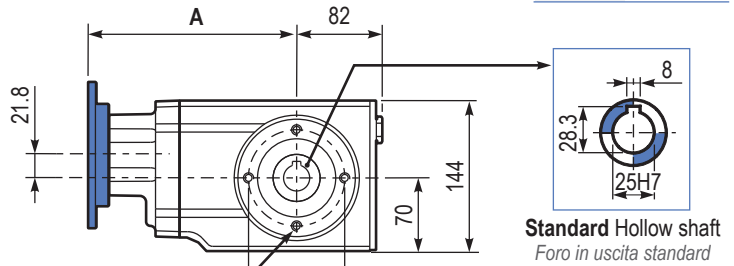
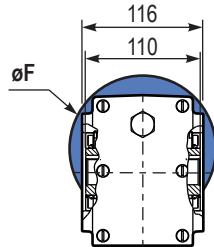

Mounting holes position
Posizione fori di montaggio

PX421-FB..

Feet
Piedini

PX421-FL..

Output flange
Flangia uscita

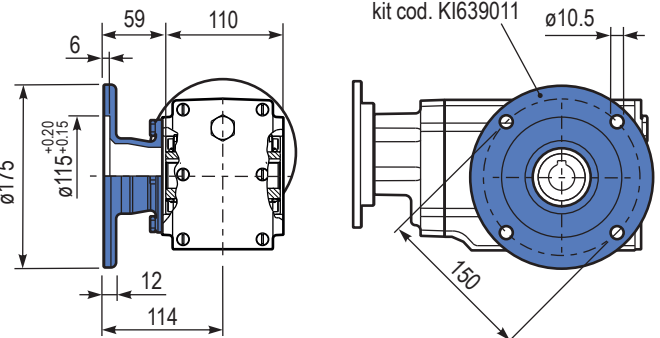
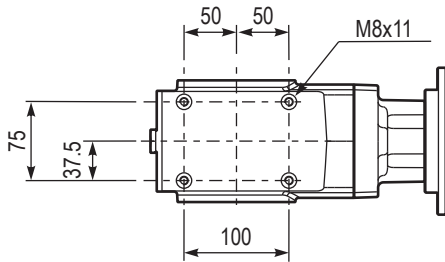

PX421..A..

Single output shaft
Albero semplice in uscita

PX421BR..

Reaction Arm
Braccio di reazione

kit cod. KI630211

Protection cap (on request)

A richiesta coperchio di protezione

kit cod. KX4I5028

