

SHAFT MOUNTED GEARBOXES

Cast Iron Compact-Gear

Flanges for servomotors - Flange per servomotori

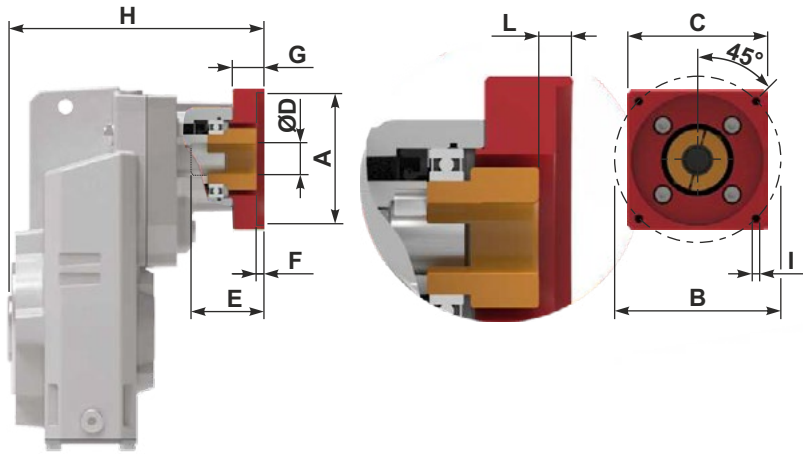

Input flanges Kit Code	Bushing Kit Code	Coupling Kit Code	Motor shaft Ø	Type										FC62 FC63 FC72 FC73					
				A	B	C	ØD	E	F	G	L	I	H	Nm	675	675	900	900	
K0634072	KBR1422G	KC405190L	Ø14	60	75	90	Ø22	51.5	4.5	21	9	M5x12		244		255.5			
K0634073	KBR1422G	KC405190L	Ø14	50	70	80	Ø22	51.5	4.5	21	9	M5x12		244		255.5			
K0634074	KBR1422G	KC405190L	Ø14	80	100	85	Ø22	51.5	4.5	21	9	M6x12		244		255.5			
K0634075	KBR1922G	KC405190L	Ø19	95	115	100	Ø22	51.5	4.5	21	9	M8x12		244		255.5			
K0634076	-	KC405190L	Ø22	110	145	130	Ø22	56.5	4.5	26	14	M8x14		249		260.5			
K0634078	KBR1922G	KC405190L	Ø19	70	90	90	Ø22	51.5	4.5	21	9	M6x12		244		255.5			
K0854075	KBR1924G	KC505190L	Ø19	95	115	100	Ø24	54	4.5	22	9.5	M8x14	235		246.5				
K0854076	KBR2224G	KC505190L	Ø22	110	145	130	Ø24	58	5	26	13.5	M8x14	239		251.5				
K0854077	-	KC505190L	Ø24	130	165	140	Ø24	54	5	22	9.5	M8x14	235		246.5				
K0854078	KBR1924G	KC505190L	Ø19	70	90	95	Ø24	54	4.5	22	9.5	M6x14	235		246.5				



Supplied with
reduction bushing
Fornito con
bussola di riduzione



Coupling
Giunto

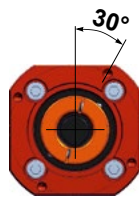

K0634078

Fixing holes
shifted by 30°
Fori fissaggio
motore ruotati
a 30°



**K0634072
K0634073**

Fixing holes
shifted by 25°
Fori fissaggio
motore ruotati
a 25°

Reduction
Bushing
Bussola di
riduzione

