

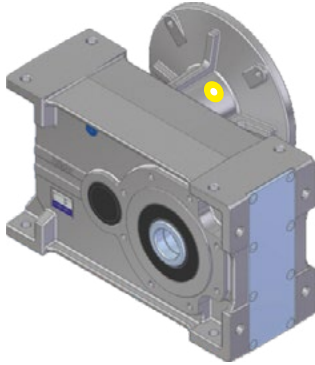

ATEX Reducer category 2 Riduttore ATEX categoria 2



CODE **AX121**

- Use of synthetic oil and with oil plugs (oil plugs when possible).
- VITON oil seals.
- Loctite on all external screws.
- Double input seals, when possible.
- Additional output oil seals when possible.
- Indication of maximum temperature gauge.
- Utilizzo di olio sintetico e con tappi olio (tappi olio dove è possibile).
- Anelli di tenuta in VITON.
- Frena filetti su tutte le viti fissaggio esterne.
- Doppio anello di tenuta in entrata, dove è possibile
- Anelli di tenuta supplementare in uscita dove è possibile.
- Indicatore visivo di temperatura di massima.

Advised / Sugerito



Atex Cat. 2

For more information see our guide «Atex installation and maintenance guide» on our website.

Per ulteriori informazioni, consultare la nostra guida « Atex guida alla manutenzione e installazione » sul nostro sito..

ATEX Reducer category 3 Riduttore ATEX categoria 3

CODE **AX222**

- Use of synthetic oil and with oil plugs (oil plugs when possible).
- Utilizzo di soli olio sintetico e con tappi olio (tappi olio dove è possibile).

Advised / Sugerito



Atex Cat. 3

For more information see our guide «Atex installation and maintenance guide» on our website.

Per ulteriori informazioni, consultare la nostra guida « Atex guida alla manutenzione e installazione » sul nostro sito..

Anticorrosive paint Vernice anticorrosiva

CODE **VEACB**

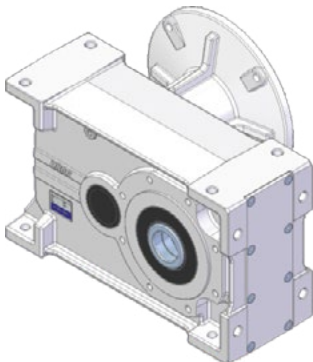

Color flat GREY RAL 7035

The coating is exceptionally hard, slippery, and then compact presents a tremendous resistance to abrasion. Finds its use where the protection is required by agents external aggressive and corrosive.

Colore flat GREY RAL 7035

il rivestimento risulta eccezionalmente duro, scivoloso, compatto e quindi presenta una fortissima resistenza ad abrasione. Trova il suo utilizzo la dove è necessaria una protezione da agenti esterni aggressivi e corrosivi.

Advised / Sugerito

Food industry.
Industria alimentare.

Oil for low temperature and food Olio per basse temperature e alimenti

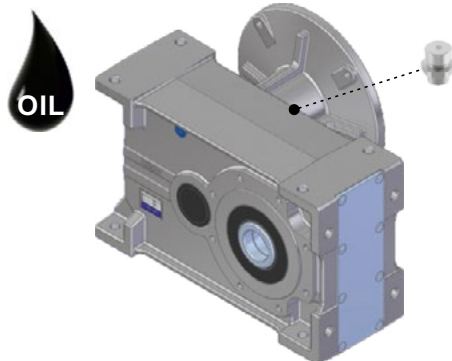

CODE **OB150**

Agip Blasias 150
Shell Omala 150
Oil for low temperature
Olio per basse temperature

Advised / Sugerito

Low temperature.

* With pressure oil valve plug

Basse temperature.

* con tappo olio con valvola



CODE **OF320**

Mobil SHC Cibus 320
Oil for food
Olio per alimenti

Oil for food.

Olio per alimenti.

CODE **OS320**

Shell Omala 320
Synthetic oil only for H71/2/3C and H81/2/3C.
Olio sintetico solo per H71/2/3C e H81/2/3C.

All plugs closed, low internal pressure.
Tappi chiusi, bassa pressione interna.

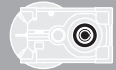

Double input oil seal
Doppio anello di tenuta in entrata

CODE **2ATEN**

Advised / Sugerito

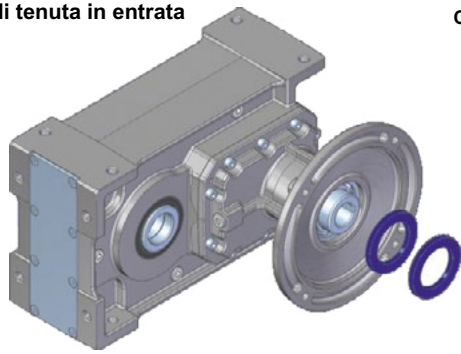

Ideal for V6 vertical position.
Ideale per posizione verticale V6.

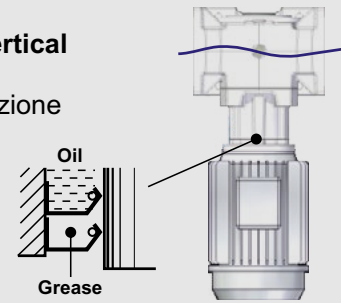

	H62C / H72C	H63C / H73C	H82C	H83C	
IEC	56 B5	—	—	—	
	63 B5	—	35x47x7	—	
	71 B5	45x62x7	35x47x7	—	45x62x7
	80÷90 B5	45x62x7	35x47x7	—	45x62x7
	100÷112 B5	Not available	Not available	—	Not available
	132 B5	Not available	—	Not available	Not available
	160 B5	—	—	Not available	—
	180 B5	—	—	Not available	—
	56 B14	—	—	—	—
	63 B14	—	—	—	—
71 B14	—	35x47x7	—	—	
80 B14	Not available	35x47x7	—	Not available	
90 B14	Not available	35x47x7	—	Not available	
100÷112 B14	45x62x7	Not available	—	45x62x7	
132 B14	Not available	—	—	Not available	
NEMA	56C	45x62x7	35x47x7	—	45x62x7
	143/5TC	45x62x7	35x47x7	—	45x62x7
	182/4TC	45x62x7	—	Not available	45x62x7
	213/5TC	Not available	—	Not available	Not available
	254/6TC	—	—	Not available	—

Output shaft Viton oil seals
Anelli di tenuta uscita in Viton

CODE **ATVIU**

Advised / Sugerito

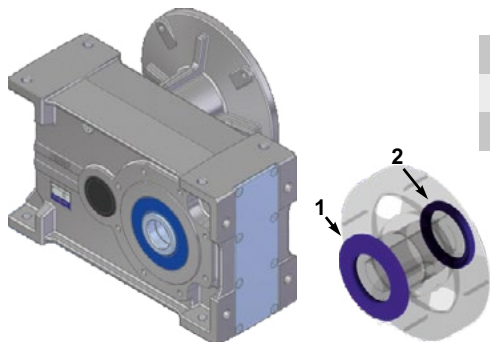

	1	2
H61/2/3	55x100x10	55x80x8
H71/2/3	65x120x12	65x85x10
H81/2/3	75x130x10	75x100x10

For ambient temperature >40°C
Per temperatura ambiente >40°C



Life lubricated bearings
Cuscinetti lubrificati a vita

CODE **MONV6**

Advised / Sugerito

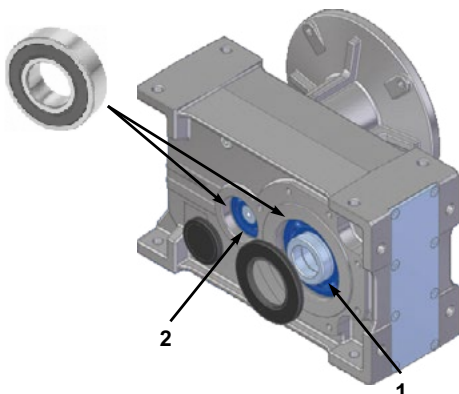

	1
H61/2/3C	6211
H71/2/3C	6213
H81/2/3C	6215
	2
H61/2/3C	6204
H71/2/3C	6204
H81/2/3C	6306

Ideal for V6 vertical position.
Ideale per posizione verticale V6.

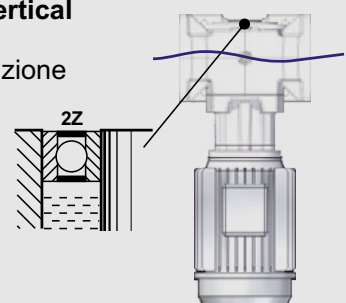



Life lubricated bearings
Cuscinetti lubrificati a vita

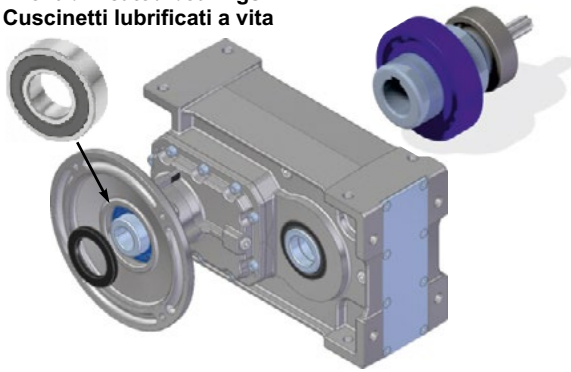

CODE **MONV5**

	Type
H63C H73C	6007
H62C H72C H83C	6009
H61C H71C	6011
H82C	6013
H81C	6014

Advised / Sugerito

Ideal for V5 vertical position.
Ideale per posizione verticale V5.

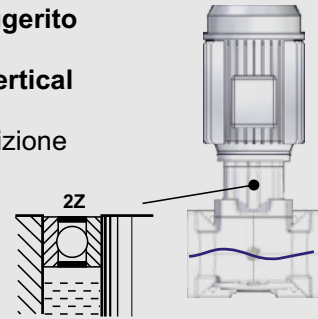

Special hollow shaft
Albero uscita speciale

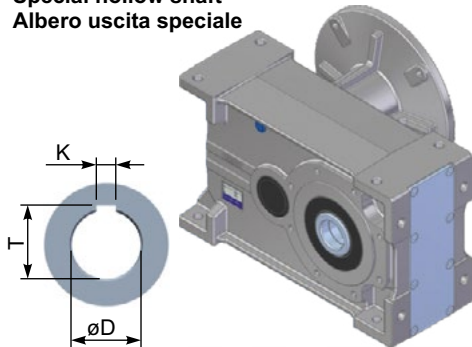

CODE **ACR...**

	øD	T	K	CODE
H61/2/3C	40	43.3	12	ACR40
H71/2/3C	45	48.8	14	ACR45
H81/2/3C	55	59.3	16	ACR55

Advised / Sugerito

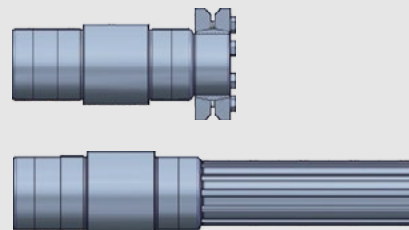

Shrink disk and kit closing shrink disk cup
Calettatore e Kit protezione calettatore

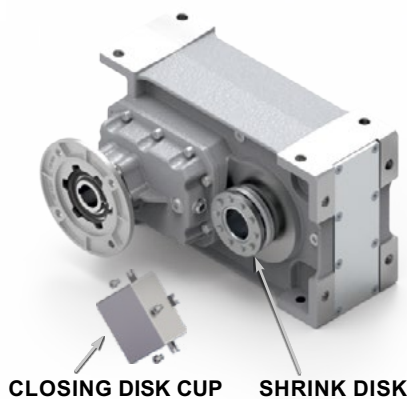

CLOSING DISK CUP CODE

H62/3C	KF600210LM
H72/3C	KF700210LM
H82/3C	KF800210LM

SHRINK DISK CODE

H62/3C	KF600165
H72/3C	KF700165
H82/3C	KF800165

Advised / Sugerito

Frequent starts and stops.
Frequenti avvii e arresti.

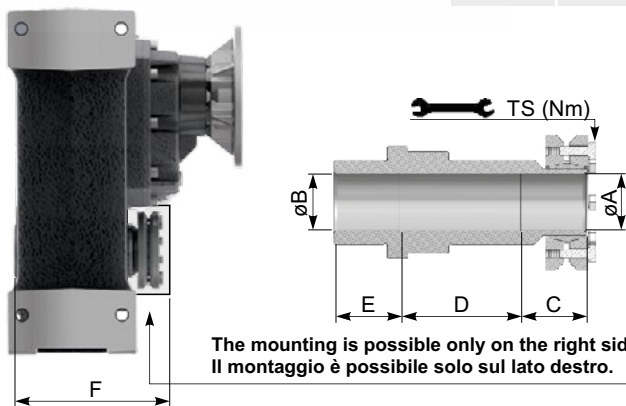

The mounting is possible only on the right side.
Il montaggio è possibile solo sul lato destro.

	øA H7	øB H7	C	D	E	F	TS Nm
H62/3C	35	35	30	97.5	30	173	12
H72/3C	40	40	42	97	42	197	12
H82/3C	50	50	35	133	35	215	12

Dimensions and tightening torque (TS) for the shrink disc.
Dimensioni e coppia serraggio vite per calettatore.



Flanges for servomotors Flange per servomotori

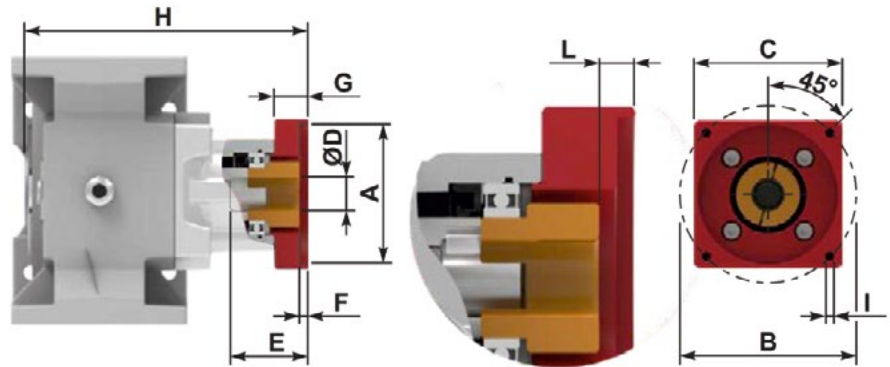

Input flanges Kit Code	Bushing Kit Code	Coupling Kit Code	Motor shaft Ø	Type												
				A	B	C	ØD	E	F	G	L	I	H			
K0634072	KBR1422G	KC405190L	Ø14	60	75	90	Ø22	55.5	4.5	25	9	M5x12		244		255.5
K0634073	KBR1422G	KC405190L	Ø14	50	70	80	Ø22	55.5	4.5	25	9	M5x12		244		255.5
K0634074	KBR1422G	KC405190L	Ø14	80	100	85	Ø22	55.5	4.5	25	9	M6x12		244		255.5
K0634075	KBR1922G	KC405190L	Ø19	95	115	100	Ø22	55.5	4.5	25	9	M8x12		244		255.5
K0634076	-	KC405190L	Ø22	110	145	130	Ø22	60.5	4.5	30	14	M8x14		249		260.5
K0634078	KBR1922G	KC405190L	Ø19	70	90	90	Ø22	55.5	4.5	25	9	M6x12		244		255.5
K0854075	KBR1924G	KC505190L	Ø19	95	115	100	Ø24	58	4.5	26	22	M8x14	235			246.5
K0854076	KBR2224G	KC505190L	Ø22	110	145	130	Ø24	62	5	30	26	M8x14	239			250.5
K0854077	-	KC505190L	Ø24	130	165	140	Ø24	58	5	26	22	M8x14	235			246.5
K0854078	KBR1924G	KC505190L	Ø19	70	90	95	Ø24	58	4.5	26	22	M6x14	235			246.5

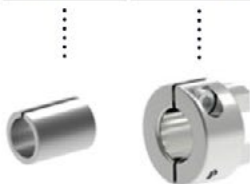

Supplied with
reduction bushing
Fornito con
bussola di riduzione

Coupling
Giunto



K0634078

Fixing holes
shifted by 30°
Fori fissaggio
motore ruotati
a 30°



**K0634072
K0634073**

Fixing holes
shifted by 25°
Fori fissaggio
motore ruotati
a 25°



Housing with oil level plugs
Cassa con tappo livello olio

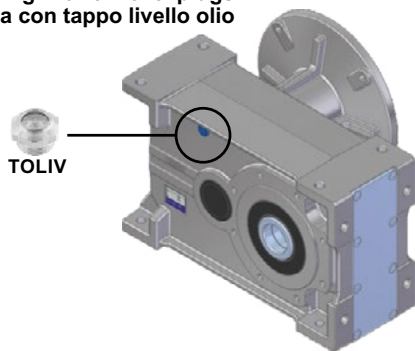

CODE **TOLIV**

	Type
H61/62/63C	3/8G
H71/62/63C	3/8G

Advised / Suggestito

With level oil plug.
Con tappo livello.

For more information you see our website.
Per ulteriori informazioni consultare il sito.

Input with Viton oil seal
Anello di tenuta
Viton in entrata

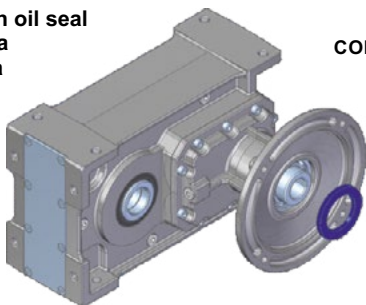

CODE **Input without coupling
Entrata senza giunto**

	Type
H62C H72C H83C	45x62x8
H63C H73C	35x47x7

Advised / Suggestito

For ambient temperature >40°C
Per temperatura ambiente >40°C



NEMA input flange.
Flangia entrata NEMA.

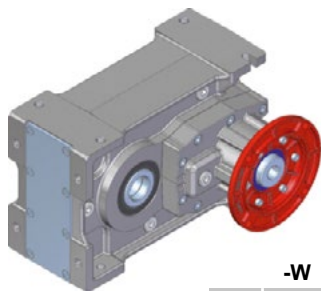

CODE **FLENU**

Advised / Suggestito

USA , CANADA, MEXICO.

	-W	-X	-Y	AA	AB
H62C H72C	56C-0.625	143/5TC-0.875	182/4TC-1.125	213/5TC-1.375	—
H63C H73C	56C-0.625	143/5TC-0.875	—	—	—
H82C	—	—	182/4TC-1.125	213/5TC-1.375	254/6TC-1.625
H83C	56C-0.625	143/5TC-0.875	182/4TC-1.125	213/5TC-1.375	—

Without NEMA flange
Senza flangia NEMA.

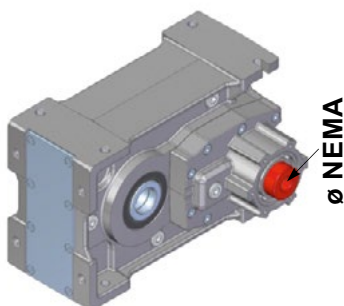

	-K	-N	-S	UA	UB
H62C H72C	0.625	0.875	1.125	—	—
H63C H73C	0.625	0.875	—	—	—
H82C	—	—	1.125	1.375	1.625
H83C	0.625	0.875	1.125	—	—