

#### QUICK SELECTION / Selezione veloce

input speed ( $n_1$ ) = 1400 min<sup>-1</sup>

Output Speed $n_2$ [min <sup>-1</sup> ]	Ratio $i$	Motor power $P_{1M}$ [kW]	Output torque $M_{2M}$ [Nm]	Service factor f.s.	Nominal power $P_{1R}$ [kW]	Nominal torque $M_{2R}$ [Nm]	Available B5 motor flanges		Available B14 motor flanges		Dynamic efficiency <b>RD</b>	Tooth Module  [mm]	Ratios code 
							-A	-B	-O	-P			
							56	63	56	63			
9.3	<b>150</b>	0.06	29	1.3	<b>0.08</b>	<b>38</b>	<b>B</b>		<b>B-C</b>		48	1.44	01
6.7	<b>210</b>	0.06	39	1.0	<b>0.06</b>	<b>38</b>	<b>B</b>		<b>B-C</b>		45	1.44	02
4.7	<b>300</b>	0.06	44	0.9	<b>0.05</b>	<b>38</b>	<b>B</b>		<b>B-C</b>		36	1.44	03
3.1	<b>450</b>	0.06*	38	<0.8	<b>0.04</b>	<b>38</b>	<b>B</b>		<b>B-C</b>		33	1.44	04
2.3	<b>600</b>	0.06*	38	<0.8	<b>0.03</b>	<b>38</b>	<b>B</b>		<b>B-C</b>		30	1.44	05
1.6	<b>900</b>	0.06*	38	<0.8	<b>0.02</b>	<b>38</b>	<b>B</b>		<b>B-C</b>		27	1.44	06
1.2	<b>1200</b>	0.06*	38	<0.8	<b>0.02</b>	<b>38</b>	<b>B</b>		<b>B-C</b>		26	1.44	07
0.8	<b>1830</b>	0.06*	38	<0.8	<b>0.01</b>	<b>38</b>	<b>B</b>		<b>B-C</b>		24	1.44	08
0.6	<b>2400</b>	0.06*	38	<0.8	<b>0.01</b>	<b>38</b>	<b>B</b>		<b>B-C</b>		22	1.44	09

**A) Motor Flanges Available**  
Flange Motore Disponibili

**B) Supplied with Reduction Bushing**  
Fornito con Bussola di Riduzione

**B) Available on Request without reduction bushing**  
Disponibile a Richiesta senza Bussola di Riduzione

**C) Motor Flange Holes Position**  
Posizione Fori Flangia Motore

\* Power higher than the maximum one which can be supported by the gearbox. Select according to the torque  $M_{2R}$   
Potenza superiore a quella massima sopportabile dal riduttore. Selezionare in base al momento torcente  $M_{2R}$

**EN** Unit **33M** is supplied with synthetic oil, providing "long life" lubrication. For mounting position V5-V6 please contact us. See table 1 for lubrication and recommended quantity. In table 2 please see possible radial loads and axial loads on the gearbox.

**I** Il riduttore tipo **33M** viene fornito lubrificato a vita con olio sintetico. Per posizioni V5-V6 contattare il ns. servizio tecnico. Vedi tab.1 per oli e quantità consigliati. In tab.2 sono presenti i carichi radiali e assiali applicabili al riduttore.

**D** Für die Lebensdauerschmierung ist das Getriebe der Größe **33M** mit synthetischem Öl befüllt. Bei Einbaulage V5 oder V6 bitten wir um Rücksprache. In Tabelle 1 ist die Schmiermenge und das empfohlene Schmiermittel angegeben. In Tabelle 2 sind die zulässigen Radial- und Axialbelastungen des Getriebes aufgeführt.

**F** Le réducteur de type **33M** est fourni lubrifié à vie avec de l'huile synthétique. Concernant les positions V5.V6, contactez notre service d'assistance technique. Voir tableau 1 concernant les huiles et les quantités conseillées. Les charges radiales et axiales applicables au réducteur sont précisées dans le tableau 2.

**E** El reductor tamaño **33M** se suministra, lubricado de por vida con aceite sintético. Para las posiciones V5 y V6 contactar con nuestro servicio técnico. Ver tabla 1, para cantidades y aceites recomendados. En la tabla 2, se encuentran las cargas radiales y axiales admitidas por el reductor.

**LUBRICATION 33M Oil** 0.03 Lt.  
**Quantity 0.03/0.03 Lt.**

<b>SHELL</b> Omala S4 WE 320	<b>ENI</b> Telium VSF 320
------------------------------	---------------------------

For all details on lubrication and plugs check our website **tab. 1**  
Per maggiori dettagli su lubrificazione e tappi olio vedi il nostro sito web

**RADIAL AND AXIAL LOADS**

**Output shaft**  
Albero di uscita

$n_2$ [min <sup>-1</sup> ]	FA [N]	FR [N]
25	300	1800
15	400	2000

**Input shaft**  
albero in entrata

$n_1$ [min <sup>-1</sup> ]	FA [N]	FR [N]
1400	20	100

**\*Strong axial loads in the DX direction are not allowed.**  
Non sono consentiti forti carichi assiali con direzione DX

tab. 2

**P33MFB...** Basic wormbox  
Riduttore base

Gearbox weight  
peso riduttore **2.25 kg**

M. flanges	Kit code	øF	A
56B5	K030.4.041	120	61.5
63B5	K030.4.042	140	62.5
56B14	K030.4.046	80	61.5
63B14	K030.4.045	90	62.5

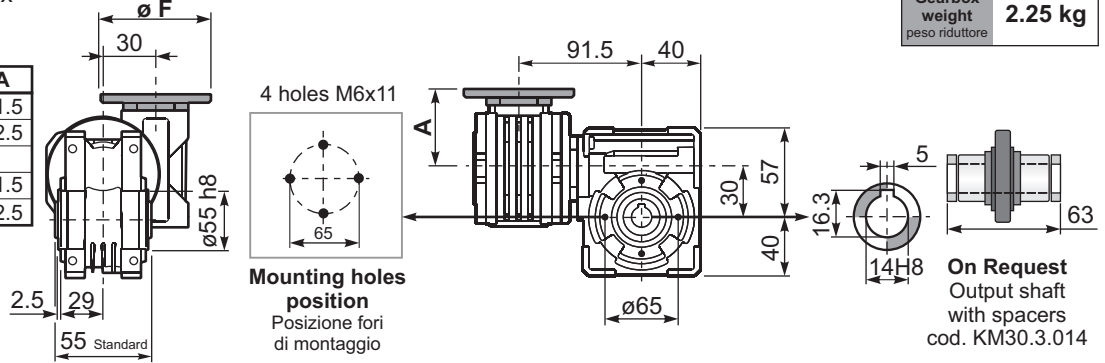

**P33MFC...** Square flange  
Flangia quadrata

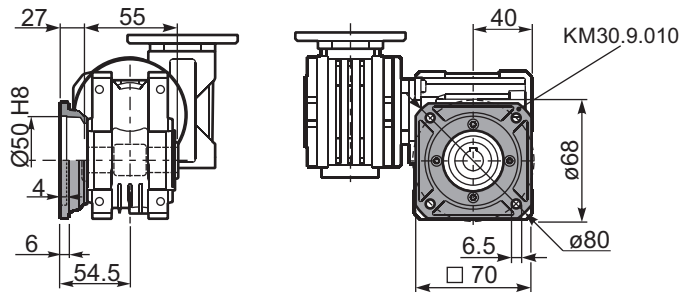

**P33MFB...** Feet  
Piedini

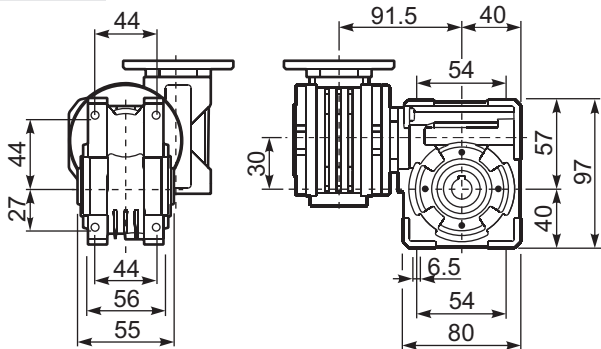

**P33MBR...** Reaction arm  
Braccio di reazione

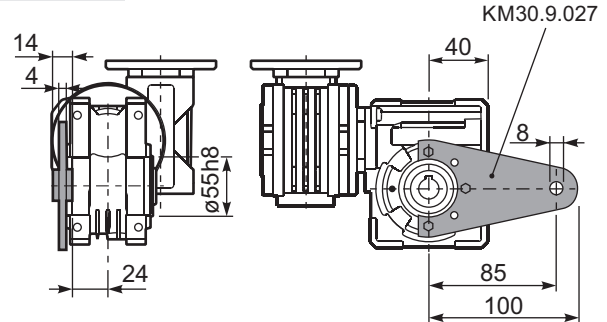

**R33MFB...** Input shaft  
Albero in entrata

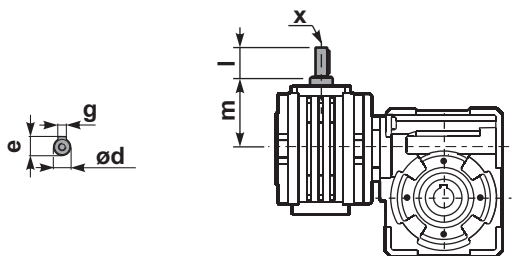

**P33M....S...** Single Shaft  
Albero lento semplice

**P33M....D...** Double Shaft  
Albero lento bisp.

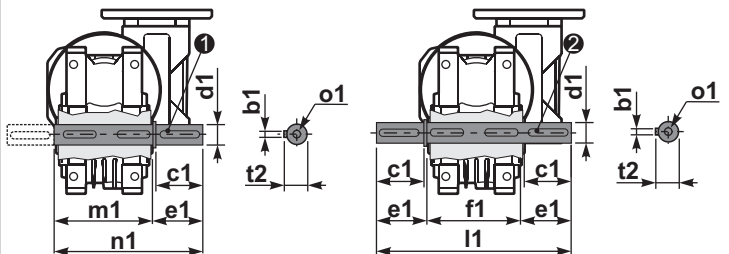

① kit cod. K030.5.028 type B

② kit cod. K030.5.029 type B

	ød	e	g	l	m	x	kit code
type B	9 h6	10.2	3	20	58	-	K030.5.006 PAM63
type S	-	-	-	-	-	-	-

	b1	c1	d1	e1	f1	l1	m1	n1	t2	o1
type B	5	25	14 <sup>-0.005</sup> <sub>-0.020</sub>	35.5	55	126	59	94.5	16	M5x14
type S	-	-	-	-	-	-	-	-	-	-