

Protective paint Vernice protettiva



CODE **VEACB** Worm gearbox Riduttore a vite senza fine

Color flat GREY RAL 7035

The coating is exceptionally hard, slippery, and then compact presents a tremendous resistance to abrasion.

Finds its use where the protection is required by agents external aggressive and corrosive.

Colore flat GREY RAL 7035

Il rivestimento risulta eccezionalmente duro, scivoloso, compatto e quindi presenta una fortissima resistenza ad abrasione.

Trova il suo utilizzo la dove è necessaria una protezione da agenti esterni aggressivi e corrosivi.

Stainless steel hardware / options

Special stainless steel hollow shaft Mozzo in acciaio inox

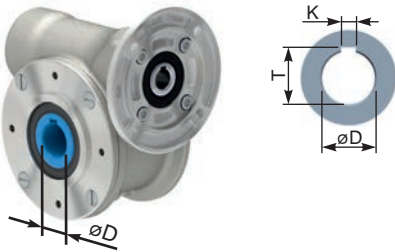

	øD	T	K	CODE
D30	14	16.3	5	MI014
	18	20.8	6	MI018
D45	19	21.8	6	MI019
	20	22.8	6	MI020
D50	24	27.3	8	MI024
	25	28.3	8	MI025
D63	25	28.3	8	MI025
	28	31.2	8	MI028
D85	30	33.3	8	MI030
	35	38.3	10	MI035

Advised / Sugerito

Food industry , marine, corrosive and highly hygienic environments.

Industria alimentare, marino, ambienti corrosivi ad elevata igienicità.

Special stainless output shaft

Albero lento a una sporgenza in acciaio inox

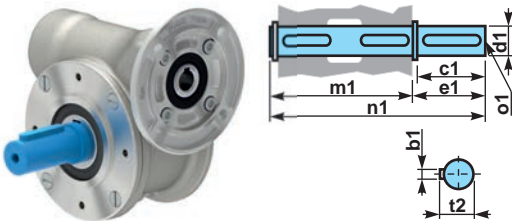

		b1	c1	d1 ^{-0.005} -0.020	e1	m1	n1	o1	t2	Code
D30	3D3	5	25	14	35.5	59	94.5	M5x14	16	KI0305028
D45	4D3	6	32	18	43	70	113	M6x18	20.5	KI0455028
D50	5D3	8	52	25	59.5	86.5	146	M8x20	28	KI0505028
D63	6D3/6D4	8	60	25	63.2	126.8	190	M8x20	28	KI0635028
D85	8D4	10	60	35	73.5	141	214.5	M10x23	38	KI0855028

Stainless steel reaction arm

Braccio di reazione in acciaio inox

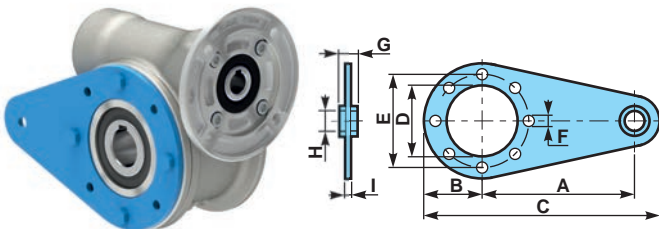

		A	B	C	D	E	F	G	H	I	Code
D30	3D3	100	40	158	51	65	7	-	8.2	4	KN459027
D45	4D3	100	55	173	69	94	7	-	8.2	4	KN509027
D63	6D3/6D4	150	55	235	76	90	9	20	11	6	KN639027
D85	8D4	200	80	320	111	130	11	25	21	6	KN859027

Stainless steel feet

Piedini in acciaio inox

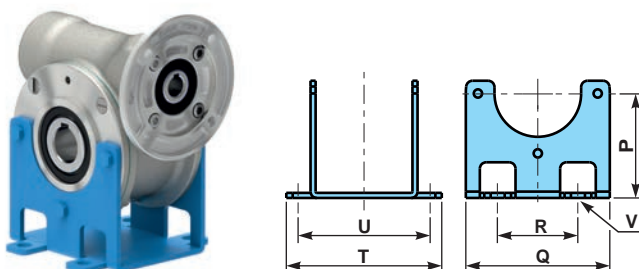

		P	Q	R	T	U	V	Code
D30	3D3	55	78	50	80	66	6.5	KN459027
D45	4D3	72	98	52	100	81	10.5	KN509027
D50	5D3	82	113	63	122	98.5	10.5	KN509027
D63	6D3/6D4	100	133	95	130	111	10.5	KN639027
D85	8D4	142	140	140	176	145	10.5	KN859027

D Series Aluminum worm gearboxes - ACCESSORIES AND OPTIONS

Stainless steel input male shaft *Albero in entrata in acciaio inox*

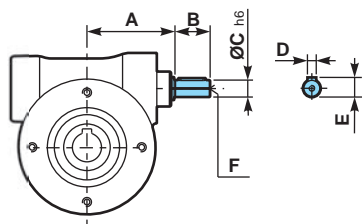

	A	B	ØC _{h6}	D	E	F	Code
D30	50	20	9	3	10.2	-	I305006G
D45	68	30	11	4	12.5	-	I455006G
D50	74.5	30	16	5	18	M6x16	I505006G
D63	93	45	18	6	20.5	M6x16	I635006G
D85	112	50	25	8	28	M8x20	I855006G

Other options

Input shaft Viton oil seals *Anelli di tenuta in entrata Viton*



CODE **ATVIE**

Type (1pcs)

D30	20x37x08
D45	25x40x7
D50	30x40x7 (1/5-1/30)
	25x40x7 (1/36-1/100)
D63	35x47x7
D85	45x75x10

Advised / Suggestito

Ideal for high ambient temperatures and/or high input speed

Ideale per temperature ambiente elevate e/o velocità di ingresso alte.

Input Viton seals for coupling *Viton in entrata per giunto*



CODE **ATVIEC**

Type (1pcs)

D30	20x37x08
D45	25x47x5.5
D50	30x47x7
D63	40x62x7
D85	45x75x10

Advised / Suggestito

Ideal for high ambient temperatures and/or high input speed

Ideale per temperature ambiente elevate e/o velocità di ingresso alte.

Output shaft Viton oil seals *Anelli di tenuta uscita Viton*



CODE **ATVIU**

Type (2pcs)

D30	25x40x7(1pcs) 25x47x7(1pcs)
D45	30x40x7
D50	40x55x7
D63	45x62x7
D85	55x80x8

Advised / Suggestito

Ideal for high ambient temperatures
Ideale per temperature ambiente elevate

Twin viton seals-shield for IP69K *Doppio anello di tenuta con schermo per IP69K*



CODE **2ATUV**

Type (2pcs)

D30	25x40x10V(1pcs) 25x47x8.5V(1pcs)
D45	30x47x10V
D50	40x55x10V
D63	45x62x14.5V
D85	55x80x14.5V

Advised / Suggestito

Ideal for high ambient temperatures
Ideale per temperature ambiente elevate

Stronger oil leaks protection
Protezione con doppio anello di tenuta

Double oil seals on output shaft *Doppio anello di tenuta in uscita*



CODE **2ATUS**

Type (2pcs)

D30	Not available
D45	Not available
D50	Not available
D63	45x62x7
D85	55x80x8

Advised / Suggestito

Stronger oil leaks protection
Protezione con doppio anello di tenuta

Double oil seals on input shaft
Doppio anello di tenuta albero entrata



CODE **2ATEN**

Advised / Suggestito

Ideal for V6 vertical position.

Ideale per posizione verticale V6.

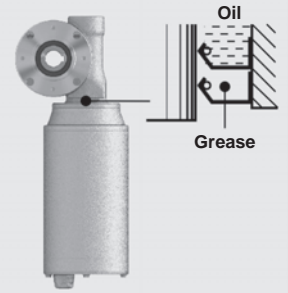

		D30	D45	D50	D63	D85
IEC	56 B5	20x30x7	—	—	—	—
	63 B5	20x30x7	25x40x7	30x40x7 (1/5÷1/30) 25x40x7 (1/36÷1/100)	35x47x7	—
	71 B5	—	Not available	Not available	35x47x7	45x62x7
	80÷90 B5	—	—	Not available	35x47x7	45x62x7
	100÷112 B5	—	—	—	—	45x62x7
	132 B5	—	—	—	—	—
NEMA	56 B14	20x30x7	25x40x7	25x40x7 (1/36÷1/100)	—	—
	63 B14	20x30x7	Not available	Not available	—	—
	71 B14	—	25x40x7	30x40x7 (1/5÷1/30) 25x40x7 (1/36÷1/100)	35x47x7	—
	80 B14	—	—	30x40x7 (1/7÷1/30)	35x47x7	45x62x7
	90 B14	—	—	—	35x47x7	45x62x7
	100÷112 B14	—	—	—	—	45x62x7
	132 B14	—	—	—	—	—
	56C	—	25x40x7	25x40x7	35x47x7	45x62x7
143/5TC	—	—	—	35x47x7	45x62x7	
182/4TC	—	—	—	—	45x62x7	

Oil for low temperature and food
Olio per basse temperature e alimenti



CODE **OB150**

Agip Blasias 150
 Oil for low temperature
 Olio per basse temperature

Advised / Suggestito

Low temperature.
 Basse temperature.



CODE **OF320**

Foodlub 320
 Oil for food
 Olio per alimenti

Oil for food.

Olio per alimenti.

Life lubricated bearings
Cuscinetti lubrificati a vita



CODE **MONV5**

	(1pcs)
D30	61904
D45	6005
D50	61906 (1/7÷1/30) 6005 (1/36÷1/100)
D63	6007
D85	6009

Advised / Suggestito

Ideal for V5 vertical position.

Ideale per posizione verticale V5.

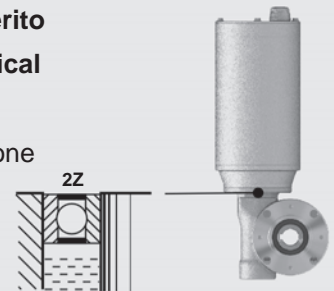

Life lubricated bearings
Cuscinetti lubrificati a vita



CODE **MONV6**

	(1pcs)
D30	6201
D45	6202
D50	6204
D63	6304
D85	6306

Advised / Suggestito

Ideal for V6 vertical position.

Ideale per posizione verticale V6.

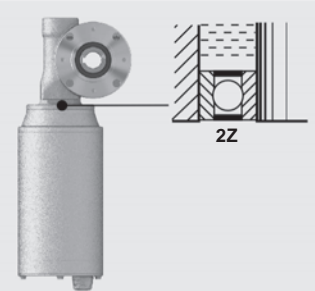

D Series Aluminum worm gearboxes - ACCESSORIES AND OPTIONS

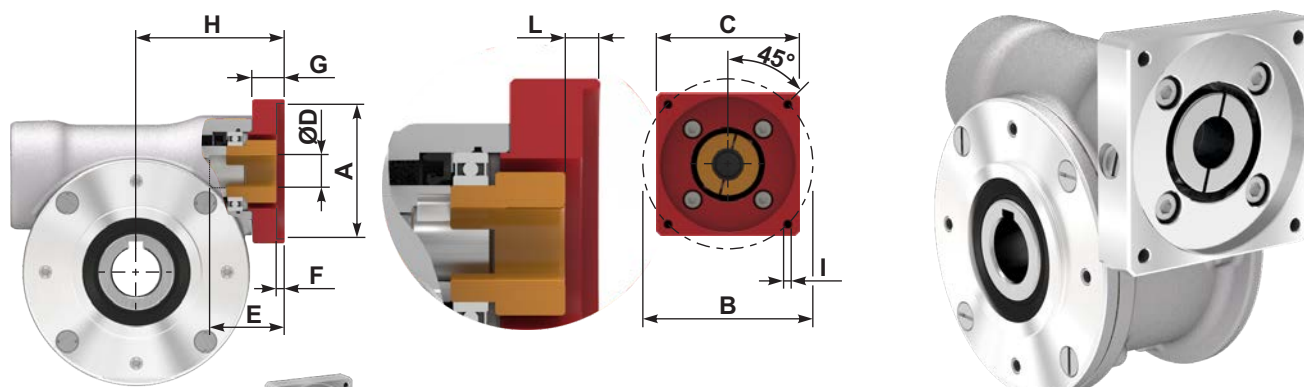

	Catalog Flange Code	Input flanges Kit Code	Bushing Kit Code	Coupling Kit Code	Motor shaft Ø	Dimensions (mm)										
						A	B	C	ØD	E	F	G	L	I	H	
D30 21Nm	BA	K0304071	KBR09/14G	K0305190L	Ø9	40	63	58	Ø14	30	4	20	4.7	M5x12	68	
	BC	K0304072	KBR11/14G	K0305190L	Ø11	60	75	70	Ø14	30	4.5	20	4.7	M5x12	68	
	BB	K0304073	-	K0305190L	Ø14	50	70	60	Ø14	32	4.5	28.5	13.2	M5x12	76.5	
D45 41Nm	BC	KD504072	KBR11/14G	KC355190L	Ø11	60	75	70	Ø14	44	4.5	23	9	M5x12	79	
	BB	KD504073	-	KC355190L	Ø14	50	70	70	Ø14	44	4.5	23	9	M5x12	79	
	BE	KD504074	-	KC355190L	Ø14	80	100	85	Ø14	44	4.5	23	9	M6x12	79	
	BF	KD504075	-	KC355190L	Ø14	95	115	100	Ø14	44	4.5	23	9	M8x12	79	
D50 72Nm	BD	KD504078	-	KC355190L	Ø14	70	90	80	Ø14	44	4.5	23	9	M6x12	79	
	BC	KD504072	KBR11/19G	K0505190L	Ø11	60	75	70	Ø19	48	4.5	23	9	M5x12	83.5	
	BC	KD504072	KBR14/19G	K0505190L	Ø14	60	75	70	Ø19	48	4.5	23	9	M5x12	83.5	
	BB	KD504073	KBR14/19G	K0505190L	Ø14	50	70	70	Ø19	48	4.5	23	9	M5x12	83.5	
	BE	KD504074	KBR14/19G	K0505190L	Ø14	80	100	85	Ø19	48	4.5	23	9	M6x12	83.5	
D63 147Nm	BF	KD504075	-	K0505190L	Ø19	95	115	100	Ø19	48	4.5	23	9	M8x12	83.5	
	BD	KD504078	-	K0505190L	Ø19	70	90	80	Ø19	48	4.5	23	9	M6x12	83.5	
	BC	KD634072	KBR14/22G	KC405190L	Ø14	60	75	90	Ø22	58	4.5	25	9	M5x12	104.5	
	BB	KD634073	KBR14/22G	KC405190L	Ø14	50	70	80	Ø22	58	4.5	25	9	M5x12	104.5	
	BE	KD634074	KBR14/22G	KC405190L	Ø14	80	100	85	Ø22	58	4.5	25	9	M6x12	104.5	
	BF	KD634075	KBR19/22G	KC405190L	Ø19	95	115	100	Ø22	58	4.5	25	9	M8x12	104.5	
D85 347Nm	BG	KD634076	-	KC405190L	Ø22	110	145	130	Ø22	63	8	30	14	M8x14	109.5	
	BD	KD634078	KBR19/22G	KC405190L	Ø19	70	90	90	Ø22	58	4.5	25	9	M6x12	104.5	
	BF	KD854075	KBR19/24G	KC505190L	Ø19	95	115	100	Ø24	60	4.5	26	9.5	M8x14	124.5	
	BG	KD854076	KBR22/24G	KC505190L	Ø22	110	145	130	Ø24	64	8	30	13.5	M8x14	128.5	
	BH	KD854077	-	KC505190L	Ø24	130	165	140	Ø24	60	5	26	9.5	M8x14	124.5	
BD	KD854078	KBR19/24G	KC505190L	Ø19	70	90	95	Ø24	60	4.5	26	9.5	M6x14	124.5		

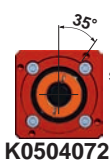

Fixing holes shifted by 35° Fori fissaggio motore ruotati a 35°



Fixing holes shifted by 30° Fori fissaggio motore ruotati a 30°



Fixing holes shifted by 25° Fori fissaggio motore ruotati a 25°

Life lubricated bearings Cuscinetti lubrificati a vita

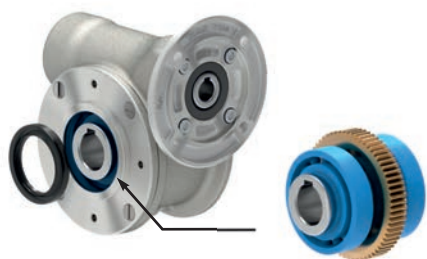

CODE **2CRSU**

	(1pcs)
D45	6006
D50	6008
D63	6009
D85	6011

Advised / Sugerito

Ideal for B6 and B7 position.
Ideale per posizione B6 e B7.

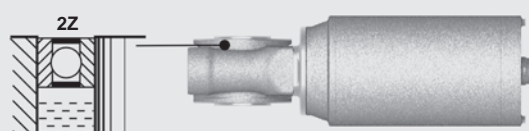

Protective hollow shaft cap

Stainless steel protective hollow shaft cap
Tappo di protezione in acciaio inox



	CODE
D30 D45	KN300209
D50	KN500209
D63	KN630209
D85	KN850209

Advised / Sugerito

Hand protection.
 Protezione delle mani.

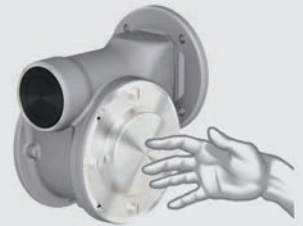

Stainless steel slotted set screws
Grani in acciaio inox



	CODE	
D30 D45 D50	KVTGIM06x06I_4	(4 pcs)
D63	KVTGIM08x08_8	(8 pcs)
D85	KVTGIM10x10I_8	(8 pcs)

Advised / Sugerito

No plastic plugs.
 Nessun tappo di plastica.

Stainless steel fasteners on cover FB
Viti di fissaggio coperchio FB in acciaio inox



	CODE	VCAIX
D30	Not available	
D45	KVTSIM06x18I	(4 pcs)
D50	KVTSIM06x18I	(4 pcs)
D63	Standard	
D85	KVTSIM08x25I	(8 pcs)

Advised / Sugerito

ATEX Reducer category 2
Riduttore ATEX categoria 2



CODE **AX121**

- Use of synthetic oil and with oil plugs (oil plugs when possible).
- VITON oil seals.
- Loctite on all external screws.
- Double input seals, when possible.
- Additional output oil seals when possible.
- Indication of maximum temperature gauge.
- Utilizzo di olio sintetico e con tappi olio (tappi olio dove è possibile).
- Anelli di tenuta in VITON.
- Frena filetti su tutte le viti fissaggio esterne.
- Doppio anello di tenuta in entrata, dove è possibile
- Anelli di tenuta supplementare in uscita dove è possibile.
- Indicatore visivo di temperatura di massima.

Advised / Sugerito



Atex Cat. 2

For more information see our guide «Atex installation and maintenance guide» on our website.

Per ulteriori informazioni, consultare la nostra guida «Atex guida alla manutenzione e installazione» sul nostro sito..

ATEX Reducer category 3
Riduttore ATEX categoria 3

CODE **AX222**

- Use of synthetic oil and with oil plugs (oil plugs when possible).
- Utilizzo di soli olio sintetico e con tappi olio (tappi olio dove è possibile).

Advised / Sugerito



Atex Cat. 3

For more information see our guide «Atex installation and maintenance guide» on our website.

Per ulteriori informazioni, consultare la nostra guida «Atex guida alla manutenzione e installazione» sul nostro sito..

D Series Aluminum worm gearboxes - ACCESSORIES AND OPTIONS

Housing with oil plug
Tappo olio su cassa



CODE **TOSCA**

D30	Not available
D45	Available
D50	Available
D63	Available
D85	Available

Advised / Sugerito

Gasket between gearbox and electric motor
Guarnizione tra riduttore e motore elettrico



CODE

D30	63B14	KGD0500363
	63B14	KGD0500363
D45	63B14	KGD0500363
	71B14	KGD0500371
D50	63B14	KGD0500363
	71B14	KGD0500371
	80B14	KGD0500380
D63	71B14	KGD0500371
	80B14	KGD0500380
	90B14	KGD0500390
D85	80B14	KGD0500380
	90B14	KGD0500390
	100B14	KGD0500310

Advised / Sugerito

Increased security from infiltration.
Maggiore sicurezza da infiltrazione.

NEMA

NEMA input flange
Flangia entrata NEMA



CODE

D45 D50	56C	KUD504041
D63	143/5TC	KUD634041
D85	143/5TC	KUD854041
	182/4TC	KUD854042

Advised / Sugerito

USA , CANADA, MEXICO.

Gasket between gearboxes and Nema motor
Guarnizione tra riduttore e motore Nema



CODE

D45	56C	KGDU0850306
D50	56C	KGDU0850306
D63	56C	KGDU0850306
	143/5TC	KGDU0850306
D85	143/5TC	KGDU0850306
	182/4TC	KGDU0850307

Advised / Sugerito

Protection from possible infiltration
Protezione da possibili infiltrazioni