

Input speed ( $n_1$ ) = 1400 min<sup>-1</sup>

Output speed $n_2$ [min <sup>-1</sup> ]	Ratio $i$	Motor power $P_{1M}$ [kW]	Output torque $M_{2M}$ [Nm]	Service factor f.s	Nominal power $P_{1R}$ [kW]	Nominal torque $M_{2R}$ [Nm]	B5 motor flanges		B14 motor flanges		Dynamic efficiency RD	Tooth module [mm]	Ratio code
							-A	-B	-O	-P			
9.3	<b>150</b>	0.06	29	1.2	<b>0.07</b>	<b>35</b>	<b>B</b>		<b>B-C</b>		48	1.44	01
6.7	<b>210</b>	0.06	39	0.9	<b>0.05</b>	<b>35</b>	<b>B</b>		<b>B-C</b>		45	1.44	02
4.7	<b>300</b>	0.06*	35	<0.8	<b>0.05</b>	<b>35</b>	<b>B</b>		<b>B-C</b>		36	1.44	03
3.1	<b>450</b>	0.06*	35	<0.8	<b>0.03</b>	<b>35</b>	<b>B</b>		<b>B-C</b>		33	1.44	04
2.3	<b>600</b>	0.06*	35	<0.8	<b>0.03</b>	<b>35</b>	<b>B</b>		<b>B-C</b>		30	1.44	05
1.6	<b>900</b>	0.06*	35	<0.8	<b>0.02</b>	<b>35</b>	<b>B</b>		<b>B-C</b>		27	1.44	06
1.2	<b>1200</b>	0.06*	35	<0.8	<b>0.02</b>	<b>35</b>	<b>B</b>		<b>B-C</b>		26	1.44	07
0.8	<b>1830</b>	0.06*	35	<0.8	<b>0.01</b>	<b>35</b>	<b>B</b>		<b>B-C</b>		24	1.44	08
0.6	<b>2400</b>	0.06*	35	<0.8	<b>0.01</b>	<b>35</b>	<b>B</b>		<b>B-C</b>		22	1.44	09

\* Power higher than the maximum one which can be supported by the gearbox. Select according to the torque  $M_{2R}$

Potenza superiore a quella massima sopportabile dal riduttore. Selezionare in base al momento torcente  $M_{2R}$

Motor flanges available  
Flange motore disponibili



B) Supplied with reduction bushing  
Fornito con bussola di riduzione



B) Available on request without reduction bushing  
Disponibile a richiesta senza bussola di riduzione



C) Motor flange holes position  
Posizione fori flangia motore

## Lubrication

Lubrificazione

Unit 3D3 is supplied with synthetic oil to assure long life lubrication. Food grade oil is available on request. See Table 1 for lubrication and recommended quantity. See Table 2 for possible radial and axial loads on the gearbox.

Il riduttore tipo 3D3 viene fornito con olio sintetico e lubrificazione tipo "long life". Disponibile a richiesta olio alimentare. Vedi Tabella 1 per oli e quantità consigliati. Vedi Tabella 2 per i carichi radiali e assiali applicabili al riduttore.

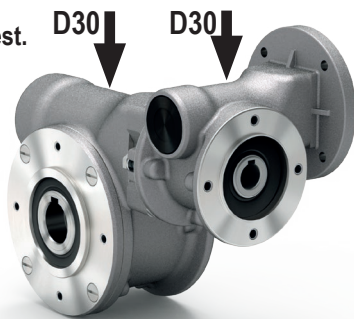

D30: 0.03 L

Shell

Omala S4 WE 320

Eni

Telium VSF 320

For all details on lubrication and plugs check our website.  
Per maggiori dettagli su lubrificazione e tappi olio vedi il nostro sito web.

Tab. 1

## Suggested

Suggerito

Stainless steel protection cap (on request).

Coperchio di protezione in acciaio inox a richiesta.

Kit cod. KN300209

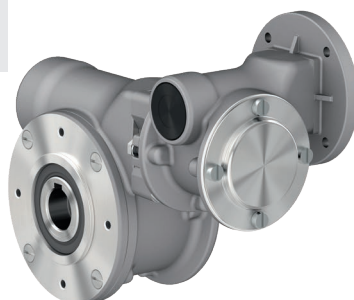

## Radial and axial loads

Carichi radiali e assiali

### Output shaft

Albero di uscita

$n_2$ [min <sup>-1</sup> ]	$F_A$ [N]	$F_R$ [N]
25	300	1800
15	400	2000

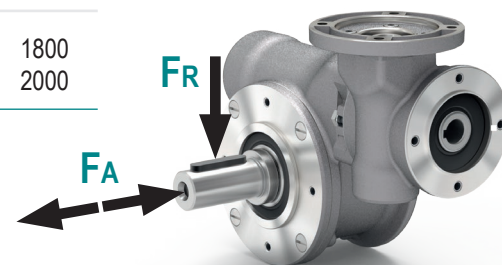

### Input shaft

Albero in entrata

$n_1$ [min <sup>-1</sup> ]	$F_A$ [N]	$F_R$ [N]
1400	20	100

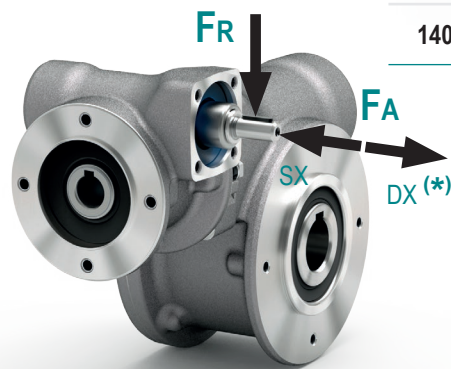

\* Strong axial loads in the DX direction are not allowed.

\* Non sono consentiti forti carichi assiali con direzione DX

Tab. 2

**P3D3UNI.. Basic gearbox**  
*Riduttore base*

M. flanges	Kit code	øF	A
56B5	KD304041	120	62
63B5	KD304042	140	63
56B14	KD304046	80	62
63B14	KD304045	90	63

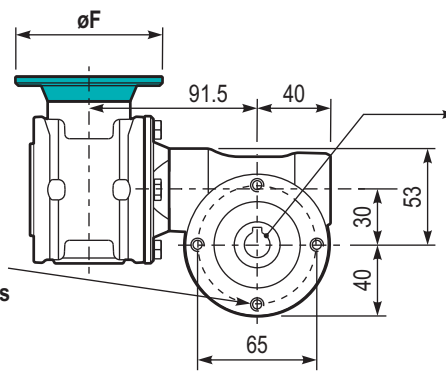
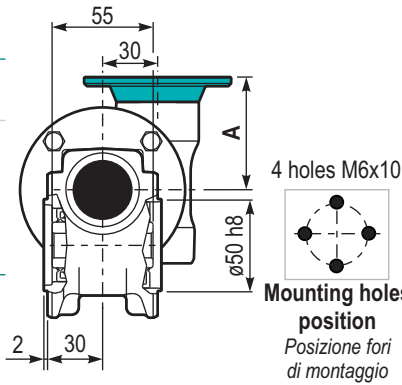

**Gearbox weight**  
*Peso riduttore* **2.15 kg**

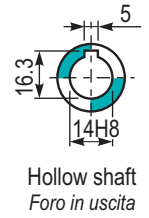

**P3D3PA... Feet**  
*Piedini*

Type	T	Kit code
B**	87	K0309022
I*	80	KN309022

\*\* Zink plated  
\* Stainless steel

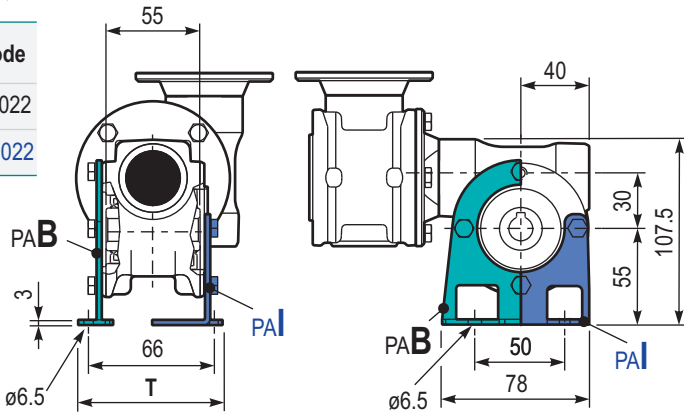

**P3D3PBB... Feet**  
*Piedini*

**P3D3PV... Feet**  
*Piedini*

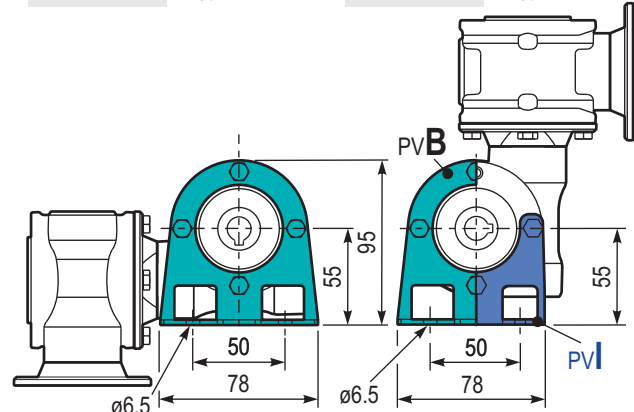

**P3D3FL... Output flange**  
*Flangia uscita*

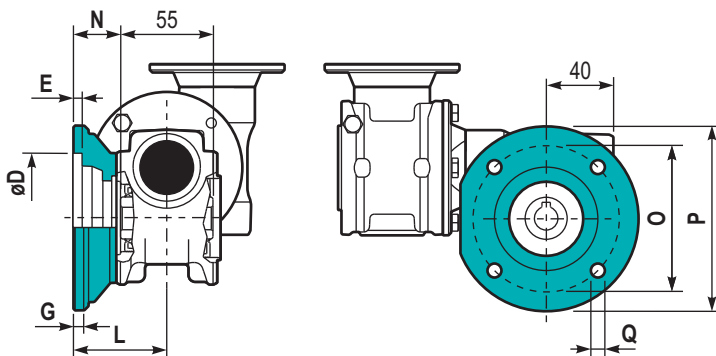

**P3D3BR... Reaction arm**  
*Braccio di reazione*

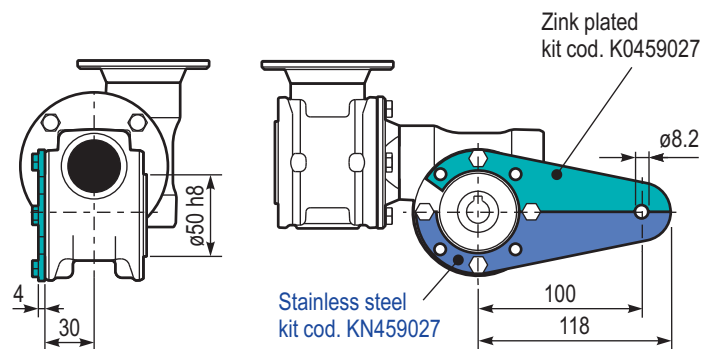

Type	øD	E	G	L	N	O	P	Q	Kit code
C	50 <sup>+0.15</sup> / <sub>+0.05</sub>	6	6	50.5	23	68	80	7	K0309010
L	60 <sup>+0.15</sup> / <sub>+0.05</sub>	6	6	55.5	28	87	110	8.5	K0459010

**R3D3UNI.. Input shaft**  
*Albero in entrata*

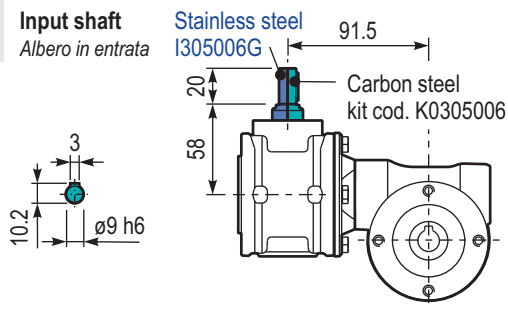

**P3D3..SMA Single output shaft**  
*Albero semplice in uscita*

kit cod. KN300209  
**Protection cap (on request)**  
*A richiesta coperchio di protezione*

