

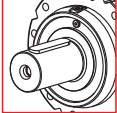

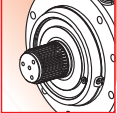



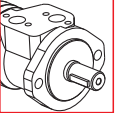
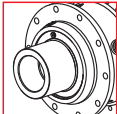
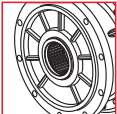
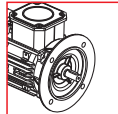
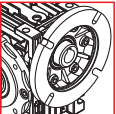

TEKNİK VERİLER / TECHNICAL DATA / TECHNISCHE DATEN / DATI TECNICI / DONNÉES TECHNIQUES / DATOS TÉCNICAS

	$i_{ges}$	$M_{2max}$ (n1: 1400rpm) (Nm)	OUTPUT		INPUT	
<b>10001</b>	3.56 ... 8.67	5040	 Ø90	 80x74 DIN 5482	 Ø28 - Ø42 Ø1"3/8 - Ø65	 Hydraulic Motor
<b>10002</b>	13.4 ... 48.9	6790	 Ø100	 80x74 DIN 5482	 Electric Motor	 Worm gearboxes
<b>10003</b>	57.6 ... 330.3	8780				
<b>10004</b>	352.0 ... 2229.7	12140			 Brake	

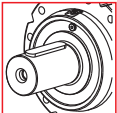
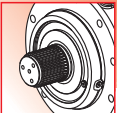
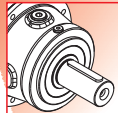
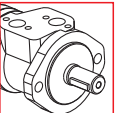
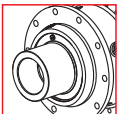
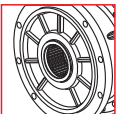
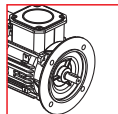
	$i_{ges}$	$M_{2max}$ (n1: 1400rpm) (Nm)	OUTPUT		INPUT	
<b>10002</b>	12.3 ... 36.7	6290	 Ø90	 80x74 DIN 5482	 Ø28 - Ø42 Ø1"3/8 - Ø65	 Hydraulic Motor
<b>10003</b>	46.4 ... 266.4	8590	 Ø100	 80x74 DIN 5482	 Electric Motor	
<b>10004</b>	140.1 ... 969.0	10710			 Brake	

	Pt [kW]	n <sub>1max</sub> [min <sup>-1</sup> ]	i <sub>ges</sub>	Mc [kNm]				Giriş- Input - Antrieb - Entrada - Entrée - Entrada		
				n <sub>2</sub> x h	n <sub>2</sub> x h	n <sub>2</sub> x h	n <sub>2</sub> x h			
				10.000	20.000	50.000	100.000	IEC (B5)	PMRV / PRV	EL - EML EM - EP - ET
PL 10001	40	2000	3.56	14.08	12.45	10.60	9.38	160 180 200 225	110 130	EM 65 EM 1"3/8 Z6 EP 65
			4.29	12.10	10.71	9.12	8.07			
			5.60	9.40	8.32	7.08	6.27			
			6.75	7.18	6.35	5.41	4.78			
			8.67	5.08	4.50	3.83	3.39			
PL 10002	23	2800	13.4	14.08	12.45	10.60	9.38	63   112 71   132 80   160 90   180 100	050 063 075 090 110 130	EL C 28 EL C 42 EML 42 EML 1"3/8 Z6 EM 65 EM 1"3/8 Z6 EP 65
			16.2	12.10	10.71	9.12	8.07			
			18.4	14.08	12.45	10.60	9.38			
			22.1	12.10	10.71	9.12	8.07			
			25.7	12.10	10.71	9.12	8.07			
			28.9	9.40	8.32	7.08	6.27			
			33.6	9.40	8.32	7.08	6.27			
			40.5	7.18	6.35	5.41	4.78			
			48.9	7.18	6.35	5.41	4.78			
			PL 10003	15	2800	57.6	14.08			
62.9	14.08	12.45				10.60	9.38			
75.2	14.08	12.45				10.60	9.38			
82.1	14.08	12.45				10.60	9.38			
94.9	12.10	10.71				9.12	8.07			
109.3	12.10	10.71				9.12	8.07			
118.5	9.40	8.32				7.08	6.27			
124.0	12.10	10.71				9.12	8.07			
129.4	9.40	8.32				7.08	6.27			
144.0	12.10	10.71				9.12	8.07			
155.9	9.40	8.32				7.08	6.27			
173.6	12.10	10.71				9.12	8.07			
188.2	9.40	8.32				7.08	6.27			
195.3	9.40	8.32				7.08	6.27			
209.7	7.18	6.35				5.41	4.78			
226.8	9.40	8.32				7.08	6.27			
235.4	7.18	6.35				5.41	4.78			
274.1	9.40	8.32	7.08	6.27						
330.3	7.18	6.35	5.41	4.78						
PL 10004	11	2800	352.0	14.08	12.45	10.60	9.38	63 71 80 90 100 112 132 160	050 063 075 090	EL C 28 EL C 42 EML 42 EML 1"3/8 Z6
			388.6	14.08	12.45	10.60	9.38			
			421.2	14.08	12.45	10.60	9.38			
			440.9	12.10	10.71	9.12	8.07			
			459.9	14.08	12.45	10.60	9.38			
			507.7	14.08	12.45	10.60	9.38			
			531.4	12.10	10.71	9.12	8.07			
			554.4	14.08	12.45	10.60	9.38			
			576.1	9.40	8.32	7.08	6.27			
			612.0	12.10	10.71	9.12	8.07			
			640.5	12.10	10.71	9.12	8.07			
			724.4	9.40	8.32	7.08	6.27			
			806.4	9.40	8.32	7.08	6.27			
			907.3	9.40	8.32	7.08	6.27			
			1008.9	12.10	10.71	9.12	8.07			
			1093.7	9.40	8.32	7.08	6.27			
			1270.1	9.40	8.32	7.08	6.27			
1530.9	9.40	8.32	7.08	6.27						
1849.8	9.40	8.32	7.08	6.27						
2229.7	7.18	6.35	5.41	4.78						

	Pt [kW]	n <sub>1max</sub> [min <sup>-1</sup> ]	i <sub>ges</sub>	Mc [kNm]				Giriş- Input - Antrieb - Entrada - Entrée - Entrada	
				n <sub>2</sub> x h	n <sub>2</sub> x h	n <sub>2</sub> x h	n <sub>2</sub> x h		
				10.000	20.000	50.000	100.000	IEC (B5)	EL - EML EM - EP - ET
<b>PLB 10002</b>	23	2800	12.3	14.08	12.45	10.60	9.38	80 90 100 112 132 160 180	EL C 28 EL C 42 EML 42 EML 1"3/8 Z6 EM 65 EM 1"3/8 Z6 EP 65
			14.8	12.10	10.71	9.12	8.07		
			19.3	9.40	8.32	7.08	6.27		
			23.3	7.18	6.35	5.41	4.78		
			30.5	9.40	8.32	7.08	6.27		
			36.7	7.18	6.35	5.41	4.78		
<b>PLB 10003</b>	15	2800	46.4	14.08	12.45	10.60	9.38	80 90 100 112 132 160	EL C 28 EL C 42 EML 42 EML 1"3/8 Z6 EM 65 EM 1"3/8 Z6 EP 65
			50.7	14.08	12.45	10.60	9.38		
			61.1	12.10	10.71	9.12	8.07		
			73.1	14.08	12.45	10.60	9.38		
			88.8	12.10	10.71	9.12	8.07		
			96.2	12.10	10.71	9.12	8.07		
			116.1	9.40	8.32	7.08	6.27		
			120.6	12.10	10.71	9.12	8.07		
			125.8	9.40	8.32	7.08	6.27		
			140.0	12.10	10.71	9.12	8.07		
			157.5	9.40	8.32	7.08	6.27		
			182.9	9.40	8.32	7.08	6.27		
			221.0	9.40	8.32	7.08	6.27		
			266.4	7.18	6.35	5.41	4.78		
<b>PLB 10004</b>	11	2800	140.1	14.08	12.45	10.60	9.38	80 90 100 112 132 160	EL C 28 EL C 42 EML 42 EML 1"3/8 Z6 EM 65 EM 1"3/8 Z6 EP 65
			168.9	14.08	12.45	10.60	9.38		
			184.4	12.10	10.71	9.12	8.07		
			203.5	12.10	10.71	9.12	8.07		
			230.9	14.08	12.45	10.60	9.38		
			265.9	12.10	10.71	9.12	8.07		
			278.4	12.10	10.71	9.12	8.07		
			301.8	14.08	12.45	10.60	9.38		
			320.6	12.10	10.71	9.12	8.07		
			350.0	12.10	10.71	9.12	8.07		
			379.5	9.40	8.32	7.08	6.27		
			418.9	9.40	8.32	7.08	6.27		
			457.4	9.40	8.32	7.08	6.27		
			510.4	9.40	8.32	7.08	6.27		
			551.9	9.40	8.32	7.08	6.27		
			665.3	9.40	8.32	7.08	6.27		
			803.9	9.40	8.32	7.08	6.27		
969.0	7.18	6.35	5.41	4.78					



$$M_{\max} = M_c \times 2$$

(n<sub>2</sub> x h = 20.000)

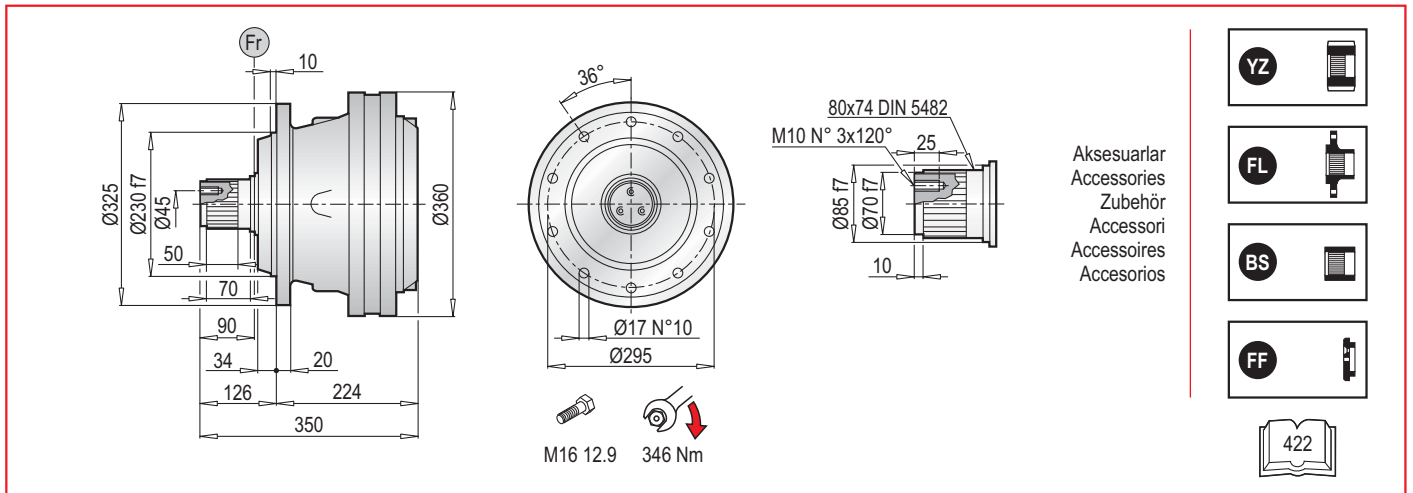

**PL 10000 MS - Elektrik Motor Adaptörleri (IEC) / Electric Motor Couplings (IEC) / Anbauvorrichtung Für Elektromotore (IEC) / Predisposizioni Per Motori Elettrici (IEC) / Adaptations Pour Moteurs Electriques (IEC) / Acoplamientos Para Motores Eléctricos (IEC)**

PL	IEC 63			IEC 71			IEC 80			IEC 90			IEC 100			IEC 112			
	L <sub>T</sub>	Z	ØD	L <sub>T</sub>	Z	ØD	L <sub>T</sub>	Z	ØD	L <sub>T</sub>	Z	ØD	L <sub>T</sub>	Z	ØD	L <sub>T</sub>	Z	ØD	
10001	-	-	-	-	-	-	-	-	-	-	-	-	-	-	-	-	-	-	-
10002	331.5	-	-	331.5	-	-	351.5	-	-	351.5	-	-	361.5	-	-	361.5	-	-	361.5
10003	392.5	36	140	392.5	36	160	412.5	56	200	412.5	56	200	422.5	66	250	422.5	66	250	422.5
10004	440.5	-	-	440.5	-	-	460.5	-	-	460.5	-	-	470.5	-	-	470.5	-	-	470.5

PL	IEC 132			IEC 160			IEC 180			IEC 200			IEC 225		
	L <sub>T</sub>	Z	ØD	L <sub>T</sub>	Z	ØD	L <sub>T</sub>	Z	ØD	L <sub>T</sub>	Z	ØD	L <sub>T</sub>	Z	ØD
10001	-	-	-	342	118	350	342	118	350	372	148	400	372	148	450
10002	395.5	-	-	434.5	-	-	434.5	139	350	-	-	-	-	-	-
10003	456.5	100	300	495.5	139	350	-	-	-	-	-	-	-	-	
10004	504.5	-	-	543.5	-	-	-	-	-	-	-	-	-	-	

PL	IEC ~ Kg										
	63	71	80	90	100	112	132	160	180	200	225
10001	-	-	-	-	-	-	-	120	120	130	135
10002	120	120	122	122	123	123	127	137	137	-	-
10003	128	128	140	140	141	141	145	155	-	-	-
10004	134	134	146	146	147	147	151	161	-	-	-

**PL 10000 MS - Giriş Milleri / Input Shafts / Antriebswellen / Alberi Entrata / Arbres D'entree / Ejes De Entrada**

PL	EL C 28				EL C 42				EML 42				EML 1"3/8 Z6				EM 65				EM 1"3/8 Z6			
	L <sub>T</sub>	Z	L	Ød	L <sub>T</sub>	Z	L	Ød	L <sub>T</sub>	Z	L	Ød	L <sub>T</sub>	Z	L	Ød	L <sub>T</sub>	Z	L	Ød	L <sub>T</sub>	Z	L	Ød
10001	-	-	-	-	-	-	-	-	-	-	-	-	-	-	-	-	345.5	121.5	105	65	345.5	121.5	105	1"3/8
10002	359.5	-	-	-	359.5	-	-	-	389.5	-	-	-	389.5	-	-	-	430.5	-	-	-	430.5	-	-	-
10003	420.5	64	50	28	420.5	64	82	42	450.5	94	82	42	450.5	94	106	1"3/8	-	-	-	-	-	-	-	-
10004	468.5	-	-	-	468.5	-	-	-	498.5	-	-	-	498.5	-	-	-	-	-	-	-	-	-	-	-

PL	EP 65				PL	~ Kg							
	L <sub>T</sub>	Z	L	Ød		EL C 28	EL C 42	EML 42	EML 1"3/8 Z6	EM 65	EM 1"3/8 Z6	EP 65	
10001	377	153	105	65	10001	-	-	-	-	115	115	124	
10002	462	-	-	-	10002	120.5	121	124	124	132	132	141	
10003	-	-	-	-	10003	128.5	129	132	132	-	-	-	
10004	-	-	-	-	10004	134.5	135	138	138	-	-	-	

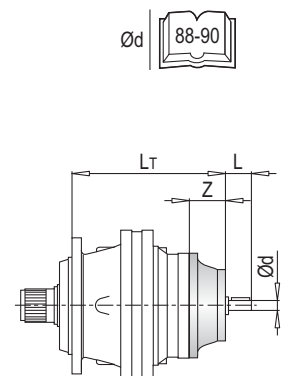
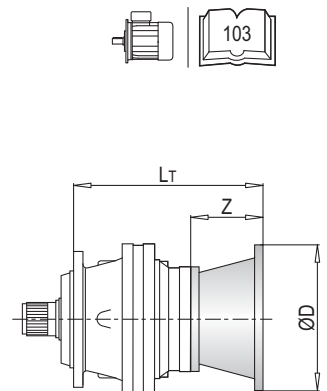

**PL 1000 MS** - Sonsuz Dişli Redüktör Adaptörleri (PMRV/PRV) / Worm Gearbox Adaptors (PMRV/PRV) / Anschluss Für Schneckengetriebe (PMRV/PRV) / Predisposizioni Per Riduttori A Vite Senza Fine (PMRV/PRV) / Adaptation Pour Reducteurs A Vis Sans Fin (PMRV/PRV) / Acoplamiento Para Reductores De Tornillo Sin Fin (PMRV/PRV)

PL	PMRV/PRV 050					PMRV/PRV 063					PMRV/PRV 075				
	Lm	l	h	MA	G	Lm	l	h	MA	G	Lm	l	h	MA	G
10001	-					-					-				
10002	421					430.5					409.5				
10003	482	50	110	60	80	491.5	63	135	72	95	470.5	75	161	86	112.5
10004	530					539.5					518.5				

PL	PMRV/PRV 090					PMRV/PRV 110					PMRV/PRV 130					
	Lm	l	h	MA	G	Lm	l	h	MA	G	Lm	l	h	MA	G	
10001	-					362					369.5					180
10002	419.5					447	110	237.5	127.5	160	454.5	130	277.5	147.5	180	
10003	480.5	90	193	103	129.5	-					-					
10004	528.5					-					-					

PL	PMRV/PRV ~ Kg					
	050	063	075	090	110	130
10001	-	-	-	-	144	161
10002	123	126.5	129	134	161	178
10003	131	134.5	137	142	-	-
10004	137	140.5	143	148	-	-

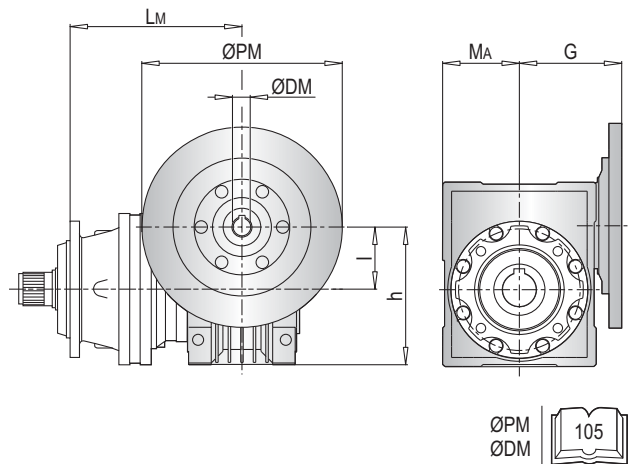

ØPM  
ØDM

**PLB 1000 MS** - Elektrik Motor Adaptörleri (IEC) / Electric Motor Couplings (IEC) / Anbauvorrichtung Für Elektromotore (IEC) / Predisposizioni Per Motori Elettrici (IEC) / Adaptations Pour Moteurs Electriques (IEC) / Acoplamientos Para Motores Eléctricos (IEC)

PLB	IEC 80				IEC 90				IEC 100				IEC 112				IEC 132				
	A	Lt	Z	ØD	A	Lt	Z	ØD	A	Lt	Z	ØD	A	Lt	Z	ØD	A	Lt	Z	ØD	
10002	312				312				312				312				312				
10003	397	296	56	200	397	296	56	200	397	306	66	250	397	306	66	250	397	340	100	300	
10004	431.5	216			431.5	216			431.5	226			431.5	226			431.5	260			

PLB	IEC 160				IEC 180			
	A	Lt	Z	ØD	A	Lt	Z	ØD
10002	312				312	379	139	350
10003	397	379	139	350	-			
10004	431.5	299			-			

PLB	IEC ~ Kg							
	80	90	100	112	132	160	180	
10002	122	122	123	123	127	137	137	
10003	130	130	131	131	135	145	-	
10004	136	136	137	137	141	151	-	

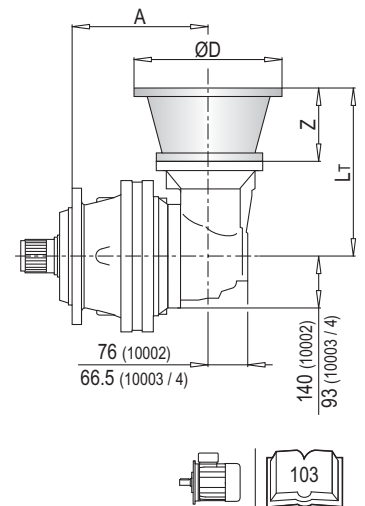

76 (10002)  
66.5 (10003 / 4)  
140 (10002)  
93 (10003 / 4)

**PLB 1000 MS** - Giriş Milleri / Input Shafts / Antriebswellen / Alberi Entrada / Arbres D'entree / Ejes De Entrada

PLB	EL C 28					EL C 42					EML 42					EML 1"3/8 Z6					EM 65					
	A	Lt	Z	L	Ød	A	Lt	Z	L	Ød	A	Lt	Z	L	Ød	A	Lt	Z	L	Ød	A	Lt	Z	L	Ød	
10002	312					312					312					312					312					
10003	397	304	64	50	28	397	304	64	82	42	397	334	94	82	42	397	334	94	106	1"3/8	397	377.5	121.5	105	65	
10004	431.5	224				431.5	224				431.5	254				431.5	254				431.5	297.5				

PLB	EM 1"3/8 Z6					EP 65				
	A	Lt	Z	L	Ød	A	Lt	Z	L	Ød
10002	312					312	409	153	105	65
10003	397	377.5	121.5	105	1"3/8	397	409	153	105	65
10004	431.5	297.5				431.5	329			

PLB	~ Kg							
	EL C 28	EL C 42	EML 42	EML 1"3/8 Z6	EM 65	EM 1"3/8 Z6	EP 65	
10002	120.5	121.0	124.0	124.0	132.0	132.0	141.0	
10003	128.5	129.0	132.0	132.0	140.0	140.0	149.0	
10004	134.5	135.0	138.0	138.0	146.0	146.0	155.0	

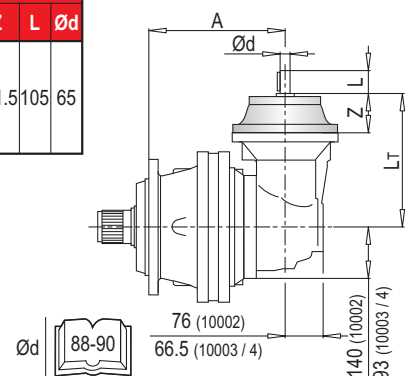

Ød  
88-90

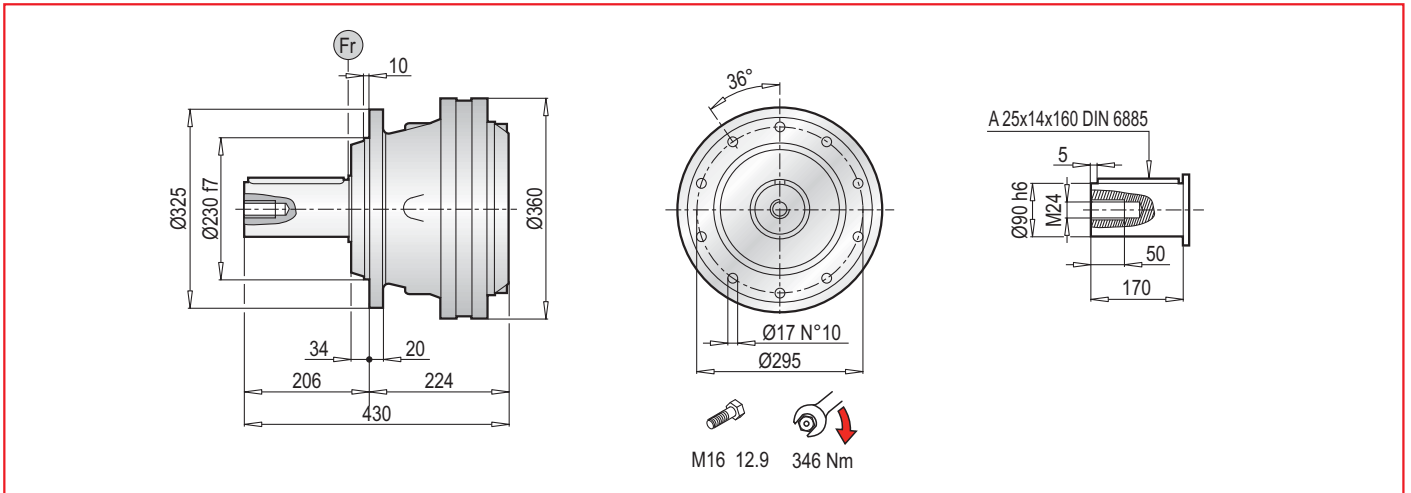

**PL 10000 MC** - Elektrik Motor Adaptörleri (IEC) / Electric Motor Couplings (IEC) / Anbauvorrichtung Für Elektromotore (IEC) / Predisposizioni Per Motori Elettrici (IEC) / Adaptations Pour Moteurs Electriques (IEC) / Acoplamientos Para Motores Eléctricos (IEC)

PL	IEC 63			IEC 71			IEC 80			IEC 90			IEC 100			IEC 112		
	L <sub>T</sub>	Z	ØD	L <sub>T</sub>	Z	ØD	L <sub>T</sub>	Z	ØD	L <sub>T</sub>	Z	ØD	L <sub>T</sub>	Z	ØD	L <sub>T</sub>	Z	ØD
10001	-	-	-	-	-	-	-	-	-	-	-	-	-	-	-	-	-	-
10002	331.5	-	-	331.5	-	-	351.5	-	-	351.5	-	-	361.5	-	-	361.5	-	-
10003	392.5	36	140	392.5	36	160	412.5	56	200	412.5	56	200	422.5	66	250	422.5	66	250
10004	440.5	-	-	440.5	-	-	460.5	-	-	460.5	-	-	470.5	-	-	470.5	-	-

PL	IEC 132			IEC 160			IEC 180			IEC 200			IEC 225		
	L <sub>T</sub>	Z	ØD	L <sub>T</sub>	Z	ØD	L <sub>T</sub>	Z	ØD	L <sub>T</sub>	Z	ØD	L <sub>T</sub>	Z	ØD
10001	-	-	-	342	118	350	342	118	350	372	148	400	372	148	450
10002	395.5	-	-	434.5	-	-	434.5	139	350	-	-	-	-	-	-
10003	456.5	100	300	495.5	139	350	-	-	-	-	-	-	-	-	-
10004	504.5	-	-	543.5	-	-	-	-	-	-	-	-	-	-	-

PL	IEC ~ Kg										
	63	71	80	90	100	112	132	160	180	200	225
10001	-	-	-	-	-	-	-	120	120	130	135
10002	120	120	122	122	123	123	127	137	137	-	-
10003	128	128	140	140	141	141	145	155	-	-	-
10004	134	134	146	146	147	147	151	161	-	-	-

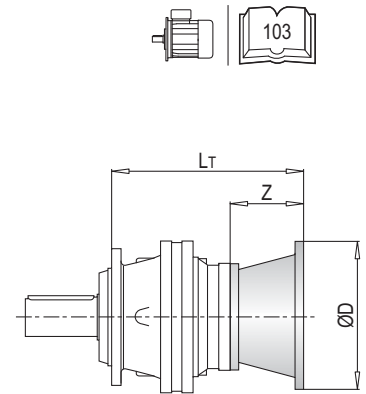

**PL 10000 MC** - Giriş Milleri / Input Shafts / Antriebswellen / Alberi Entrata / Arbres D'entree / Ejes De Entrada

PL	EL C 28				EL C 42				EML 42				EML 1"3/8 Z6				EM 65				EM 1"3/8 Z6			
	L <sub>T</sub>	Z	L	Ød	L <sub>T</sub>	Z	L	Ød	L <sub>T</sub>	Z	L	Ød	L <sub>T</sub>	Z	L	Ød	L <sub>T</sub>	Z	L	Ød	L <sub>T</sub>	Z	L	Ød
10001	-	-	-	-	-	-	-	-	-	-	-	-	-	-	-	-	345.5	121.5	105	65	345.5	121.5	105	1"3/8
10002	359.5	-	-	-	359.5	-	-	-	389.5	-	-	-	389.5	-	-	-	430.5	-	-	-	430.5	-	-	-
10003	420.5	64	50	28	420.5	64	82	42	450.5	94	82	42	450.5	94	106	1"3/8	-	-	-	-	-	-	-	-
10004	468.5	-	-	-	468.5	-	-	-	498.5	-	-	-	498.5	-	-	-	-	-	-	-	-	-	-	-

PL	EP 65				PL	~ Kg						
	L <sub>T</sub>	Z	L	Ød		EL C 28	EL C 42	EML 42	EML 1"3/8 Z6	EM 65	EM 1"3/8 Z6	EP 65
10001	377	153	105	65	10001	-	-	-	-	115.0	115.0	124.0
10002	462	-	-	-	10002	120.5	121.0	124.0	124.0	132.0	132.0	141.0
10003	-	-	-	-	10003	128.5	129.0	132.0	132.0	-	-	-
10004	-	-	-	-	10004	134.5	135.0	138.0	138.0	-	-	-

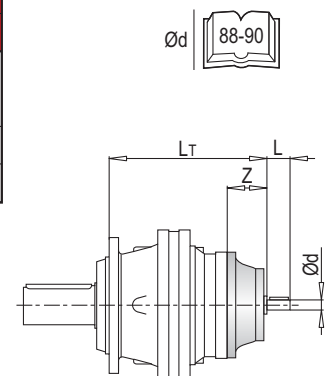

**PL 10000 MC** - Sonsuz Dişli Redüktör Adaptörleri (PMRV/PRV) / Worm Gearbox Adaptors (PMRV/PRV) / Anschluss Für Schneckengetriebe (PMRV/PRV) / Predisposizioni Per Riduttori A Vite Senza Fine (PMRV/PRV) / Adaptation Pour Reducteurs A Vis Sans Fin (PMRV/PRV) / Acoplamiento Para Reductores De Tornillo Sin Fin (PMRV/PRV)

PL	PMRV/PRV 050					PMRV/PRV 063					PMRV/PRV 075				
	Lm	l	h	MA	G	Lm	l	h	MA	G	Lm	l	h	MA	G
10001	-					-					-				
10002	421					430.5					409.5				
10003	482	50	110	60	80	491.5	63	135	72	95	470.5	75	161	86	112.5
10004	530					539.5					518.5				

PL	PMRV/PRV 090					PMRV/PRV 110					PMRV/PRV 130				
	Lm	l	h	MA	G	Lm	l	h	MA	G	Lm	l	h	MA	G
10001	-					362					369.5	130	277.5	147.5	180
10002	419.5					447	110	237.5	127.5	160	454.5				
10003	480.5	90	193	103	129.5	-					-				
10004	528.5					-					-				

PL	PMRV/PRV ~ Kg					
	050	063	075	090	110	130
10001	-	-	-	-	144	161
10002	123	126.5	129	134	161	178
10003	131	134.5	137	142	-	-
10004	137	140.5	143	148	-	-

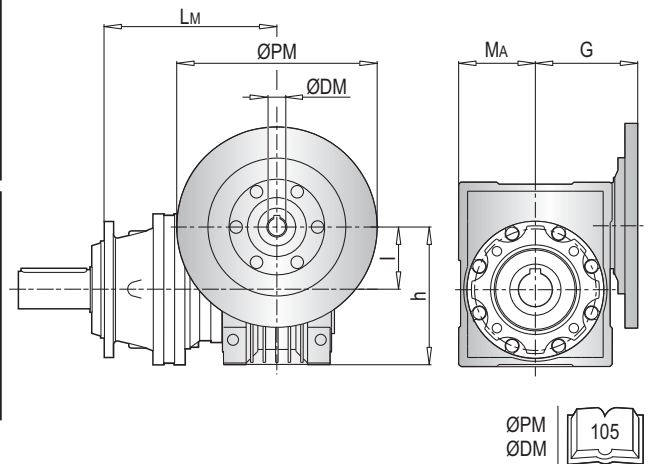

**PLB 10000 MC** - Elektrik Motor Adaptörleri (IEC) / Electric Motor Couplings (IEC) / Anbauvorrichtung Für Elektromotore (IEC) / Predisposizioni Per Motori Elettrici (IEC) / Adaptations Pour Moteurs Electriques (IEC) / Acoplamientos Para Motores Eléctricos (IEC)

PLB	IEC 80				IEC 90				IEC 100				IEC 112				IEC 132			
	A	Lt	Z	ØD	A	Lt	Z	ØD	A	Lt	Z	ØD	A	Lt	Z	ØD	A	Lt	Z	ØD
10002	312				312				312				312				312			
10003	397	296	56	200	397	296	56	200	397	306	66	250	397	306	66	250	397	340	100	300
10004	431.5	216			431.5	216			431.5	226			431.5	226			431.5	260		

PLB	IEC 160				IEC 180			
	A	Lt	Z	ØD	A	Lt	Z	ØD
10002	312				312	379	139	350
10003	397	379	139	350	-			
10004	431.5	299			-			

PLB	IEC ~ Kg							
	80	90	100	112	132	160	180	
10002	122	122	123	123	127	137	137	
10003	130	130	131	131	135	145	-	
10004	136	136	137	137	141	151	-	

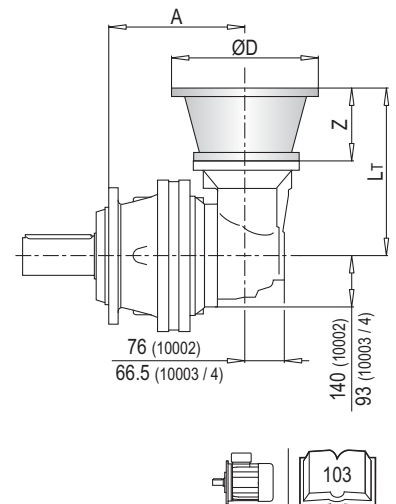

**PLB 10000 MC** - Giriş Milleri / Input Shafts / Antriebswellen / Alberi Entrada / Arbres D'entree / Ejes De Entrada

PLB	EL C 28					EL C 42					EML 42					EML 1"3/8 Z6					EM 65				
	A	Lt	Z	L	Ød	A	Lt	Z	L	Ød	A	Lt	Z	L	Ød	A	Lt	Z	L	Ød	A	Lt	Z	L	Ød
10002	312					312					312					312					312				
10003	397	304	64	50	28	397	304	64	82	42	397	334	94	82	42	397	334	94	106	1"3/8	397	377.5	121.5	105	65
10004	431.5	224				431.5	224				431.5	254				431.5	254				431.5	297.5			

PLB	EM 1"3/8 Z6					EP 65					PLB	~ Kg							
	A	Lt	Z	L	Ød	A	Lt	Z	L	Ød		EL C 28	EL C 42	EML 42	EML 1"3/8 Z6	EM 65	EM 1"3/8 Z6	EP 65	
10002	312					312	409	153	105	65	10002	120.5	121.0	124.0	124.0	132.0	132.0	141.0	
10003	397	377.5	121.5	105	1"3/8	397	409	153	105	65	10003	128.5	129.0	132.0	132.0	140.0	140.0	149.0	
10004	431.5	297.5				431.5	329				10004	134.5	135.0	138.0	138.0	146.0	146.0	155.0	

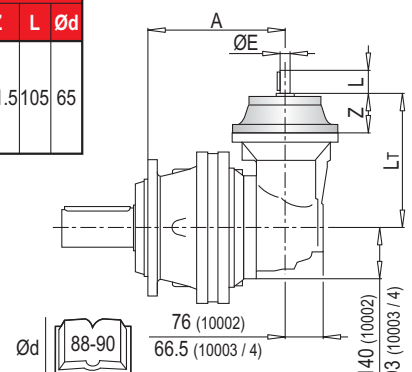

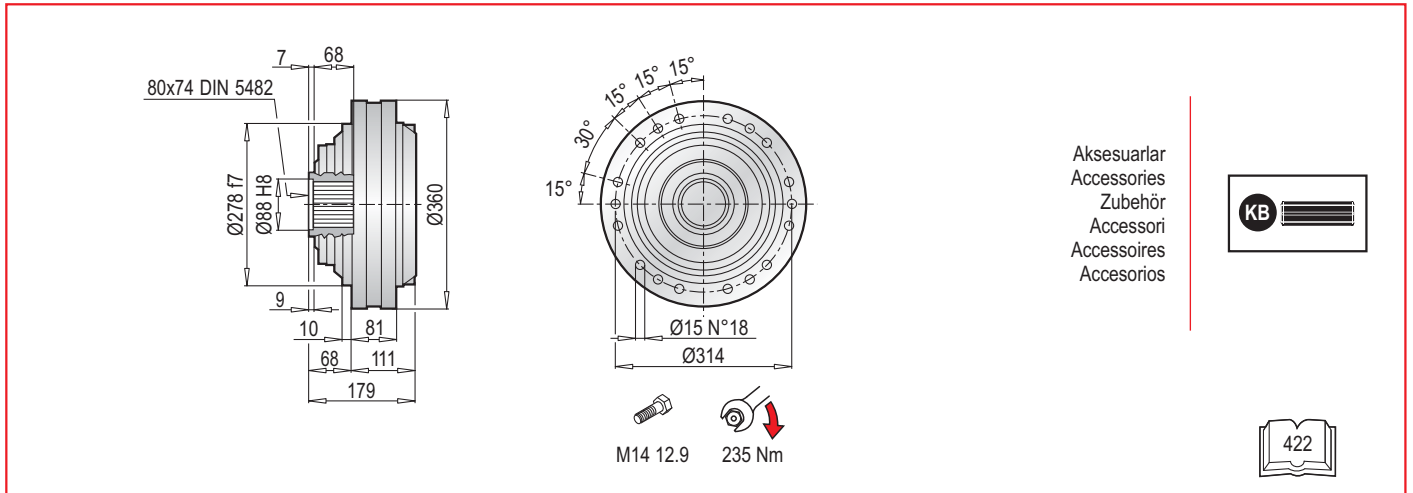

**PL 10000 F - Elektrik Motor Adaptörleri (IEC) / Electric Motor Couplings (IEC) / Anbauvorrichtung Für Elektromotore (IEC) / Predisposizioni Per Motori Elettrici (IEC) / Adaptations Pour Moteurs Electriques (IEC) / Acoplamientos Para Motores Eléctricos (IEC)**

PL	IEC 63			IEC 71			IEC 80			IEC 90			IEC 100			IEC 112			
	L <sub>T</sub>	Z	ØD	L <sub>T</sub>	Z	ØD	L <sub>T</sub>	Z	ØD	L <sub>T</sub>	Z	ØD	L <sub>T</sub>	Z	ØD	L <sub>T</sub>	Z	ØD	
10001	-	-	-	-	-	-	-	-	-	-	-	-	-	-	-	-	-	-	-
10002	218.5	-	-	218.5	-	-	238.5	-	-	238.5	-	-	248.5	-	-	248.5	-	-	248.5
10003	279.5	36	140	279.5	36	160	299.5	56	200	299.5	56	200	309.5	66	250	309.5	66	250	309.5
10004	327.5	-	-	327.5	-	-	347.5	-	-	347.5	-	-	357.5	-	-	357.5	-	-	357.5

PL	IEC 132			IEC 160			IEC 180			IEC 200			IEC 225		
	L <sub>T</sub>	Z	ØD	L <sub>T</sub>	Z	ØD	L <sub>T</sub>	Z	ØD	L <sub>T</sub>	Z	ØD	L <sub>T</sub>	Z	ØD
10001	-	-	-	229	118	350	229	118	350	259	148	400	259	148	450
10002	282.5	-	-	321.5	-	-	321.5	139	350	-	-	-	-	-	-
10003	343.5	100	300	382.5	139	350	-	-	-	-	-	-	-	-	-
10004	391.5	-	-	430.5	-	-	-	-	-	-	-	-	-	-	-

PL	IEC ~ Kg										
	63	71	80	90	100	112	132	160	180	200	225
10001	-	-	-	-	-	-	-	88	88	98	103
10002	87	87	89	89	90	90	94	104	104	-	-
10003	95	95	97	97	98	98	102	112	-	-	-
10004	101	101	103	103	104	104	108	118	-	-	-

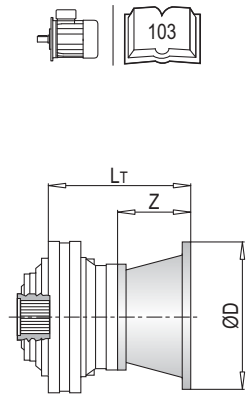

**PL 10000 F - Giriş Milleri / Input Shafts / Antriebswellen / Alberi Entrata / Arbres D'entree / Ejes De Entrada**

PL	EL C 28				EL C 42				EML 42				EML 1"3/8 Z6				EM 65				EM 1"3/8 Z6			
	L <sub>T</sub>	Z	L	Ød	L <sub>T</sub>	Z	L	Ød	L <sub>T</sub>	Z	L	Ød	L <sub>T</sub>	Z	L	Ød	L <sub>T</sub>	Z	L	Ød	L <sub>T</sub>	Z	L	Ød
10001	-	-	-	-	-	-	-	-	-	-	-	-	-	-	-	-	232.5	121.5	105	65	232.5	121.5	105	1"3/8
10002	246.5	-	-	-	246.5	-	-	-	276.5	-	-	-	276.5	-	-	-	317.5	-	-	317.5	-	-	-	-
10003	307.5	64	50	28	307.5	64	82	42	337.5	94	82	42	337.5	94	106	1"3/8	-	-	-	-	-	-	-	-
10004	355.5	-	-	-	355.5	-	-	-	385.5	-	-	-	385.5	-	-	-	-	-	-	-	-	-	-	-

PL	EP 65				PL	~ Kg						
	L <sub>T</sub>	Z	L	Ød		EL C 28	EL C 42	EML 42	EML 1"3/8 Z6	EM 65	EM 1"3/8 Z6	EP 65
10001	264	153	105	65	10001	-	-	-	-	83.0	83.0	92.0
10002	349	-	-	-	10002	87.5	88.0	91.0	91.0	99.0	99.0	108.0
10003	-	-	-	-	10003	95.5	96.0	99.0	99.0	-	-	-
10004	-	-	-	-	10004	101.5	102.0	105.0	105.0	-	-	-

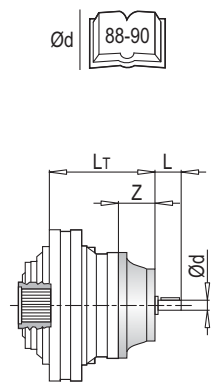

**PL 10000 F - Sonsuz Dişlili Redüktör Adaptörleri (PMRV/PRV) / Worm Gearbox Adaptors (PMRV/PRV) / Anschluss Für Schneckengetriebe (PMRV/PRV) / Predisposizioni Per Riduttori A Vite Senza Fine (PMRV/PRV) / Adaptation Pour Reducteurs A Vis Sans Fin (PMRV/PRV) / Acoplamiento Para Reductores De Tornillo Sin Fin (PMRV/PRV)**

PL	PMRV/PRV 050					PMRV/PRV 063					PMRV/PRV 075				
	Lm	l	h	MA	G	Lm	l	h	MA	G	Lm	l	h	MA	G
10001	-					-					-				
10002	308					317.5					296.5				
10003	369	50	110	60	80	378.5	63	135	72	95	357.5	75	161	86	112.5
10004	417					426.5					405.5				

PL	PMRV/PRV 090					PMRV/PRV 110					PMRV/PRV 130				
	Lm	l	h	MA	G	Lm	l	h	MA	G	Lm	l	h	MA	G
10001	-					249	110	237.5	127.5	160	256.5	130	277.5	147.5	180
10002	306.5					334					341.5				
10003	367.5	90	193	103	129.5	-					-				
10004	415.5					-					-				

PL	PMRV/PRV ~ Kg					
	050	063	075	090	110	130
10001	-	-	-	-	112	129
10002	90	93.5	96	101	128	145
10003	98	101.5	104	109	-	-
10004	104	107.5	110	115	-	-

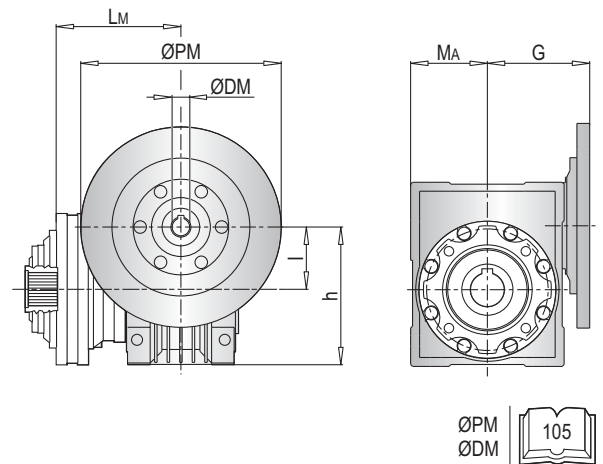

**PLB 10000 F - Elektrik Motor Adaptörleri (IEC) / Electric Motor Couplings (IEC) / Anbauvorrichtung Für Elektromotore (IEC) / Predisposizioni Per Motori Elettrici (IEC) / Adaptations Pour Moteurs Electriques (IEC) / Acoplamientos Para Motores Eléctricos (IEC)**

PLB	IEC 80				IEC 90				IEC 100				IEC 112				IEC 132				
	A	Lt	Z	ØD	A	Lt	Z	ØD	A	Lt	Z	ØD	A	Lt	Z	ØD	A	Lt	Z	ØD	
10002	199				199				199				199				199				
10003	284	296	56	200	284	296	56	200	284	306	66	250	284	306	66	250	284	340	100	300	
10004	318.5	216			318.5	216			318.5	226			318.5	226			318.5	260			

PLB	IEC 160				IEC 180			
	A	Lt	Z	ØD	A	Lt	Z	ØD
10002	199				199	379	139	350
10003	284	379	139	350	-			
10004	318.5	299			-			

PLB	IEC ~ Kg							
	80	90	100	112	132	160	180	
10002	111	111	112	112	116	126	126	
10003	130	130	131	131	135	145	-	
10004	113	113	114	114	118	128	-	

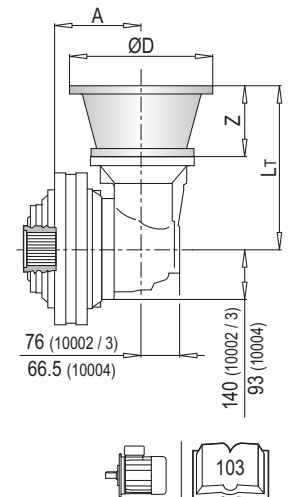

**PLB 10000 F - Giriş Milleri / Input Shafts / Antriebswellen / Alberi Entrata / Arbres D'entree / Ejes De Entrada**

PLB	EL C 28					EL C 42					EML 42					EML 1"3/8 Z6					EM 65					
	A	Lt	Z	L	Ød	A	Lt	Z	L	Ød	A	Lt	Z	L	Ød	A	Lt	Z	L	Ød	A	Lt	Z	L	Ød	
10002	199					199					199					199					199					
10003	284	304	64	50	28	284	304	64	82	42	284	334	94	82	42	284	334	94	106	1"3/8	284	377.5	121.5	105	65	
10004	318.5	224				318.5	224				318.5	254				318.5	254				318.5	297.5				

PLB	EM 1"3/8 Z6					EP 65				
	A	Lt	Z	L	Ød	A	Lt	Z	L	Ød
10002	199					199	409	153	105	65
10003	284	377.5	121.5	105	1"3/8	284	409	153	105	65
10004	318.5	297.5				318.5	329			

PLB	~ Kg							
	EL C 28	EL C 42	EML 42	EML 1"3/8 Z6	EM 65	EM 1"3/8 Z6	EP 65	
10002	109.5	110.0	113.0	113.0	121.0	121.0	130.0	
10003	128.5	129.0	132.0	132.0	140.0	140.0	149.0	
10004	111.5	112.0	115.0	115.0	123.0	123.0	132.0	

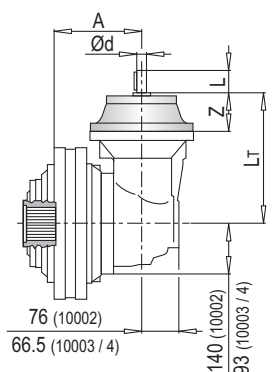

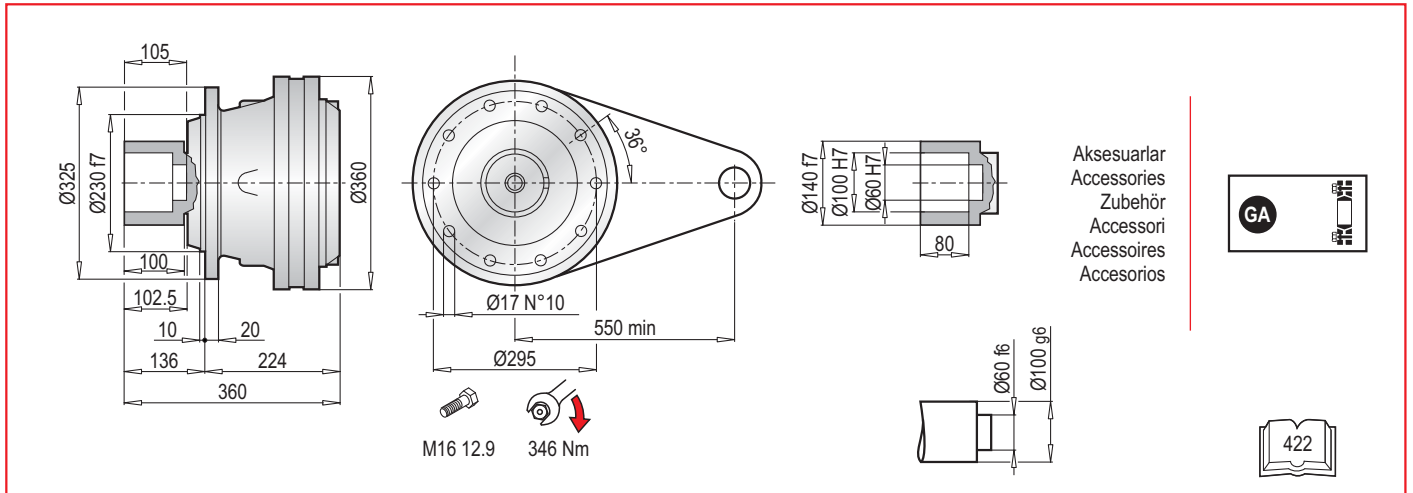

**PL 1000 FS - Elektrik Motor Adaptörleri (IEC) / Electric Motor Couplings (IEC) / Anbauvorrichtung Für Elektromotore (IEC) / Predisposizioni Per Motori Elettrici (IEC) / Adaptations Pour Moteurs Electriques (IEC) / Acoplamientos Para Motores Eléctricos (IEC)**

PL	IEC 63			IEC 71			IEC 80			IEC 90			IEC 100			IEC 112		
	L <sub>T</sub>	Z	ØD	L <sub>T</sub>	Z	ØD	L <sub>T</sub>	Z	ØD	L <sub>T</sub>	Z	ØD	L <sub>T</sub>	Z	ØD	L <sub>T</sub>	Z	ØD
10001	-	-	-	-	-	-	-	-	-	-	-	-	-	-	-	-	-	-
10002	331.5	-	-	331.5	-	-	351.5	-	-	351.5	-	-	361.5	-	-	361.5	-	-
10003	392.5	36	140	392.5	36	160	412.5	56	200	412.5	56	200	422.5	66	250	422.5	66	250
10004	440.5	-	-	440.5	-	-	460.5	-	-	460.5	-	-	470.5	-	-	470.5	-	-

PL	IEC 132			IEC 160			IEC 180			IEC 200			IEC 225		
	L <sub>T</sub>	Z	ØD	L <sub>T</sub>	Z	ØD	L <sub>T</sub>	Z	ØD	L <sub>T</sub>	Z	ØD	L <sub>T</sub>	Z	ØD
10001	-	-	-	342	118	350	342	118	350	372	148	400	372	148	450
10002	395.5	-	-	434.5	-	-	434.5	139	350	-	-	-	-	-	-
10003	456.5	100	300	495.5	139	350	-	-	-	-	-	-	-	-	
10004	504.5	-	-	543.5	-	-	-	-	-	-	-	-	-	-	

PL	IEC ~ Kg										
	63	71	80	90	100	112	132	160	180	200	225
10001	-	-	-	-	-	-	-	126	126	136	141
10002	125	125	127	127	128	128	132	142	142	-	-
10003	133	133	135	135	136	136	140	150	-	-	-
10004	139	139	141	141	142	142	146	156	-	-	-

**PL 1000 FS - Giriş Milleri / Input Shafts / Antriebswellen / Alberi Entrata / Arbres D'entree / Ejes De Entrada**

PL	EL C 28				EL C 42				EML 42				EML 1"3/8 Z6				EM 65				EM 1"3/8 Z6			
	L <sub>T</sub>	Z	L	Ød	L <sub>T</sub>	Z	L	Ød	L <sub>T</sub>	Z	L	Ød	L <sub>T</sub>	Z	L	Ød	L <sub>T</sub>	Z	L	Ød	L <sub>T</sub>	Z	L	Ød
10001	-	-	-	-	-	-	-	-	-	-	-	-	-	-	-	-	345.5	121.5	105	65	345.5	121.5	105	1"3/8
10002	359.5	-	-	-	359.5	-	-	-	389.5	-	-	-	389.5	-	-	-	430.5	-	-	-	430.5	-	-	-
10003	420.5	64	50	28	420.5	64	82	42	450.5	94	82	42	405.5	94	106	1"3/8	-	-	-	-	-	-	-	-
10004	468.5	-	-	-	468.5	-	-	-	498.5	-	-	-	498.5	-	-	-	-	-	-	-	-	-	-	-

PL	EP 65				PL	~ Kg						
	L <sub>T</sub>	Z	L	Ød		EL C 28	EL C 42	EML 42	EML 1"3/8 Z6	EM 65	EM 1"3/8 Z6	EP 65
10001	377	-	-	-	10001	-	-	-	-	121.0	121.0	130.0
10002	462	153	105	65	10002	125.5	126.0	129.0	129.0	137.0	137.0	146.0
10003	-	-	-	-	10003	133.5	134.0	137.0	137.0	145.0	145.0	154.0
10004	-	-	-	-	10004	139.5	140.0	143.0	143.0	151.0	151.0	160.0

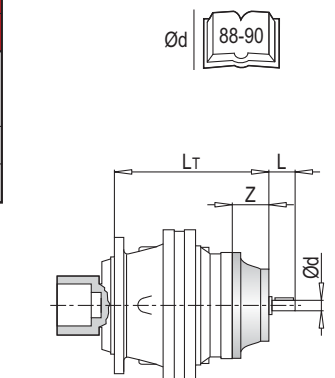
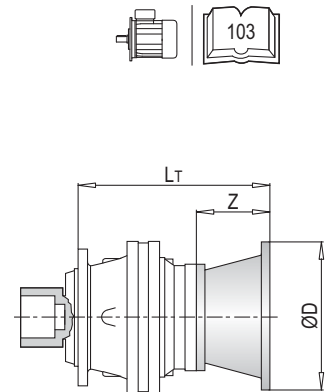

**PL 10000 FS** - Sonsuz Dişlili Redüktör Adaptörleri (PMRV/PRV) / Worm Gearbox Adaptors (PMRV/PRV) / Anschluss Für Schneckengetriebe (PMRV/PRV) / Predisposizioni Per Riduttori A Vite Senza Fine (PMRV/PRV) / Adaptation Pour Reducteurs A Vis Sans Fin (PMRV/PRV) / Acoplamiento Para Reductores De Tornillo Sin Fin (PMRV/PRV)

PL	PMRV/PRV 050					PMRV/PRV 063					PMRV/PRV 075				
	Lm	l	h	MA	G	Lm	l	h	MA	G	Lm	l	h	MA	G
10001	-					-					-				
10002	421					430.5					409.5				
10003	482	50	110	60	80	491.5	63	135	72	95	470.5	75	161	86	112.5
10004	530					539.5					518.5				

PL	PMRV/PRV 090					PMRV/PRV 110					PMRV/PRV 130					
	Lm	l	h	MA	G	Lm	l	h	MA	G	Lm	l	h	MA	G	
10001	-					362					369.5					180
10002	419.5					447	110	237.5	127.5	160	454.5	130	277.5	147.5	180	
10003	480.5	90	193	103	129.5	-					-					
10004	528.5					-					-					

PL	PMRV/PRV ~ Kg					
	050	063	075	090	110	130
10001	-	-	-	-	150	167
10002	128	131.5	134	139	166	183
10003	136	139.5	142	147	-	-
10004	142	145.5	148	153	-	-

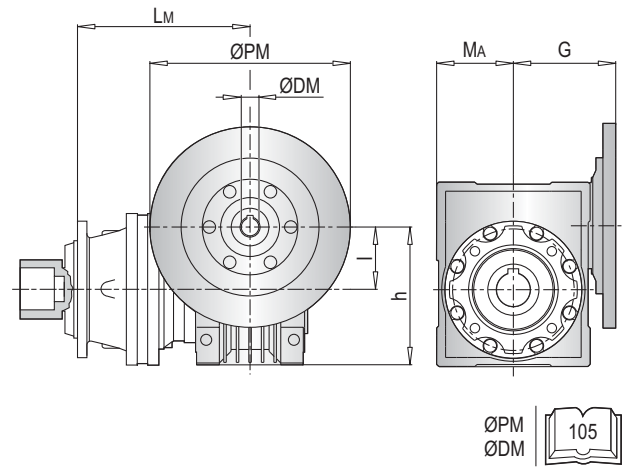

**PLB 10000 FS** - Elektrik Motor Adaptörleri (IEC) / Electric Motor Couplings (IEC) / Anbauvorrichtung Für Elektromotore (IEC) / Predisposizioni Per Motori Elettrici (IEC) / Adaptations Pour Moteurs Electriques (IEC) / Acoplamientos Para Motores Eléctricos (IEC)

PLB	IEC 80				IEC 90				IEC 100				IEC 112				IEC 132				
	A	Lt	Z	ØD	A	Lt	Z	ØD	A	Lt	Z	ØD	A	Lt	Z	ØD	A	Lt	Z	ØD	
10002	312				312				312				312				312				340
10003	397	296	56	200	397	296	56	200	397	306	66	250	397	306	66	250	397	340	100	300	
10004	431.5	216			431.5	216			431.5	226			431.5	226			431.5	260			

PLB	IEC 160				IEC 180			
	A	Lt	Z	ØD	A	Lt	Z	ØD
10002	312				312	379	139	350
10003	397	379	139	350	-			
10004	431.5	299			-			

PLB	IEC ~ Kg							
	80	90	100	112	132	160	180	
10002	148	148	149	149	153	163	163	
10003	167	167	168	168	172	182	-	
10004	150	150	151	151	155	165	-	

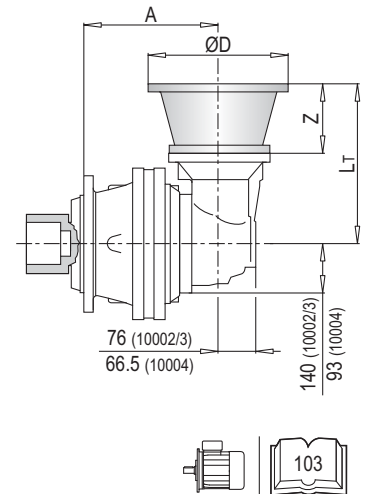

**PLB 10000 FS** - Giriş Milleri / Input Shafts / Antriebswellen / Alberi Entrata / Arbres D'entree / Ejes De Entrada

PLB	EL C 28					EL C 42					EML 42					EML 1"3/8 Z6					EM 65					
	A	Lt	Z	L	Ød	A	Lt	Z	L	Ød	A	Lt	Z	L	Ød	A	Lt	Z	L	Ød	A	Lt	Z	L	Ød	
10002	312					312					312					312					312					
10003	397	304	64	50	28	397	304	64	82	42	397	334	94	82	42	397	334	94	106	1"3/8	397	377.5	121.5	105	65	
10004	431.5	224				431.5	224				431.5	254				431.5	254				431.5	297.5				

PLB	EM 1"3/8 Z6					EP 65					PLB	~ Kg						
	A	Lt	Z	L	Ød	A	Lt	Z	L	Ød		EL C 28	EL C 42	EML 42	EML 1"3/8 Z6	EM 65	EM 1"3/8 Z6	EP 65
10002	312					312					10002	146.5	147.0	150.0	150.0	158.0	158.0	167.0
10003	397	377.5	121.5	105	1"3/8	397	409	153	105	65	10003	165.5	166.0	169.0	169.0	177.0	177.0	186.0
10004	431.5	297.5				431.5	329				10004	148.5	149.0	152.0	152.0	160.0	160.0	169.0

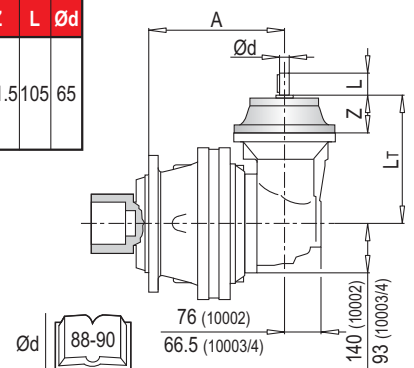

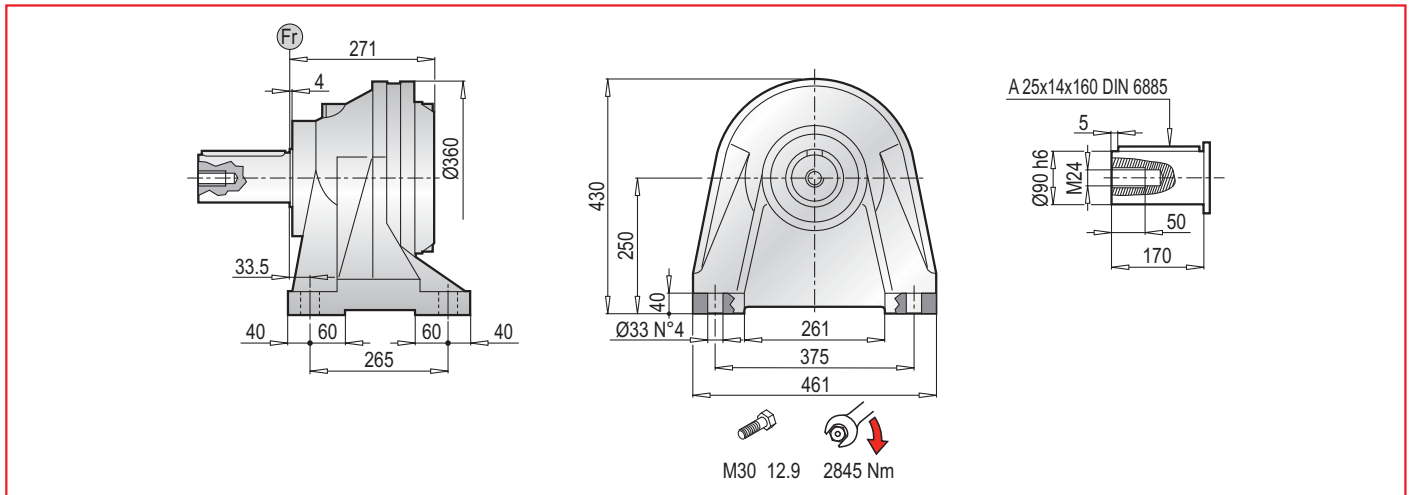

**PL 10000 CPC - Elektrik Motor Adaptörleri (IEC) / Electric Motor Couplings (IEC) / Anbauvorrichtung Für Elektromotore (IEC) / Predisposizioni Per Motori Elettrici (IEC) / Adaptations Pour Moteurs Electriques (IEC) / Acoplamientos Para Motores Eléctricos (IEC)**

PL	IEC 63			IEC 71			IEC 80			IEC 90			IEC 100			IEC 112		
	L <sub>T</sub>	Z	ØD	L <sub>T</sub>	Z	ØD	L <sub>T</sub>	Z	ØD	L <sub>T</sub>	Z	ØD	L <sub>T</sub>	Z	ØD	L <sub>T</sub>	Z	ØD
10001	-	-	-	-	-	-	-	-	-	-	-	-	-	-	-	-	-	-
10002	378.5	-	-	378.5	-	-	398.5	-	-	398.5	-	-	408.5	-	-	408.5	-	-
10003	439.5	36	140	439.5	36	160	459.5	56	200	459.5	56	200	469.5	66	250	469.5	66	250
10004	487.5	-	-	487.5	-	-	507.5	-	-	507.5	-	-	517.5	-	-	517.5	-	-

PL	IEC 132			IEC 160			IEC 180			IEC 200			IEC 225		
	L <sub>T</sub>	Z	ØD	L <sub>T</sub>	Z	ØD	L <sub>T</sub>	Z	ØD	L <sub>T</sub>	Z	ØD	L <sub>T</sub>	Z	ØD
10001	-	-	-	389	118	350	389	118	350	419	148	400	419	148	450
10002	442.5	-	-	481.5	-	-	481.5	139	350	-	-	-	-	-	-
10003	503.5	100	300	542.5	139	350	-	-	-	-	-	-	-	-	-
10004	551.5	-	-	590.5	-	-	-	-	-	-	-	-	-	-	-

PL	IEC ~ Kg										
	63	71	80	90	100	112	132	160	180	200	225
10001	-	-	-	-	-	-	-	171	171	181	186
10002	170	170	172	172	173	173	177	187	187	-	-
10003	178	178	180	180	181	181	185	195	-	-	-
10004	184	184	186	186	187	187	191	201	-	-	-

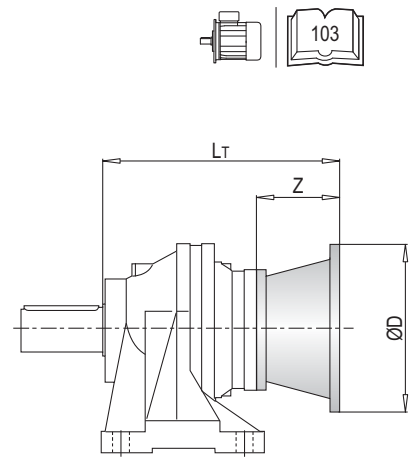

**PL 10000 CPC - Giriş Milleri / Input Shafts / Antriebswellen / Alberi Entrata / Arbres D'entree / Ejes De Entrada**

PL	EL C 28				EL C 42				EML 42				EML 1"3/8 Z6				EM 65				EM 1"3/8 Z6			
	L <sub>T</sub>	Z	L	Ød	L <sub>T</sub>	Z	L	Ød	L <sub>T</sub>	Z	L	Ød	L <sub>T</sub>	Z	L	Ød	L <sub>T</sub>	Z	L	Ød	L <sub>T</sub>	Z	L	Ød
10001	-	-	-	-	-	-	-	-	-	-	-	-	-	-	-	-	392.5	121.5	105	65	392.5	121.5	105	1"3/8
10002	406.5	-	-	-	406.5	-	-	-	436.5	-	-	-	436.5	-	-	-	477.5	-	-	-	477.5	-	-	-
10003	467.5	64	50	28	467.5	64	82	42	497.5	94	82	42	497.5	94	106	1"3/8	-	-	-	-	-	-	-	-
10004	515.5	-	-	-	515.5	-	-	-	545.5	-	-	-	545.5	-	-	-	-	-	-	-	-	-	-	-

PL	EP 65				PL	~ Kg						
	L <sub>T</sub>	Z	L	Ød		EL C 28	EL C 42	EML 42	EML 1"3/8 Z6	EM 65	EM 1"3/8 Z6	EP 65
10001	424	153	105	65	10001	-	-	-	-	166.0	166	175
10002	509	-	-	-	10002	170.5	171.0	174.0	174.0	182.0	182	191
10003	-	-	-	-	10003	178.5	179.0	182.0	182.0	-	-	-
10004	-	-	-	-	10004	184.5	185.0	188.0	188.0	-	-	-

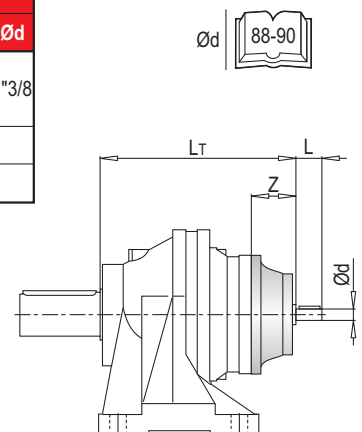

**PL 10000 CPC - Sonsuz Dişli Redüktör Adaptörleri (PMRV/PRV) / Worm Gearbox Adaptors (PMRV/PRV) / Anschluss Für Schneckengetriebe (PMRV/PRV) / Predisposizioni Per Riduttori A Vite Senza Fine (PMRV/PRV) / Adaptation Pour Reducteurs A Vis Sans Fin (PMRV/PRV) / Acoplamiento Para Reductores De Tornillo Sin Fin (PMRV/PRV)**

PL	PMRV/PRV 050					PMRV/PRV 063					PMRV/PRV 075				
	Lm	I	h	MA	G	Lm	I	h	MA	G	Lm	I	h	MA	G
10001	-					-					-				
10002	468					477.5					456.5				
10003	529	50	110	60	80	538.5	63	135	72	95	517.5	75	161	86	112.5
10004	577					586.5					565.5				

PL	PMRV/PRV 090					PMRV/PRV 110					PMRV/PRV 130					
	Lm	I	h	MA	G	Lm	I	h	MA	G	Lm	I	h	MA	G	
10001	-					409					416.5					
10002	466.5					494	110	237.5	127.5	160	501.5	130	277.5	147.5	180	
10003	517.5	90	193	103	129.5	-					-					
10004	575.5					-					-					

PL	PMRV/PRV ~ Kg					
	050	063	075	090	110	130
10001	-	-	-	-	195	212
10002	173	176.5	179	184	211	228
10003	181	184.5	187	191	-	-
10004	187	190.5	193	197	-	-

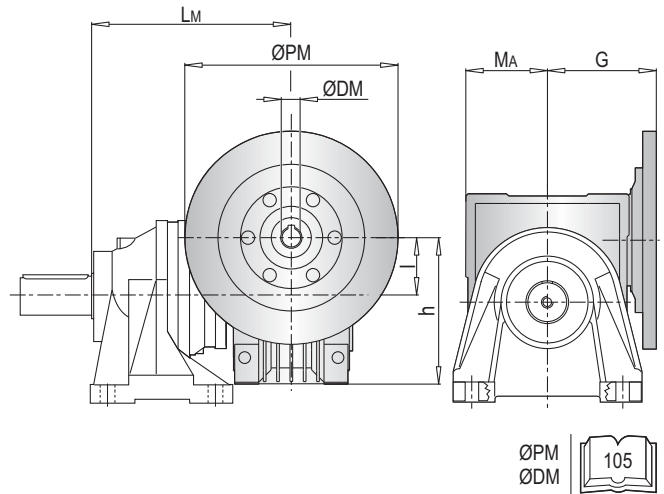

**PLB 10000 CPC - Elektrik Motor Adaptörleri (IEC) / Electric Motor Couplings (IEC) / Anbauvorrichtung Für Elektromotore (IEC) / Predisposizioni Per Motori Elettrici (IEC) / Adaptations Pour Moteurs Electriques (IEC) / Acoplamientos Para Motores Eléctricos (IEC)**

PLB	IEC 80				IEC 90				IEC 100				IEC 112				IEC 132			
	A	Lt	Z	ØD	A	Lt	Z	ØD	A	Lt	Z	ØD	A	Lt	Z	ØD	A	Lt	Z	ØD
10002	359				359				359				359				359			
10003	444	296	56	200	444	296	56	200	444	306	66	250	444	306	66	250	444	340	100	300
10004	478.5	216			478.5	216			478.5	226			478.5	226			478.5	260		

PLB	IEC 160				IEC 180			
	A	Lt	Z	ØD	A	Lt	Z	ØD
10002	359				359	379	139	350
10003	444	379	139	350	-			
10004	478.5	299			-			

PLB	IEC ~ Kg						
	80	90	100	112	132	160	180
10002	172	172	173	173	177	187	187
10003	180	180	181	181	185	195	-
10004	186	186	187	187	191	-	-

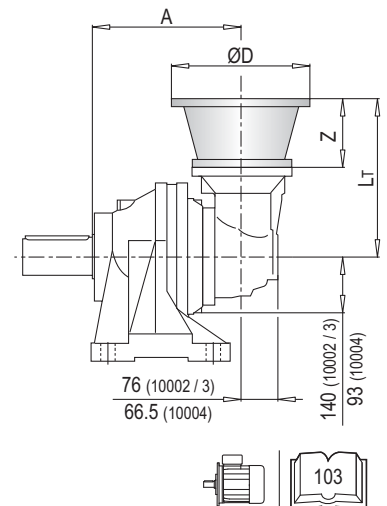

**PLB 10000 CPC - Giriş Milleri / Input Shafts / Antriebswellen / Alberi Entrata / Arbres D'entree / Ejes De Entrada**

PLB	EL C 28					EL C 42					EML 42					EML 1"3/8 Z6					EM 65				
	A	Lt	Z	L	Ød	A	Lt	Z	L	Ød	A	Lt	Z	L	Ød	A	Lt	Z	L	Ød	A	Lt	Z	L	Ød
10002	359					359					359					359					359				
10003	444	304	64	50	28	444	304	64	82	42	444	334	94	82	42	444	334	94	106	1"3/8	444	377.5	121.5	105	65
10004	478.5	224				478.5	224				478.5	254				478.5	254				478.5	297.5			

PLB	EM 1"3/8 Z6					EP 65				
	A	Lt	Z	L	Ød	A	Lt	Z	L	Ød
10002	359					359				
10003	444	377.5	121.5	105	1"3/8	444	400	153	105	65
10004	478.5	297.5				478.5	329			

PLB	~ Kg						
	EL C 28	EL C 42	EML 42	EML 1"3/8 Z6	EM 65	EM 1"3/8 Z6	EP 65
10002	191.5	192.0	195.0	195.0	203.0	203.0	212.0
10003	211.5	212.0	215.0	215.0	223.0	223.0	232.0
10004	193.5	194.0	197.0	197.0	205.0	205.0	214.0

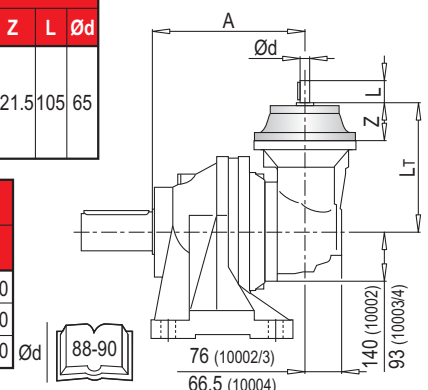

PL	~ Kg
MS	
10001	98
10002	115
10003	123
10004	129

PL	~ Kg
MC	
10001	98
10002	115
10003	123
10004	129

PL	~ Kg
F	
10001	66
10002	82
10003	90
10004	96

PL	~ Kg
FS	
10001	104
10002	120
10003	128
10004	134

PL	~ Kg
CPC	
10001	149
10002	165
10003	173
10004	179

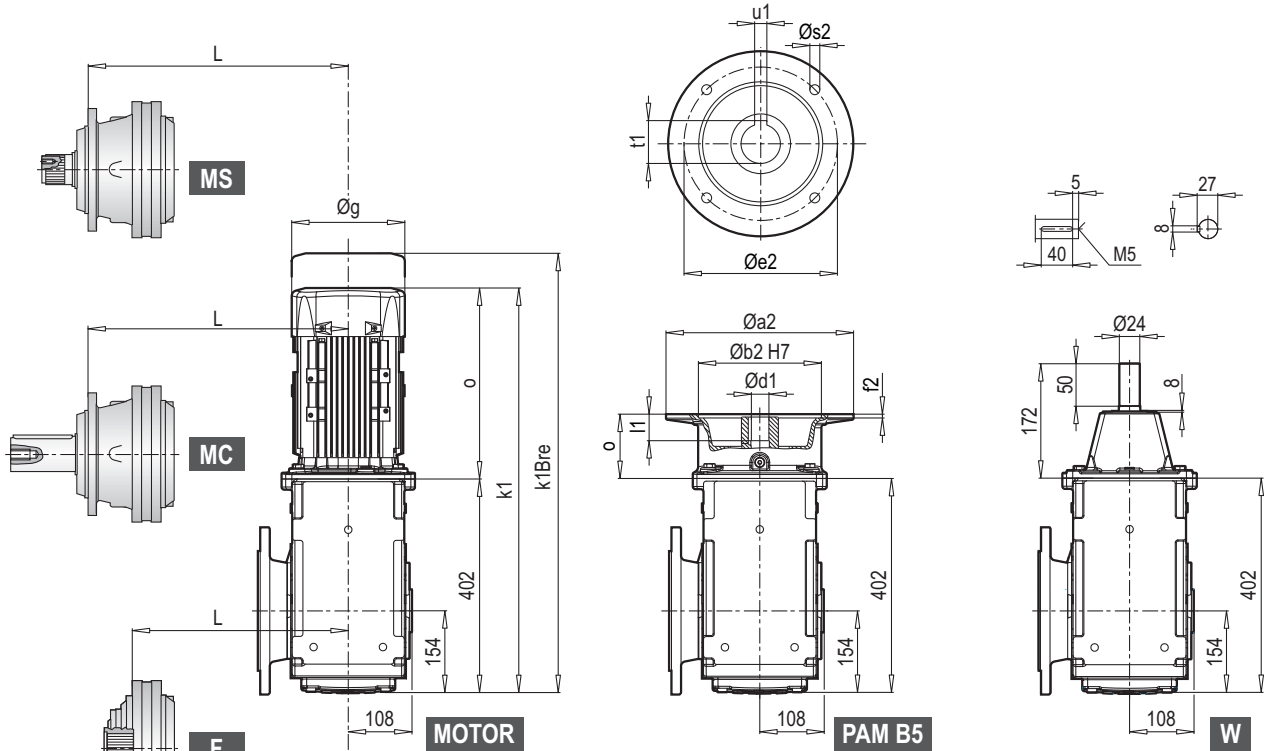

W ~ Kg	
PKD 4390	131

PL	L				
	MS	MC	F	FS	CPC
10001	412	412	299	412	459
10002	505	505	392	505	552
10003	566	566	453	566	613
10004	614	614	501	614	661

	MOTOR	g	g1	k1	k1Bre	o
PKD 4390	90 S	193	151	667	740	265
	90 L	193	151	687	760	285
	100 L	217	160	715	796	313
	112 M	232	168	760	840	358
	132 S	279	182	767	875	365
	132 M	279	182	802	943	400
	160 M	323	200	907	1059	505
	160 L	323	200	907	1059	505

~ Kg	
MOTOR	PKD 4390
90 S	124
90 L	126
100 L	137
112 M	143
132 S	160
132 M	171
160 M	202
160 L	211

	PAM B5	Øa2	Øb2	Øe2	f2	Øs2	Ød1	l1	t1	u1	o
PKD 4390	90	200	130	165	4.0	M10	24	50	27.3	8	72
	100	250	180	215	5.0	M12	28	60	31.3	8	75
	112	250	180	215	5.0	M12	28	60	31.3	8	75
	132	300	230	265	5.0	M12	38	80	41.3	10	94
	160	350	250	300	6.0	M16	42	110	45.3	12	120

~ Kg	
PAM B5	PKD 4390
90	116
100	117
112	117
132	126
160	134

PL	~ Kg
MS	
10001	98
10002	115
10003	123
10004	129

PL	~ Kg
MC	
10001	98
10002	115
10003	123
10004	129

PL	~ Kg
F	
10001	66
10002	82
10003	90
10004	96

PL	~ Kg
FS	
10001	104
10002	120
10003	128
10004	134

PL	~ Kg
CPC	
10001	149
10002	165
10003	173
10004	179

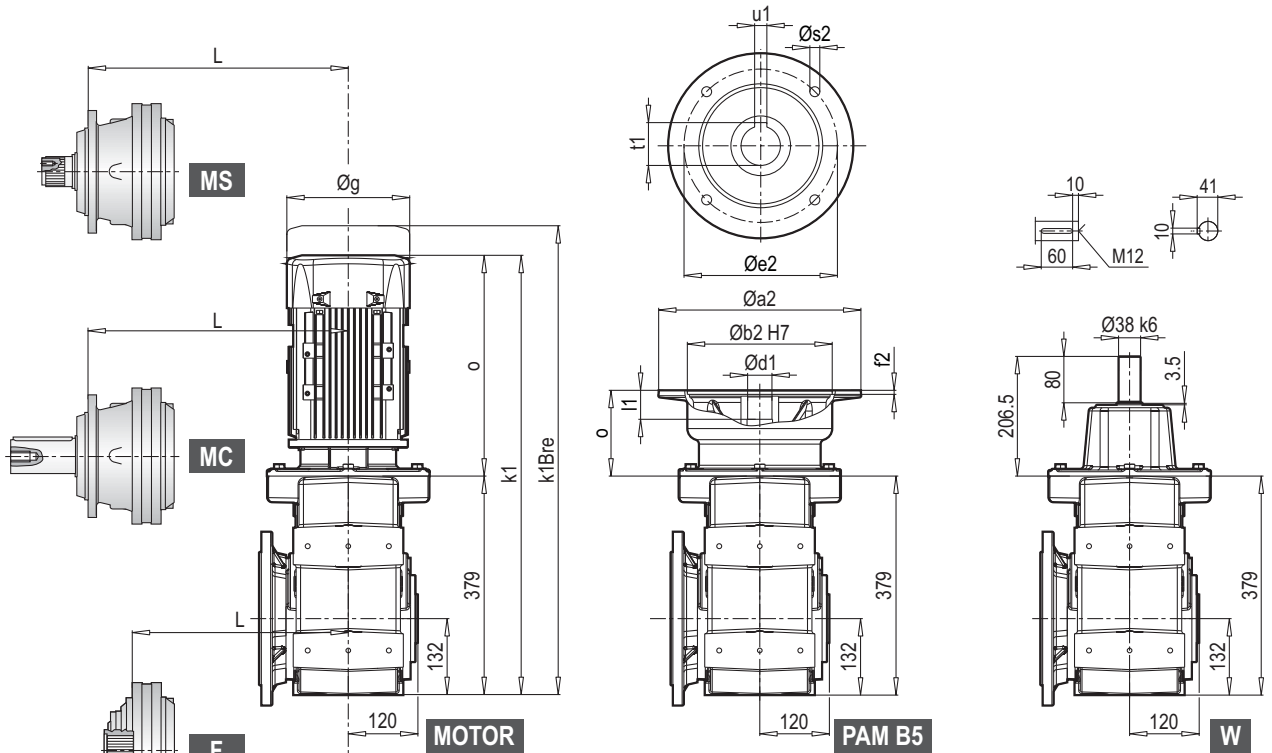

PL	L				
	MS	MC	F	FS	CPC
10001	433	433	320	433	480
10002	505	505	392	505	552
10003	566	566	453	566	613
10004	614	614	501	614	661

W ~ Kg	
K 60390	89

	MOTOR	K 60390				
		g	g1	k1	k1Bre	o
K 60390	90 S	193	151	662	735	283
	90 L	193	151	682	755	303
	100 L	217	160	705	786	326
	112 M	232	168	759	839	380
	132 S	279	182	765	873	386
	132 M	279	182	800	941	421
	160 M/L	323	200	887	1039	508
	180 M/L	370	248	952	1114	573

	~ Kg	
	MOTOR	K 60390
90 S	88	
90 L	90	
100 L	101	
112 M	107	
132 S	124	
132 M	135	
160 M/L	176	
180 M/L	220	

	PAM B5	K 60390									
		Øa2	Øb2	Øe2	f2	Øs2	Ød1	l1	t1	u1	o
K 60390	90	200	130	165	5	M10	24	52	27.3	8	61
	100	250	180	215	5.5	M12	28	62	31.3	8	76
	112	250	180	215	5.5	M12	28	62	31.3	8	76
	132	300	230	265	5.5	M12	38	82	41.3	10	101
	160	350	250	300	7	M16	42	112	45.3	12	148
	180	350	250	300	7	M16	48	112	51.8	14	148

	~ Kg	
	PAM B5	K 60390
90	80	
100	84	
112	84	
132	87	
160	93	
180	93	

AKSESUARLAR / ACCESSORIES / ZUBEHÖR / ACCESSORI / ACCESSOIRES / ACCESORIOS

**YZ** Pinyon / Pinion / Ritzel  
Pignoni / Pignon / Piñones

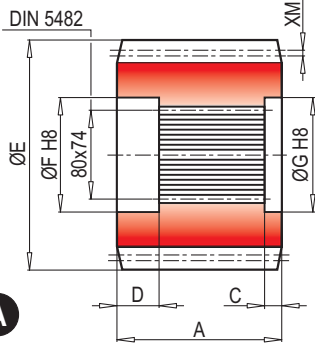

Çıkış tipi Output type Abtriebs-version Versione Version Versión	M	Z	XM	A	B	C	D	E	F	G	K	Malzeme Material Material Matière Material	Kod Code Bestell-Nr. Code Code Código	
<b>A</b>	M	10	12	0	90	-	10	31	140	85	80	-	38NiCrMo4	1071.236.042
	M	10	14	0	90	-	10	31	160	85	80	-	38NiCrMo4	1071.238.042
<b>B</b>	M	12	14	3	90	115	25	31	194.5	85	80	130	39NiCrMo3	1071.286.042

**A**

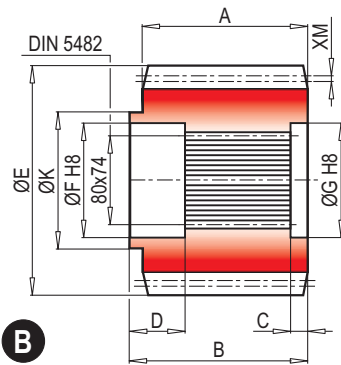

**B**

**FF** Sabitleme rondelası / Stop bottom plate / Endscheibe /  
Fondello di arresto / Bouchon de fermeture / Tapón de detención

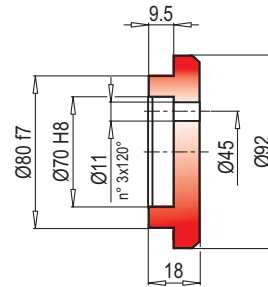

Kod / Code  
Bestell - Nr. / Codice  
Code / Código  
**1075.030.000**

**BS** Spline kaplin / Splined bushing / Innenverzahnte Buchse /  
Boccola scanalata / Moyeu cannelé / Casquillo ranurado

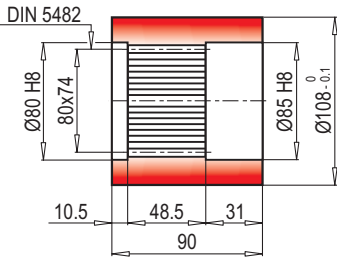

Malzeme / Material  
Material / Materiale  
Matière / Material  
UNI C40  
SAE 1040  
DIN Ck40

Kod / Code  
Bestell - Nr. / Codice  
Code / Código  
**6171.103.076**

**KB** Spline mil / Splined rod / Außenverzahnte Welle /  
Barra scanalata / Arbre cannelé / Barra ranurada

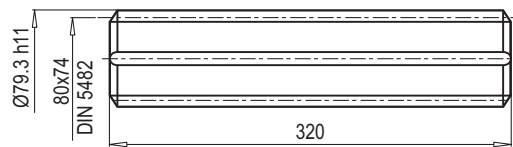

Malzeme / Material  
Material / Materiale  
Matière / Material

UNI 39NiCrMo3  
Sertleşmiş ve tavlanmış / Hardened and tempered  
Vergütet / Bonifié  
Bonificado / Endurecido e temperado

Kod / Code  
Bestell - Nr. / Codice  
Code / Código  
**3071.406.042**

**FL** Flanş / Flange / Flansch  
Flangia / Bride / Brida

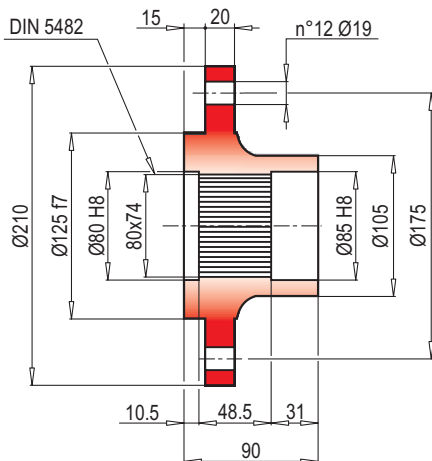

Kod / Code  
Bestell - Nr. / Codice  
Code / Código  
**6171.105.098**

**GA** Konik sıkırtma / Shrink disc / Schrumpfscheibe /  
Giunto di attrito / Frette de serrage / Disco de contracción

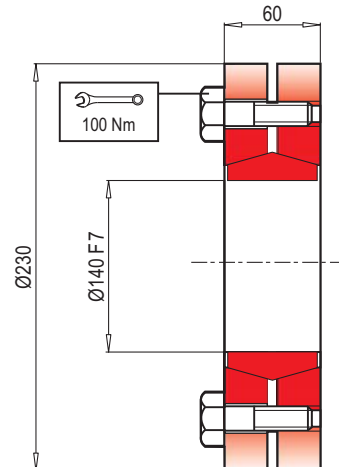

Maksimum moment  
Max. torque  
Max. Drehmoment  
Coppia max.  
Couple max.  
Momento máx.  
**17.6 kNm**

Kod / Code  
Bestell - Nr. / Codice  
Code / Código  
**5109.140.000**

TR

**RADYAL YÜKLER (Fr)**

Aşağıdaki grafikler istenilen  $n_2xh$  değerinin elde edilmesi için gerekli olan radyal yükleri ve K faktörlerini göstermektedir.

EN

**RADIAL LOADS (Fr)**

The following curves show the radial loads and the K factors to obtain the required  $n_2xh$  value.

DE

**RADIALLAST (Fr)**

In den nachstehenden Diagrammen ist die Radiallast und der Koeffizient K dargestellt und kann mit dem gewünschten Wert  $n_2xh$  verglichen werden.

IT

**CARICHI RADIALI (Fr)**

Nei diagrammi seguenti sono riportati i carichi radiali e i coefficienti K per rapportarli al valore  $n_2xh$  desiderato.

FR

**CHARGES RADIALES (Fr)**

Dans les diagrammes suivants sont indiqués les charges radiales et les facteurs K de façon à obtenir la valeur  $n_2xh$  désirée.

ES

**CARGAS RADIALES (Fr)**

En los siguientes diagramas se indican las cargas radiales y los coeficientes K para obtener el valor requerido  $n_2xh$ .

**M - CPC\***

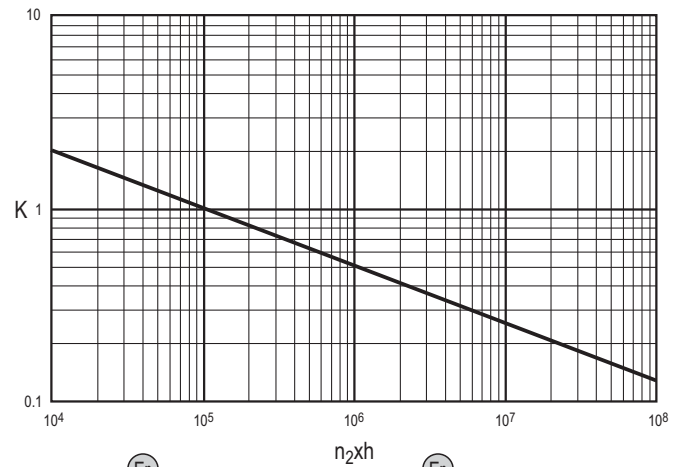
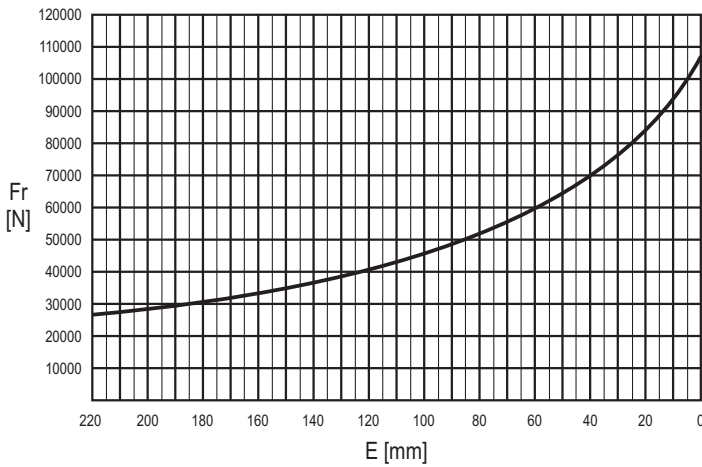

	$n \times h$				
	$10^5$	$10^4$	$10^6$	$10^7$	$10^8$
<b>M</b>	Fr			Fr • K	
<b>CPC*</b>	Fr • 0.75			Fr • K • 0.75	

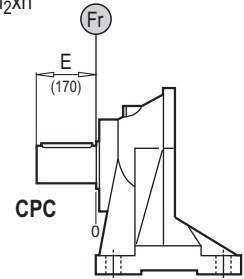
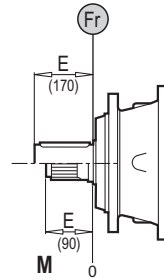

TR

**EKSENEL YÜKLER (Fa)**

Tabloda yer alan eksenel yük değerleri, çıkış tipine ve uygulamanın yük yönüne göre değişir.

EN

**AXIAL LOADS (Fa)**

The values of the axial loads in the table refer to the output versions and load direction of application.

DE

**AXIALLAST (Fa)**

Die dargestellten Werte der Axiallast basieren auf der Version und der applizierten Lastrichtung.

IT

**CARICHI ASSIALI (Fa)**

I valori dei carichi assiali indicati in tabella sono riferiti alle versioni e alla direzione di applicazione del carico.

FR

**CHARGES AXIALES (Fa)**

Les valeurs des charges axiales indiquées dans le tableau se réfèrent aux versions et à la direction d'application de la charge.

ES

**CARGAS AXIALES (Fa)**

Los valores de las cargas axiales indicados en la tabla se refieren a las versiones y a la dirección de aplicación de la carga.

Fa [N]	<b>M</b>	<b>CPC</b>	← →
	40000	40000	
65000	65000	65000	← →

