

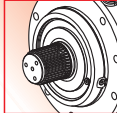





TEKNİK VERİLER / TECHNICAL DATA / TECHNISCHE DATEN / DATI TECNICI / DONNÉES TECHNIQUES / DATOS TÉCNICAS

	i_{ges}	M_2max (n1: 1400rpm) (Nm)	OUTPUT		INPUT	
35001	4.00 ... 4.71	15870	 Ø120	 W120X3X38X8f DIN 5480	 Ø28 - Ø42 1"3/8 - Ø65 - Ø90	 Hydraulic Motor
35002	14.2 ... 27.0	21610	 Ø135	 N120X5X22X9H DIN 5480	 Electric Motor	 Worm gearboxes
35003	53.7 ... 230.3	27380				
35004	191.0 ... 1289.7	36840			 Brake	

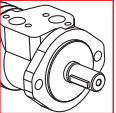
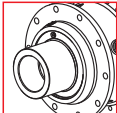
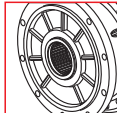
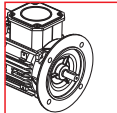
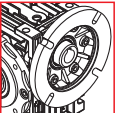
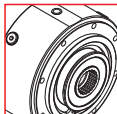
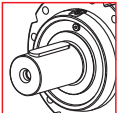
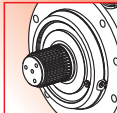
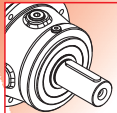
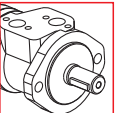
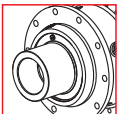
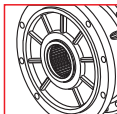
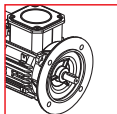
	i_{ges}	M_2max (n1: 1400rpm) (Nm)	OUTPUT		INPUT	
35002	12.3 ... 22.0	20850	 Ø120	 W120X3X38X8f DIN 5480	 Ø28 - Ø42 1"3/8 - Ø65	 Hydraulic Motor
35003	43.7 ... 123.0	26970	 Ø135	 N120X5X22X9H DIN 5480	 Electric Motor	
35004	185.6 ... 1253.8	36840			 Brake	

	Pt [kW]	n _{1max} [min ⁻¹]	i _{ges}	Mc [kNm]				Giriş- Input - Antrieb - Entrada - Entrée - Entrada		
				n ₂ x h	n ₂ x h	n ₂ x h	n ₂ x h			
				10.000	20.000	50.000	100.000	IEC (B5)	PMRV / PRV	EL - EML EM - EP - ET
PL 35001	54	1500	4.00 4.71	43.22 36.83	38.25 32.60	32.55 27.74	28.82 24.55	160 225 180 250 200	-	-
PL 35002	34	2000	14.2 17.1 20.2 22.4 27.0	43.22 43.22 36.83 43.22 36.83	38.25 38.25 32.60 38.25 32.60	32.55 32.55 27.74 32.55 27.74	28.82 28.82 24.55 28.82 24.55	160 180 200	110 130 150	EM 65 EM 1"3/8 Z6 EP 65 ET 90
PL 35003	23	2800	53.7 58.7 64.8 70.7 83.2 88.6 99.6 108.7 121.0 136.2 158.1 164.1 191.1 230.3	43.22 43.22 43.22 43.22 36.83 43.22 36.83 36.83 36.83 36.83 36.83 36.83 36.83 36.83	38.25 38.25 38.25 38.25 32.60 38.25 32.60 32.60 32.60 32.60 32.60 32.60 32.60 32.60	32.55 32.55 32.55 32.55 27.74 32.55 27.74 27.74 27.74 27.74 27.74 27.74 27.74 27.74	28.82 28.82 28.82 28.82 24.55 28.82 24.55 24.55 24.55 24.55 24.55 24.55 24.55 24.55	63 71 80 90 100 112 132 160 180	050 063 075 090 110 130 150	EL C 28 EL C 42 EML 42 EML 1"3/8 Z6 EM 65 EM 1"3/8 Z6 EP 65
PL 35004	17	2800	191.0 208.6 230.3 251.4 277.5 303.1 328.5 362.7 379.6 437.1 496.0 583.5 677.7 703.4 762.5 816.8 987.0 1067.3 1289.7	43.22 43.22 43.22 43.22 43.22 43.22 43.22 43.22 43.22 43.22 43.22 36.83 36.83 36.83 36.83 36.83 36.83 36.83 36.83	38.25 38.25 38.25 38.25 38.25 38.25 38.25 38.25 38.25 38.25 38.25 32.60 32.60 32.60 32.60 32.60 32.60 32.60 32.60	32.55 32.55 32.55 32.55 32.55 32.55 32.55 32.55 32.55 32.55 32.55 27.74 27.74 27.74 27.74 27.74 27.74 27.74 27.74	28.82 28.82 28.82 28.82 28.82 28.82 28.82 28.82 28.82 28.82 28.82 24.55 24.55 24.55 24.55 24.55 24.55 24.55 24.55	63 71 80 90 100 112 132 160 180	050 063 075 090	EL C 28 EL C 42 EML 42 EML 1"3/8 Z6

	Pt [kW]	n _{1max} [min ⁻¹]	i _{ges}	Mc [kNm]				Giriş- Input - Antrieb - Entrada - Entrée - Entrada	
				n ₂ x h	n ₂ x h	n ₂ x h	n ₂ x h		
				10.000	20.000	50.000	100.000	IEC (B5)	EL - EML EM - EP - ET
PLB 35002	34	2000	12.3	43.22	38.25	32.55	28.82	160 180 200	EM 65 EM 1"3/8 Z6 EP 65
			14.5	36.83	32.60	27.74	24.55		
			18.7	43.22	38.25	32.55	28.82		
			22.0	36.83	32.60	27.74	24.55		
PLB 35003	23	2800	43.7	43.22	38.25	32.55	28.82	160 180	EM 65 EM 1"3/8 Z6 EP 65
			52.7	43.22	38.25	32.55	28.82		
			66.4	43.22	38.25	32.55	28.82		
			80.0	43.22	38.25	32.55	28.82		
			94.1	36.83	32.60	27.74	24.55		
			123.0	36.83	32.60	27.74	24.55		
PLB 35004	17	2800	185.6	43.22	38.25	32.55	28.82	80 90 100 112 132 160	EL C 28 EL C 42 EML 42 EML 1"3/8 Z6 EM 65 EM 1"3/8 Z6 EP 65
			202.7	43.22	38.25	32.55	28.82		
			223.7	43.22	38.25	32.55	28.82		
			244.3	43.22	38.25	32.55	28.82		
			292.5	43.22	38.25	32.55	28.82		
			319.4	43.22	38.25	32.55	28.82		
			352.6	43.22	38.25	32.55	28.82		
			385.0	43.22	38.25	32.55	28.82		
			414.8	36.83	32.60	27.74	24.55		
			452.9	36.83	32.60	27.74	24.55		
			542.0	36.83	32.60	27.74	24.55		
			591.8	36.83	32.60	27.74	24.55		
			658.8	36.83	32.60	27.74	24.55		
			741.3	36.83	32.60	27.74	24.55		
			860.9	36.83	32.60	27.74	24.55		
			1037.7	36.83	32.60	27.74	24.55		
1253.8	36.83	32.60	27.74	24.55					



$$M_{\max} = M_C \times 1.65$$

(n₂ x h = 20.000)

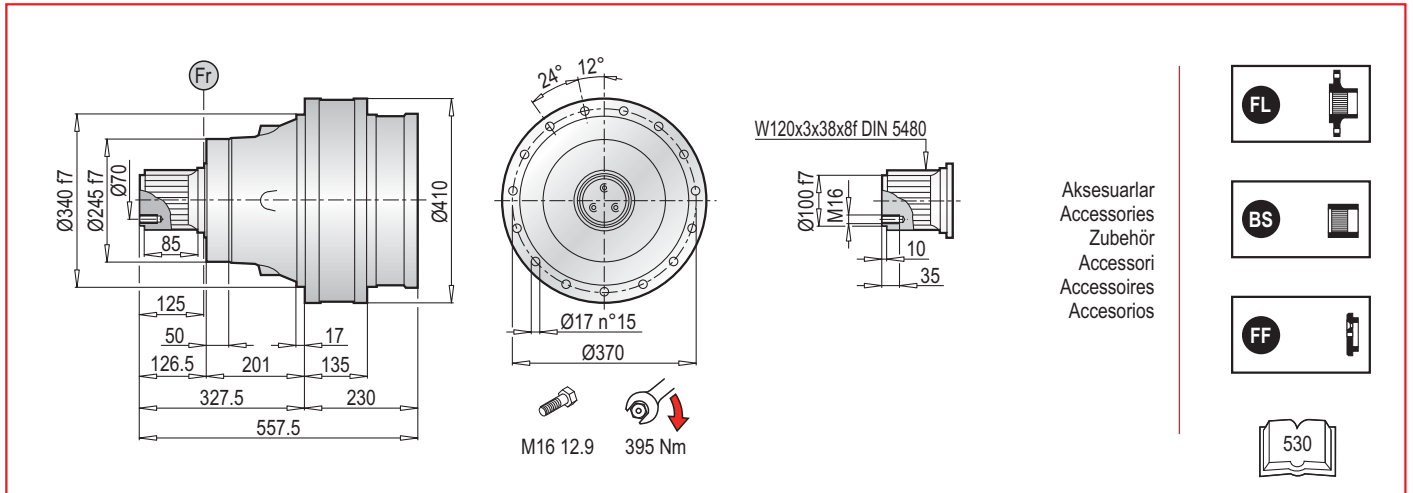

PL 35000 MS - Elektrik Motor Adaptörleri (IEC) / Electric Motor Couplings (IEC) / Anbauvorrichtung Für Elektromotore (IEC) / Predisposizioni Per Motori Elettrici (IEC) / Adaptations Pour Moteurs Electriques (IEC) / Acoplamientos Para Motores Eléctricos (IEC)

PL	IEC 63			IEC 71			IEC 80			IEC 90			IEC 100			IEC 112		
	L _T	Z	ØD	L _T	Z	ØD	L _T	Z	ØD	L _T	Z	ØD	L _T	Z	ØD	L _T	Z	ØD
35001	-	-	-	-	-	-	-	-	-	-	-	-	-	-	-	-	-	-
35002	-	-	-	-	-	-	-	-	-	-	-	-	-	-	-	-	-	-
35003	424.5	36	140	424.5	36	160	444.5	56	200	444.5	56	200	454.5	66	250	454.5	66	250
35004	485.5	-	-	485.5	-	-	505.5	-	-	505.5	-	-	515.5	-	-	515.5	-	-

PL	IEC 132			IEC 160			IEC 180			IEC 200			IEC 225			IEC 250		
	L _T	Z	ØD	L _T	Z	ØD	L _T	Z	ØD	L _T	Z	ØD	L _T	Z	ØD	L _T	Z	ØD
35001	-	-	-	380	150	-	380	150	-	380	150	400	369	139	450	369	139	550
35002	-	-	-	435	118	-	435	118	-	435	148	-	-	-	-	-	-	-
35003	488.5	100	300	527.5	139	350	527.5	139	350	-	-	-	-	-	-	-	-	-
35004	549.5	-	-	588.5	-	-	588.5	-	-	-	-	-	-	-	-	-	-	-

PL	IEC ~ Kg											
	63	71	80	90	100	112	132	160	180	200	225	250
35001	-	-	-	-	-	-	-	240	240	245	251	263
35002	-	-	-	-	-	-	-	267	267	277	-	-
35003	266	266	268	268	269	269	273	283	283	-	-	-
35004	274	274	276	276	277	277	281	291	291	-	-	-

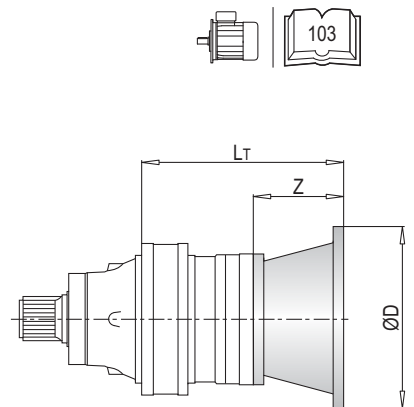

PL 35000 MS - Giriş Milleri / Input Shafts / Antriebswellen / Alberi Entrata / Arbres D'entree / Ejes De Entrada

PL	EL C 28				EL C 42				EML 42				EML 1"3/8 Z6				EM 65				EM 1"3/8 Z6			
	L _T	Z	L	Ød	L _T	Z	L	Ød	L _T	Z	L	Ød	L _T	Z	L	Ød	L _T	Z	L	Ød	L _T	Z	L	Ød
35002	-	-	-	-	-	-	-	-	-	-	-	-	-	-	-	-	438.5	-	-	-	438.5	-	-	-
35003	452.5	64	50	28	452.5	64	82	42	482.5	94	82	42	482.5	94	106	1"3/8	510	121.5	105	65	510	121.5	105	1"3/8
35004	513.5	-	-	-	513.5	-	-	-	543.5	-	-	-	543.5	-	-	-	-	-	-	-	-	-	-	-

PL	EP 65				ET 90			
	L _T	Z	L	Ød	L _T	Z	L	Ød
35002	470	-	-	-	488.5	171.5	170	90
35003	541.5	153	105	65	-	-	-	-
35004	-	-	-	-	-	-	-	-

PL	~ Kg							
	EL C 28	EL C 42	EML 42	EML 1"3/8 Z6	EM 65	EM 1"3/8 Z6	EP 65	ET 90
35002	-	-	-	-	262.0	262.0	271.0	293.0
35003	266.5	267.0	270.0	270.0	278.0	278.0	287.0	-
35004	274.5	275.0	278.0	278.0	-	-	-	-

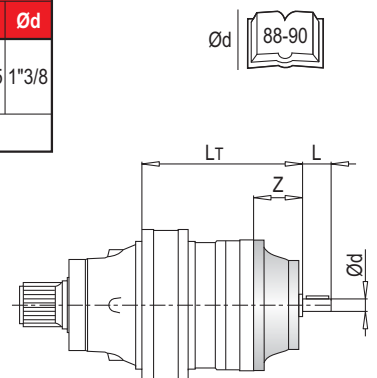

PL 35000 MS - Sonsuz Dişli Redüktör Adaptörleri (PMRV/PRV) / Worm Gearbox Adaptors (PMRV/PRV) / Anschluss Für Schneckengetriebe (PMRV/PRV) / Predisposizioni Per Riduttori A Vite Senza Fine (PMRV/PRV) / Adaptation Pour Reducteurs A Vis Sans Fin (PMRV/PRV) / Acoplamiento Para Reductores De Tornillo Sin Fin (PMRV/PRV)

PL	PMRV/PRV 050					PMRV/PRV 063					PMRV/PRV 075				
	Lm	l	h	MA	G	Lm	l	h	MA	G	Lm	l	h	MA	G
35002	-					-					-				
35003	510	50	110	60	80	519.5	63	135	72	95	498.5	75	161	86	112.5
35004	571					580.5					559.5				

PL	PMRV/PRV 090					PMRV/PRV 110					PMRV/PRV 130					
	Lm	l	h	MA	G	Lm	l	h	MA	G	Lm	l	h	MA	G	
35002	-					451	110	237.5	127.5	160	456.5	130	277.5	147.5	180	
35003	508.5	90	193	103	129.5	522.5					528					
35004	569.5															

PL	PMRV/PRV 150				
	Lm	l	h	MA	G
35002	473	150	320	170	210
35003	605.5				
35004					

PL	PMRV/PRV ~ Kg						
	050	063	075	090	110	130	150
35002	-	-	-	-	291	308	344
35003	269	272.5	275	280	307	324	360
35004	277	280.5	282	287	-	-	-

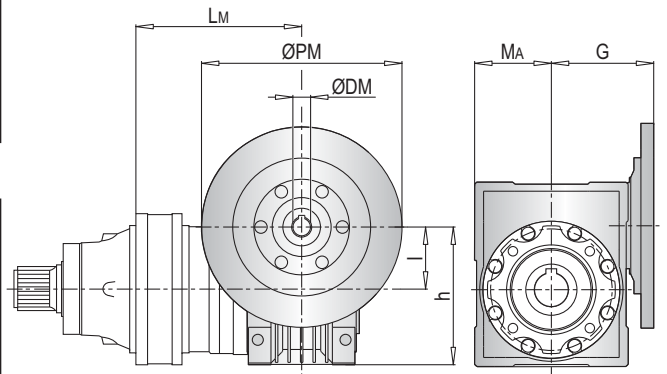

PLB 35000 MS - Elektrik Motor Adaptörleri (IEC) / Electric Motor Couplings (IEC) / Anbauvorrichtung Für Elektromotore (IEC) / Predisposizioni Per Motori Elettrici (IEC) / Adaptations Pour Moteurs Electriques (IEC) / Acoplamientos Para Motores Eléctricos (IEC)

PLB	IEC 80				IEC 90				IEC 100				IEC 112			
	A	LT	Z	ØD	A	LT	Z	ØD	A	LT	Z	ØD	A	LT	Z	ØD
35002	-				-				-				-			
35003	-				-				-				-			
35004	490	296	56	200	490	296	56	200	490	306	66	250	490	306	66	250

PLB	IEC 132				IEC 160				IEC 180				IEC 200			
	A	LT	Z	ØD	A	LT	Z	ØD	A	LT	Z	ØD	A	LT	Z	ØD
35002	-				295	433	118	350	295	433	118	350	295	463	148	400
35003	-				452				452							
35004	490	340	100	300	490	379	139									

PLB	IEC ~ Kg							
	80	90	100	112	132	160	180	200
35002	-	-	-	-	-	309	309	319
35003	-	-	-	-	-	368	368	-
35004	308	308	309	309	313	323	-	-

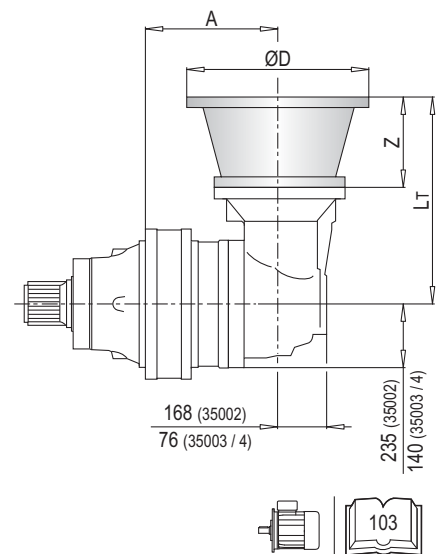

PLB 35000 MS - Giriş Milleri / Input Shafts / Antriebswellen / Alberi Entrada / Arbres D'entree / Ejes De Entrada

PLB	EL C 28					EL C 42					EML 42					EML 1"3/8 Z6					EM 65									
	A	LT	Z	L	Ød	A	LT	Z	L	Ød	A	LT	Z	L	Ød	A	LT	Z	L	Ød	A	LT	Z	L	Ød					
35002	-					-					-					-					295	436.5								
35003	-					-					-					-					452	361.5	121.5	105	65					
35004	490	304	64	50	28	490	304	64	82	42	490	334	94	82	42	490	334	94	106	1"3/8	490									

PLB	EM 1"3/8 Z6					EP 65					PLB	~ Kg						
	A	LT	Z	L	Ød	A	LT	Z	L	Ød		EL C 28	EL C 42	EML 42	EML 1"3/8 Z6	EM 65	EM 1"3/8 Z6	EP 65
35002	295	436.5				295	468				35002	-	-	-	-	304.0	304.0	313.0
35003	452	361.5	121.5	105	1"3/8	452	153	105	65		35003	-	-	-	363.0	363.0	372.0	
35004	490	361.5				490	393				35004	306.5	307.0	310.0	310.0	318.0	318.0	327.0

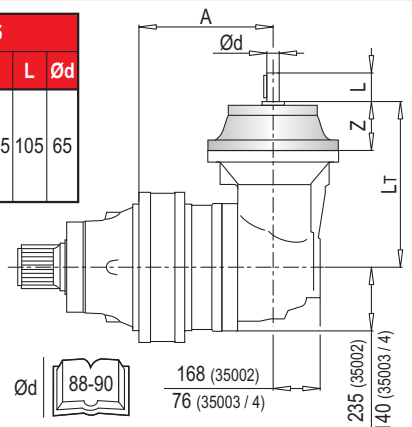

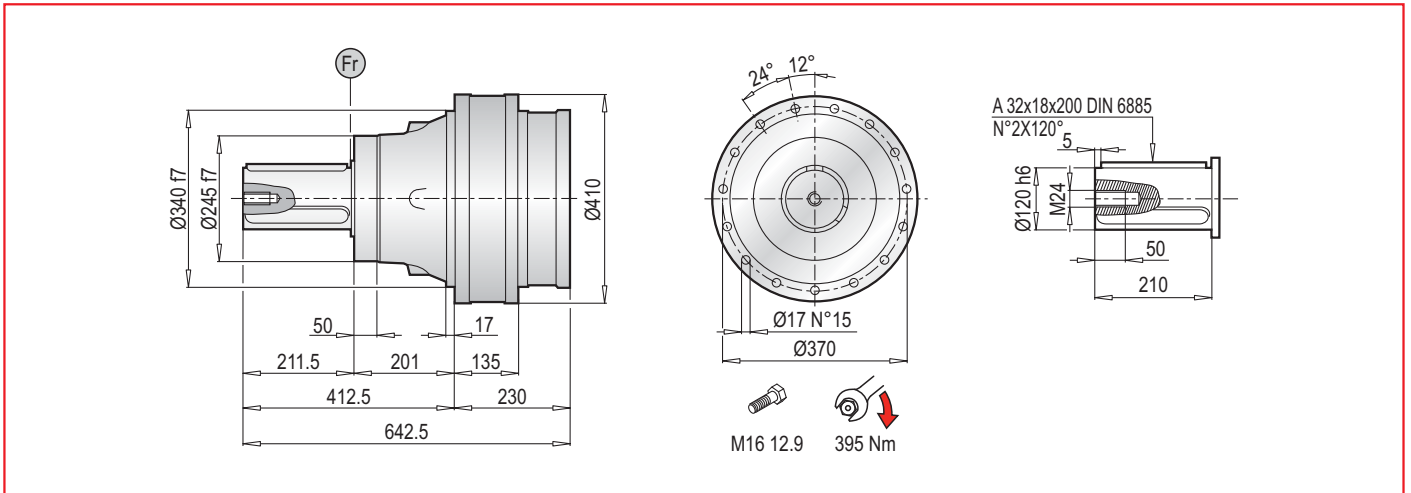

PL 35000 MC - Elektrik Motor Adaptörleri (IEC) / Electric Motor Couplings (IEC) / Anbauvorrichtung Für Elektromotore (IEC) / Predisposizioni Per Motori Elettrici (IEC) / Adaptations Pour Moteurs Electriques (IEC) / Acoplamientos Para Motores Eléctricos (IEC)

PL	IEC 63			IEC 71			IEC 80			IEC 90			IEC 100			IEC 112		
	L _T	Z	ØD	L _T	Z	ØD	L _T	Z	ØD	L _T	Z	ØD	L _T	Z	ØD	L _T	Z	ØD
35001	-	-	-	-	-	-	-	-	-	-	-	-	-	-	-	-	-	-
35002	-	-	-	-	-	-	-	-	-	-	-	-	-	-	-	-	-	-
35003	424.5	36	140	424.5	36	160	444.5	56	200	444.5	56	200	454.5	66	250	454.5	66	250
35004	485.5	-	-	485.5	-	-	505.5	-	-	505.5	-	-	515.5	-	-	515.5	-	-

PL	IEC 132			IEC 160			IEC 180			IEC 200			IEC 225			IEC 250		
	L _T	Z	ØD	L _T	Z	ØD	L _T	Z	ØD	L _T	Z	ØD	L _T	Z	ØD	L _T	Z	ØD
35001	-	-	-	380	150	-	380	150	-	380	150	400	369	139	450	369	139	550
35002	-	-	-	435	118	-	435	118	-	435	148	-	-	-	-	-	-	-
35003	488.5	100	300	527.5	139	350	527.5	139	350	-	-	-	-	-	-	-	-	-
35004	549.5	-	-	588.5	-	-	588.5	-	-	-	-	-	-	-	-	-	-	-

PL	IEC ~ Kg											
	63	71	80	90	100	112	132	160	180	200	225	250
35001	-	-	-	-	-	-	-	240	240	245	251	263
35002	-	-	-	-	-	-	-	267	267	277	-	-
35003	266	266	268	268	269	269	273	283	283	-	-	-
35004	274	274	276	276	277	277	281	291	291	-	-	-

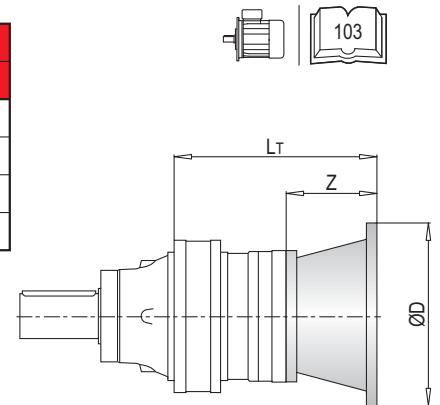

PL 35000 MC - Giriş Milleri / Input Shafts / Antriebswellen / Alberi Entrata / Arbres D'entree / Ejes De Entrada

PL	EL C 28				EL C 42				EML 42				EML 1"3/8 Z6				EM 65				EM 1"3/8 Z6				
	L _T	Z	L	Ød	L _T	Z	L	Ød	L _T	Z	L	Ød	L _T	Z	L	Ød	L _T	Z	L	Ød	L _T	Z	L	Ød	
35002	-	-	-	-	-	-	-	-	-	-	-	-	-	-	-	-	438.5	121.5	105	65	438.5	121.5	105	1"3/8	-
35003	452.5	64	50	28	452.5	64	82	42	482.5	94	82	42	482.5	94	106	1"3/8	510	-	-	510	-	-	-	-	
35004	513.5	-	-	-	513.5	-	-	-	543.5	-	-	-	543.5	-	-	-	-	-	-	-	-	-	-	-	

PL	EP 65				ET 90				PL	~ Kg							
	L _T	Z	L	Ød	L _T	Z	L	Ød		EL C 28	EL C 42	EML 42	EML 1"3/8 Z6	EM 65	EM 1"3/8 Z6	EP 65	ET 90
35002	470	-	-	-	488.5	171.5	170	90	35002	-	-	-	-	262.0	262.0	271.0	293.0
35003	541.5	153	105	65	-	-	-	-	35003	266.5	267.0	270.0	270.0	278.0	278.0	287.0	-
35004	-	-	-	-	-	-	-	-	35004	274.5	275.0	278.0	278.0	-	-	-	-

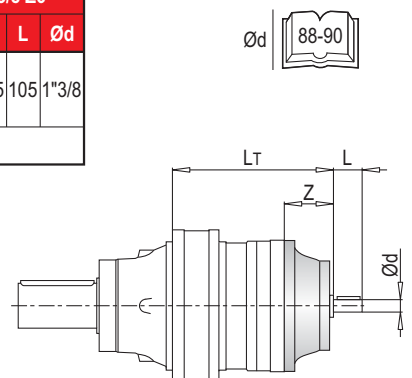

PL 35000 MC - Sonsuz Dişli Redüktör Adaptörleri (PMRV/PRV) / Worm Gearbox Adaptors (PMRV/PRV) / Anschluss Für Schneckengetriebe (PMRV/PRV) / Predisposizioni Per Riduttori A Vite Senza Fine (PMRV/PRV) / Adaptation Pour Reducteurs A Vis Sans Fin (PMRV/PRV) / Acoplamiento Para Reductores De Tornillo Sin Fin (PMRV/PRV)

PL	PMRV/PRV 050					PMRV/PRV 063					PMRV/PRV 075				
	Lm	l	h	MA	G	Lm	l	h	MA	G	Lm	l	h	MA	G
35002	-														
35003	510	50	110	60	80	519.5	63	135	72	95	498.5	75	161	86	112.5
35004	571					580.5					559.5				

PL	PMRV/PRV 090					PMRV/PRV 110					PMRV/PRV 130				
	Lm	l	h	MA	G	Lm	l	h	MA	G	Lm	l	h	MA	G
35002	-														
35003	508.5	90	193	103	129.5	522.5	110	237.5	127.5	160	456.5	130	277.5	147.5	180
35004	569.5														

PL	PMRV/PRV 150				
	Lm	l	h	MA	G
35002	473	150	320	170	210
35003	605.5				
35004	-				

PL	PMRV/PRV ~ Kg						
	050	063	075	090	110	130	150
35002	-	-	-	-	291	308	344
35003	269	272.5	275	280	307	324	360
35004	277	280.5	282	287	-	-	-

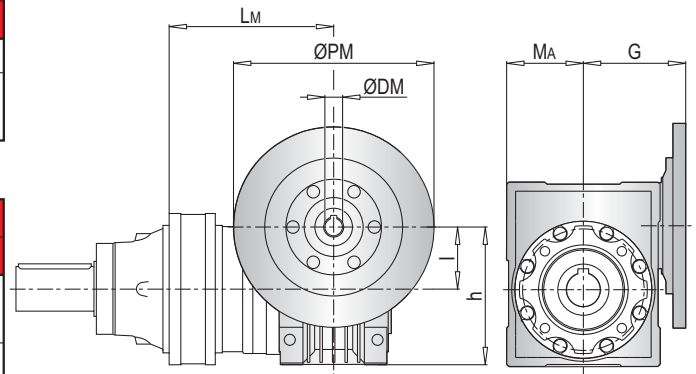

PLB 35000 MC - Elektrik Motor Adaptörleri (IEC) / Electric Motor Couplings (IEC) / Anbauvorrichtung Für Elektromotore (IEC) / Predisposizioni Per Motori Elettrici (IEC) / Adaptations Pour Moteurs Electriques (IEC) / Acoplamientos Para Motores Eléctricos (IEC)

PLB	IEC 80				IEC 90				IEC 100				IEC 112			
	A	LT	Z	ØD	A	LT	Z	ØD	A	LT	Z	ØD	A	LT	Z	ØD
35002	-															
35003	-															
35004	490	296	56	200	490	296	56	200	490	306	66	250	490	306	66	250

PLB	IEC 132				IEC 160				IEC 180				IEC 200			
	A	LT	Z	ØD	A	LT	Z	ØD	A	LT	Z	ØD	A	LT	Z	ØD
35002	-				295	433	118	350	295	433	118	350	-			
35003	-				452				452				-			
35004	490	340	100	300	490	379	139						-			

PLB	IEC ~ Kg							
	80	90	100	112	132	160	180	200
35002	-	-	-	-	-	309	309	319
35003	-	-	-	-	-	368	368	-
35004	308	308	309	309	313	323	-	-

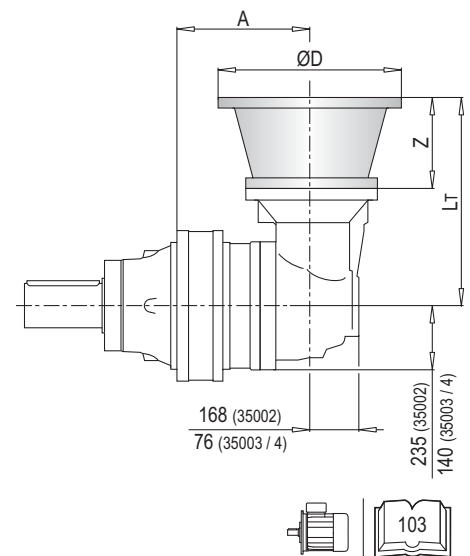

PLB 35000 MC - Giriş Milleri / Input Shafts / Antriebswellen / Alberi Entrada / Arbres D'entree / Ejes De Entrada

PLB	EL C 28					EL C 42					EML 42					EML 1"3/8 Z6					EM 65										
	A	LT	Z	L	Ød	A	LT	Z	L	Ød	A	LT	Z	L	Ød	A	LT	Z	L	Ød	A	LT	Z	L	Ød						
35002	-																														
35003	-																														
35004	490	304	64	50	28	490	304	64	82	42	490	334	94	82	42	490	334	94	106	1"3/8	490	295	436.5				452	361.5	121.5	105	65

PLB	EM 1"3/8 Z6					EP 65				
	A	LT	Z	L	Ød	A	LT	Z	L	Ød
35002	295	436.5				295	468			
35003	452	361.5	121.5	105	1"3/8	452	393	153	105	65
35004	490					490				

PLB	~ Kg						
	EL C 28	EL C 42	EML 42	EML 1"3/8 Z6	EM 65	EM 1"3/8 Z6	EP 65
35002	-	-	-	-	304.0	304.0	313.0
35003	-	-	-	-	363.0	363.0	372.0
35004	306.5	307.0	310.0	310.0	318.0	318.0	327.0

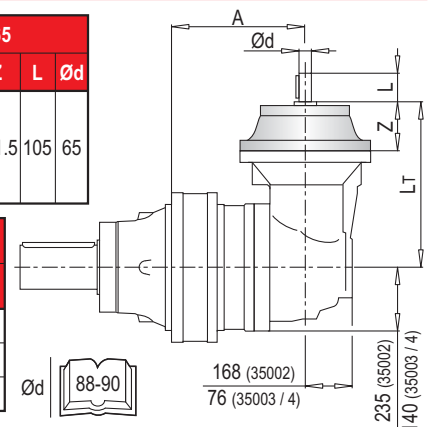

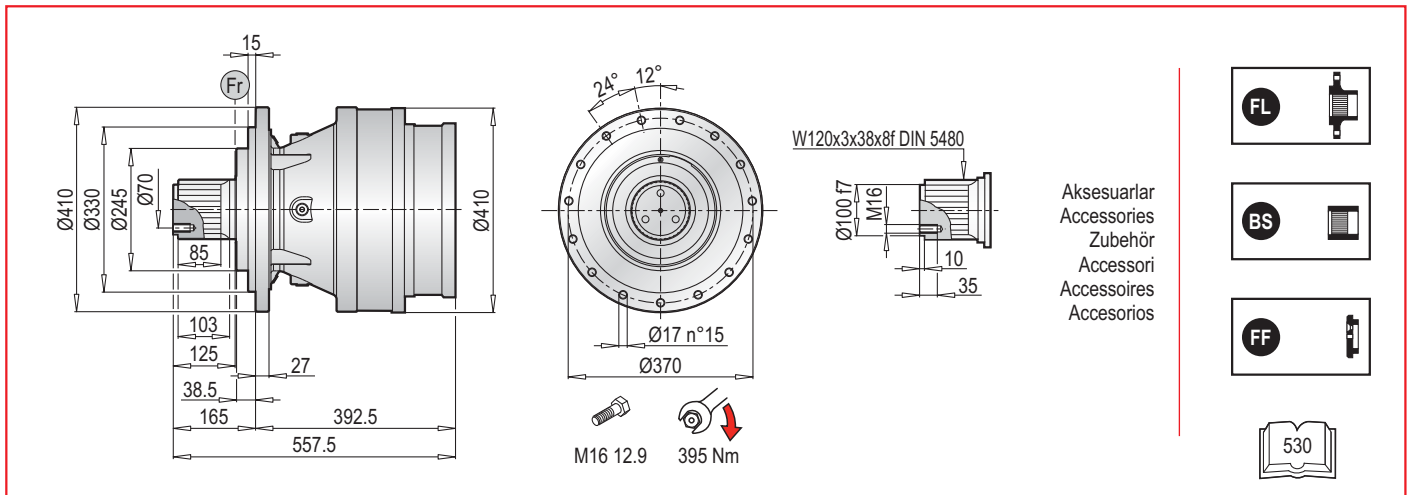

PL 35000 MSF - Elektrik Motor Adaptörleri (IEC) / Electric Motor Couplings (IEC) / Anbauvorrichtung Für Elektromotore (IEC) / Predisposizioni Per Motori Elettrici (IEC) / Adaptations Pour Moteurs Electriques (IEC) / Acoplamientos Para Motores Eléctricos (IEC)

PL	IEC 63			IEC 71			IEC 80			IEC 90			IEC 100			IEC 112		
	L _T	Z	ØD	L _T	Z	ØD	L _T	Z	ØD	L _T	Z	ØD	L _T	Z	ØD	L _T	Z	ØD
35001	-	-	-	-	-	-	-	-	-	-	-	-	-	-	-	-	-	-
35002	-	-	-	-	-	-	-	-	-	-	-	-	-	-	-	-	-	-
35003	587	36	140	587	36	160	607	56	200	607	56	200	617	66	250	617	66	250
35004	648	-	-	648	-	-	668	-	-	668	-	-	678	-	-	678	-	-

PL	IEC 132			IEC 160			IEC 180			IEC 200			IEC 225			IEC 250		
	L _T	Z	ØD	L _T	Z	ØD	L _T	Z	ØD	L _T	Z	ØD	L _T	Z	ØD	L _T	Z	ØD
35001	-	-	-	540.5	148	-	540.5	148	-	540.5	148	400	531.5	139	450	539.5	147	550
35002	-	-	-	597.5	118	350	597.5	118	350	627.5	-	-	-	-	-	-	-	-
35003	651	100	300	690	139	-	690	139	-	-	-	-	-	-	-	-	-	-
35004	712	-	-	751	-	-	751	-	-	-	-	-	-	-	-	-	-	-

PL	IEC ~ Kg											
	63	71	80	90	100	112	132	160	180	200	225	250
35001	-	-	-	-	-	-	-	262	262	267	273	285
35002	-	-	-	-	-	-	-	289	289	299	-	-
35003	288	288	290	290	291	291	295	305	305	-	-	-
35004	296	296	298	298	299	299	303	313	313	-	-	-

PL 35000 MSF - Giriş Milleri / Input Shafts / Antriebswellen / Alberi Entrata / Arbres D'entree / Ejes De Entrada

PL	EL C 28				EL C 42				EML 42				EML 1"3/8 Z6				EM 65				EM 1"3/8 Z6			
	L _T	Z	L	Ød	L _T	Z	L	Ød	L _T	Z	L	Ød	L _T	Z	L	Ød	L _T	Z	L	Ød	L _T	Z	L	Ød
35002	-	-	-	-	-	-	-	-	-	-	-	-	-	-	-	-	601	121.5	105	65	601	121.5	105	1"3/8
35003	615	64	50	28	615	64	82	42	645	94	82	42	645	94	106	1"3/8	686	-	-	-	686	-	-	-
35004	676	-	-	-	676	-	-	-	706	-	-	-	706	-	-	-	-	-	-	-	-	-	-	-

PL	EP 65				ET 90			
	L _T	Z	L	Ød	L _T	Z	L	Ød
35002	632.5	-	-	-	684.5	174	170	90
35003	717.5	153	105	65	-	-	-	-
35004	-	-	-	-	-	-	-	-

PL	~ Kg							
	EL C 28	EL C 42	EML 42	EML 1"3/8 Z6	EM 65	EM 1"3/8 Z6	EP 65	ET 90
35002	-	-	-	-	284	284	293	315
35003	288.5	289	292	292	300	300	309	-
35004	296.5	297	300	300	-	-	-	-

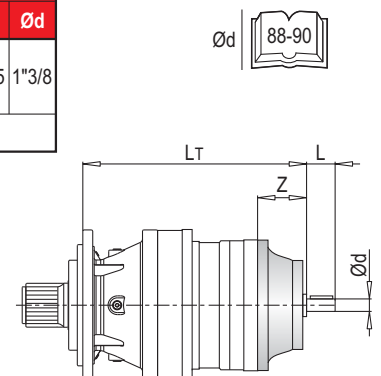
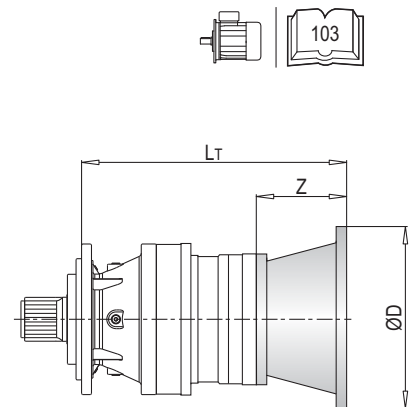

PL 35000 MSF - Sonsuz Dişli Redüktör Adaptörleri (PMRV/PRV) / Worm Gearbox Adaptors (PMRV/PRV) / Anschluss Für Schneckengetriebe (PMRV/PRV) / Predisposizioni Per Riduttori A Vite Senza Fine (PMRV/PRV) / Adaptation Pour Reducteurs A Vis Sans Fin (PMRV/PRV) / Acoplamiento Para Reductores De Tornillo Sin Fin (PMRV/PRV)

PL	PMRV/PRV 050					PMRV/PRV 063					PMRV/PRV 075				
	Lm	l	h	MA	G	Lm	l	h	MA	G	Lm	l	h	MA	G
35002	-					-					-				
35003	676.5	50	110	60	80	686	63	135	72	95	665	75	161	86	112.5
35004	737.5					747					726				

PL	PMRV/PRV 090					PMRV/PRV 110					PMRV/PRV 130				
	Lm	l	h	MA	G	Lm	l	h	MA	G	Lm	l	h	MA	G
35002	-					617.5	110	237.5	127.5	160	625	130	277.5	147.5	180
35003	675	90	193	103	129.5	702.5					710				
35004	736					-					-				

PL	PMRV/PRV 150				
	Lm	l	h	MA	G
35002	639.5				
35003	724.5	150	320	170	210
35004	-				

PL	PMRV/PRV ~ Kg						
	050	063	075	090	110	130	150
35002	-	-	-	-	313	330	366
35003	291	294.5	297	302	329	346	382
35004	299	306.5	304	309	-	-	-

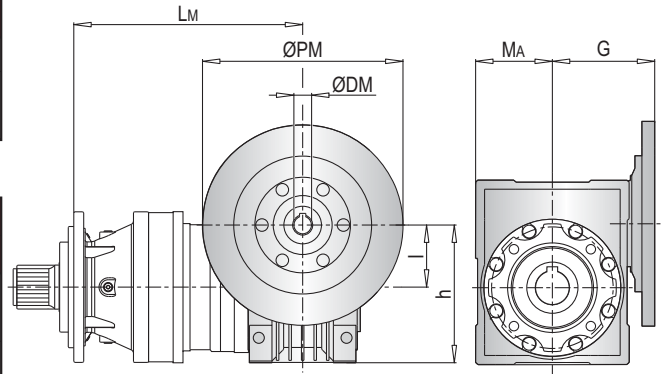

PLB 35000 MSF - Elektrik Motor Adaptörleri (IEC) / Electric Motor Couplings (IEC) / Anbauvorrichtung Für Elektromotore (IEC) / Predisposizioni Per Motori Elettrici (IEC) / Adaptations Pour Moteurs Electriques (IEC) / Acoplamientos Para Motores Eléctricos (IEC)

PLB	IEC 80				IEC 90				IEC 100				IEC 112			
	A	Lt	Z	ØD	A	Lt	Z	ØD	A	Lt	Z	ØD	A	Lt	Z	ØD
35002	-				-				-				-			
35003	-				-				-				-			
35004	652.5	296	56	200	652.5	296	56	200	652.5	306	66	250	652.5	306	66	250

PLB	IEC 132				IEC 160				IEC 180				IEC 200			
	A	Lt	Z	ØD	A	Lt	Z	ØD	A	Lt	Z	ØD	A	Lt	Z	ØD
35002	-				457.5	433	118	350	457.5	433	118	350	457.5	463	148	400
35003	-				614.5				614.5							
35004	652.5	340	100	300	652.5	379	139									

PLB	IEC ~ Kg							
	80	90	100	112	132	160	180	200
35002	-	-	-	-	-	331	331	341
35003	-	-	-	-	-	390	390	-
35004	330	330	331	331	335	345	-	-

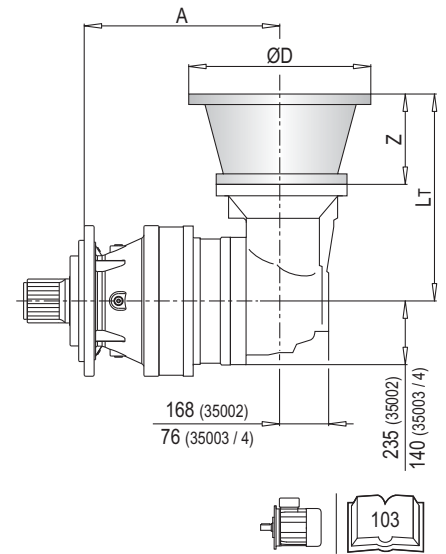

PLB 35000 MSF - Giriş Milleri / Input Shafts / Antriebswellen / Alberi Entrata / Arbres D'entree / Ejes De Entrada

PLB	EL C 28					EL C 42					EML 42					EML 1"3/8 Z6					EM 65									
	A	Lt	Z	L	Ød	A	Lt	Z	L	Ød	A	Lt	Z	L	Ød	A	Lt	Z	L	Ød	A	Lt	Z	L	Ød					
35002	-					-					-					-					457.5	436.5	121.5	105	65					
35003	-					-					-					-					614.5									
35004	652.5	304	64	50	28	652.5	304	64	82	42	652.5	334	94	82	42	652.5	334	94	106	1"3/8	652.5	377.5								

PLB	EM 1"3/8 Z6					EP 65					PLB	~ Kg						
	A	Lt	Z	L	Ød	A	Lt	Z	L	Ød		EL C 28	EL C 42	EML 42	EML 1"3/8 Z6	EM 65	EM 1"3/8 Z6	EP 65
35002	457.5	436.5	121.5	105	1"3/8	457.5	468				35002	-	-	-	-	326	326	335
35003	614.5					614.5	153	105	65		35003	-	-	-	-	385	385	394
35004	652.5	377.5				652.5	409				35004	328.5	329	332	332	340	340	349

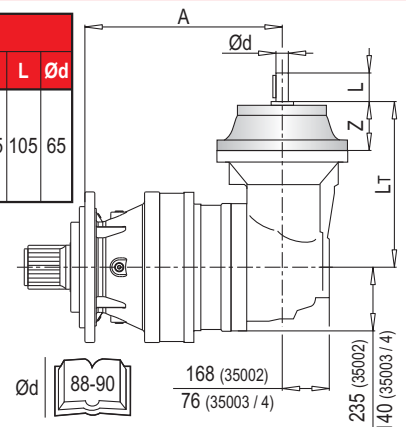

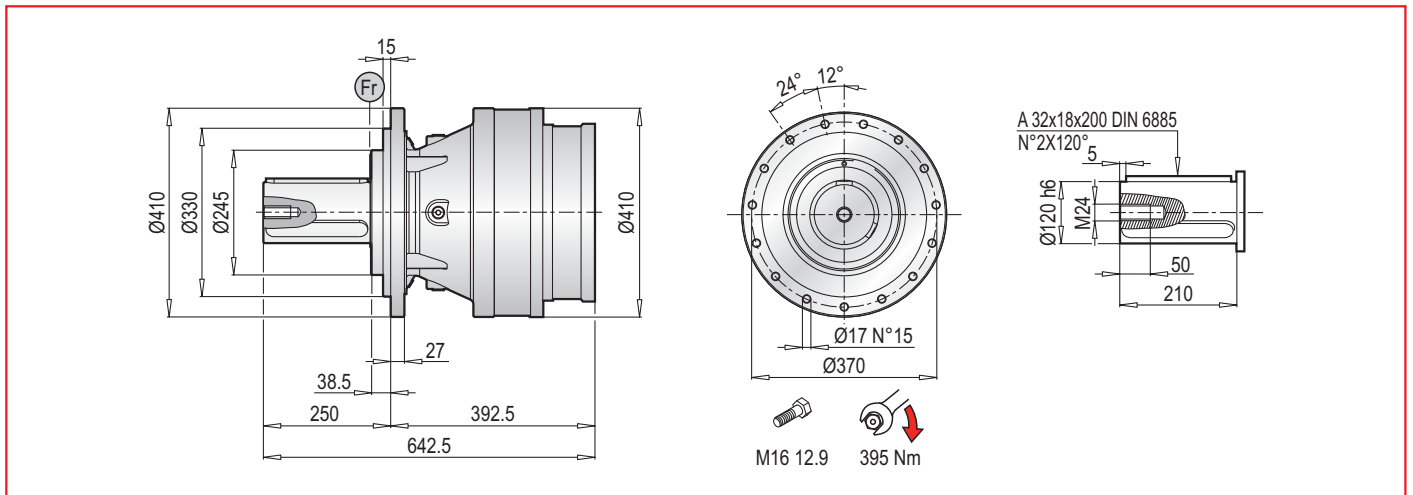

PL 35000 MCF - Elektrik Motor Adaptörleri (IEC) / Electric Motor Couplings (IEC) / Anbauvorrichtung Für Elektromotore (IEC) / Predisposizioni Per Motori Elettrici (IEC) / Adaptations Pour Moteurs Electriques (IEC) / Acoplamientos Para Motores Eléctricos (IEC)

PL	IEC 63			IEC 71			IEC 80			IEC 90			IEC 100			IEC 112			
	L _T	Z	ØD	L _T	Z	ØD	L _T	Z	ØD	L _T	Z	ØD	L _T	Z	ØD	L _T	Z	ØD	
35001	-	-	-	-	-	-	-	-	-	-	-	-	-	-	-	-	-	-	-
35002	-	-	-	-	-	-	-	-	-	-	-	-	-	-	-	-	-	-	-
35003	587	36	140	587	36	160	607	56	200	607	56	200	617	66	250	617	66	250	-
35004	648	-	-	648	-	-	668	-	-	668	-	-	678	-	-	678	-	-	-

PL	IEC 132			IEC 160			IEC 180			IEC 200			IEC 225			IEC 250			
	L _T	Z	ØD	L _T	Z	ØD	L _T	Z	ØD	L _T	Z	ØD	L _T	Z	ØD	L _T	Z	ØD	
35001	-	-	-	540.5	148	-	540.5	148	-	540.5	148	400	531.5	139	450	539.5	147	550	-
35002	-	-	-	597.5	118	-	597.5	118	-	627.5	-	-	-	-	-	-	-	-	-
35003	651	100	300	690	139	350	690	139	350	-	-	-	-	-	-	-	-	-	-
35004	712	-	-	751	-	-	751	-	-	-	-	-	-	-	-	-	-	-	-

PL	IEC ~ Kg											
	63	71	80	90	100	112	132	160	180	200	225	250
35001	-	-	-	-	-	-	-	262	262	267	273	285
35002	-	-	-	-	-	-	-	289	289	299	-	-
35003	288	288	290	290	291	291	295	305	305	-	-	-
35004	296	296	298	298	299	299	303	313	313	-	-	-

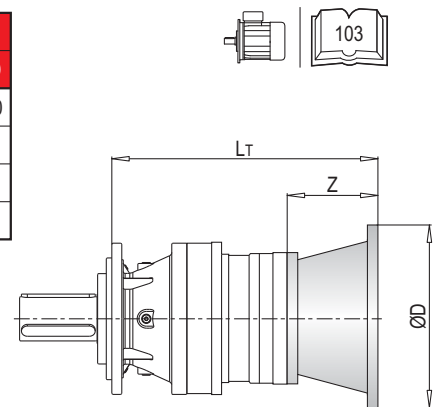

PL 35000 MCF - Giriş Milleri / Input Shafts / Antriebswellen / Alberi Entrata / Arbres D'entree / Ejes De Entrada

PL	EL C 28				EL C 42				EML 42				EML 1"3/8 Z6				EM 65				EM 1"3/8 Z6			
	L _T	Z	L	Ød	L _T	Z	L	Ød	L _T	Z	L	Ød	L _T	Z	L	Ød	L _T	Z	L	Ød	L _T	Z	L	Ød
35002	-	-	-	-	-	-	-	-	-	-	-	-	-	-	-	-	601	121.5	105	65	601	121.5	105	1"3/8
35003	615	64	50	28	615	64	82	42	645	94	82	42	645	94	106	1"3/8	686	-	-	686	-	-	-	-
35004	676	-	-	-	676	-	-	-	706	-	-	-	706	-	-	-	-	-	-	-	-	-	-	-

PL	EP 65				ET 90			
	L _T	Z	L	Ød	L _T	Z	L	Ød
35002	632.5	153	105	65	684.5	174	170	90
35003	717.5	-	-	-	-	-	-	-
35004	-	-	-	-	-	-	-	-

PL	~ Kg							
	EL C 28	EL C 42	EML 42	EML 1"3/8 Z6	EM 65	EM 1"3/8 Z6	EP 65	ET 90
35002	-	-	-	-	284	284	293	315
35003	288.5	289	292	292	300	300	309	-
35004	296.5	297	300	300	-	-	-	-

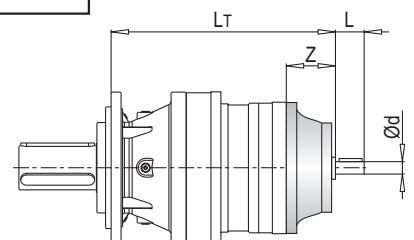

PL 35000 MCF - Sonsuz Dişli Redüktör Adaptörleri (PMRV/PRV) / Worm Gearbox Adaptors (PMRV/PRV) / Anschluss Für Schneckengetriebe (PMRV/PRV) / Predisposizioni Per Riduttori A Vite Senza Fine (PMRV/PRV) / Adaptation Pour Reducteurs A Vis Sans Fin (PMRV/PRV) / Acoplamiento Para Reductores De Tornillo Sin Fin (PMRV/PRV)

PL	PMRV/PRV 050					PMRV/PRV 063					PMRV/PRV 075				
	LM	l	h	MA	G	LM	l	h	MA	G	LM	l	h	MA	G
35002	-					-					-				
35003	676.5	50	110	60	80	686	63	135	72	95	665	75	161	86	112.5
35004	737.5					747					726				

PL	PMRV/PRV 090					PMRV/PRV 110					PMRV/PRV 130				
	LM	l	h	MA	G	LM	l	h	MA	G	LM	l	h	MA	G
35002	-					617.5	110	237.5	127.5	160	625	130	277.5	147.5	180
35003	675	90	193	103	129.5	702.5				710					
35004	736														

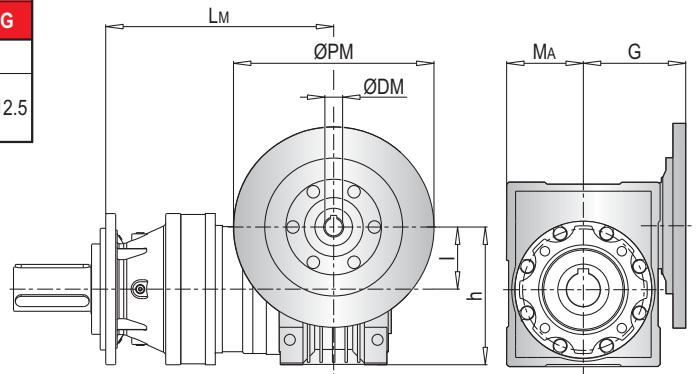

PL	PMRV/PRV 150				
	LM	l	h	MA	G
35002	639.5				
35003	724.5	150	320	170	210
35004					

PL	PMRV/PRV ~ Kg						
	050	063	075	090	110	130	150
35002	-	-	-	-	313	330	366
35003	291	294.5	297	302	329	346	382
35004	299	306.5	304	309	-	-	-



PLB 35000 MCF - Elektrik Motor Adaptörleri (IEC) / Electric Motor Couplings (IEC) / Anbauvorrichtung Für Elektromotore (IEC) / Predisposizioni Per Motori Elettrici (IEC) / Adaptations Pour Moteurs Electriques (IEC) / Acoplamientos Para Motores Eléctricos (IEC)

PLB	IEC 80				IEC 90				IEC 100				IEC 112			
	A	LT	Z	ØD	A	LT	Z	ØD	A	LT	Z	ØD	A	LT	Z	ØD
35002	-				-				-				-			
35003	-				-				-				-			
35004	652.5	296	56	200	652.5	296	56	200	652.5	306	66	250	652.5	306	66	250

PLB	IEC 132				IEC 160				IEC 180				IEC 200			
	A	LT	Z	ØD	A	LT	Z	ØD	A	LT	Z	ØD	A	LT	Z	ØD
35002	-				457.5	433	118	350	457.5	433	118	350	457.5	463	148	400
35003	-				614.5				614.5							
35004	652.5	340	100	300	652.5	379	139									

PLB	IEC ~ Kg							
	80	90	100	112	132	160	180	200
35002	-	-	-	-	-	331	331	341
35003	-	-	-	-	-	390	390	-
35004	330	330	331	331	335	345	-	-

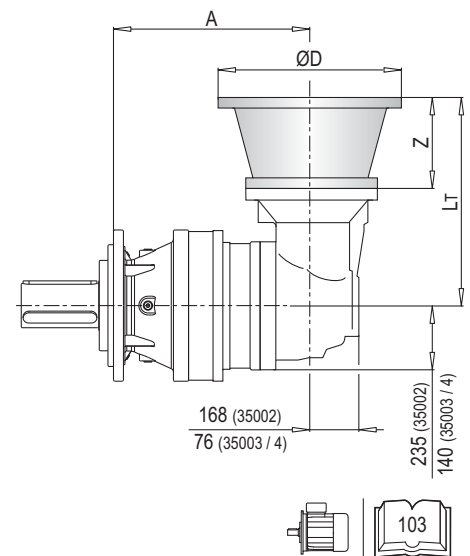

PLB 35000 MCF - Giriş Milleri / Input Shafts / Antriebswellen / Alberi Entrata / Arbres D'entree / Ejes De Entrada

PLB	EL C 28					EL C 42					EML 42					EML 1"3/8 Z6					EM 65								
	A	LT	Z	L	Ød	A	LT	Z	L	Ød	A	LT	Z	L	Ød	A	LT	Z	L	Ød	A	LT	Z	L	Ød				
35002	-					-					-					-					457.5	436.5	121.5	105	65				
35003	-					-					-					-					614.5								
35004	652.5	304	64	50	28	652.5	304	64	82	42	652.5	334	94	82	42	652.5	334	94	106	1"3/8	652.5	377.5							

PLB	EM 1"3/8 Z6					EP 65					PLB	~ Kg						
	A	LT	Z	L	Ød	A	LT	Z	L	Ød		EL C 28	EL C 42	EML 42	EML 1"3/8 Z6	EM 65	EM 1"3/8 Z6	EP 65
35002	457.5	436.5	121.5	105	1"3/8	457.5	468	153	105	65	35002	-	-	-	-	326	326	335
35003	614.5					614.5					35003	-	-	-	-	385	385	394
35004	652.5	377.5				652.5	409				35004	328.5	329	332	332	340	340	349

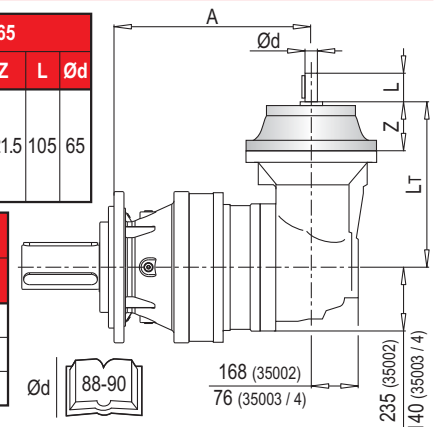

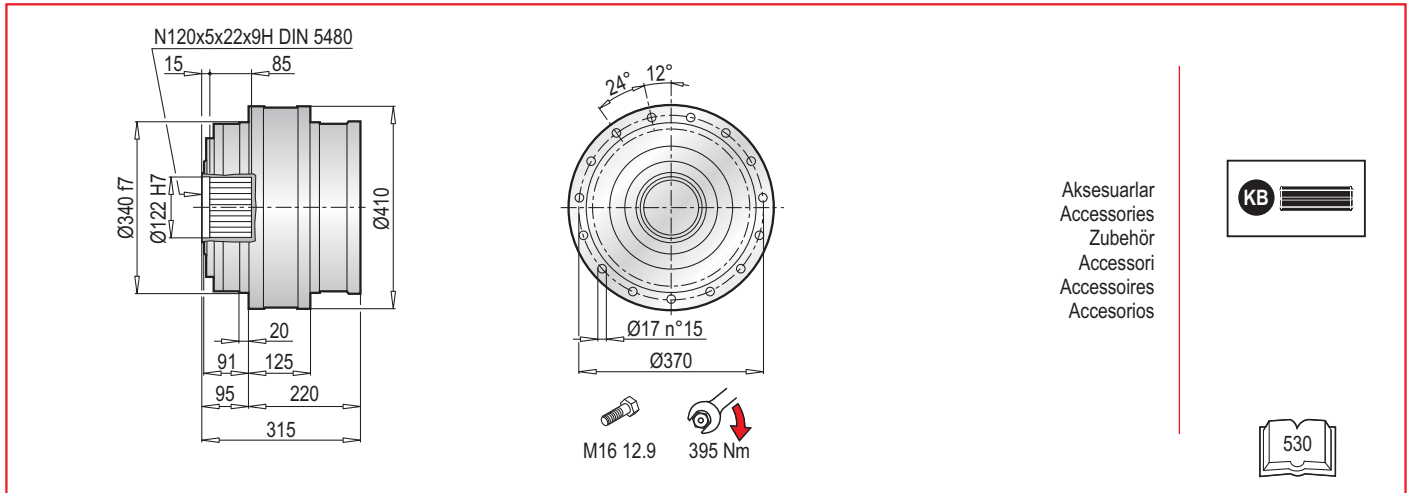

PL 35000 F - Elektrik Motor Adaptörleri (IEC) / Electric Motor Couplings (IEC) / Anbauvorrichtung Für Elektromotore (IEC) / Predisposizioni Per Motori Elettrici (IEC) / Adaptations Pour Moteurs Electriques (IEC) / Acoplamientos Para Motores Eléctricos (IEC)

PL	IEC 63			IEC 71			IEC 80			IEC 90			IEC 100			IEC 112		
	L _T	Z	ØD	L _T	Z	ØD	L _T	Z	ØD	L _T	Z	ØD	L _T	Z	ØD	L _T	Z	ØD
35001	-	-	-	-	-	-	-	-	-	-	-	-	-	-	-	-	-	-
35002	-	-	-	-	-	-	-	-	-	-	-	-	-	-	-	-	-	-
35003	414.5	36	140	414.5	36	160	434.5	56	200	434.5	56	200	444.5	66	250	444.5	66	250
35004	475.5	-	-	475.5	-	-	495.5	-	-	495.5	-	-	505.5	-	-	505.5	-	-

PL	IEC 132			IEC 160			IEC 180			IEC 200			IEC 225			IEC 250		
	L _T	Z	ØD	L _T	Z	ØD	L _T	Z	ØD	L _T	Z	ØD	L _T	Z	ØD	L _T	Z	ØD
35001	-	-	-	370	150	350	370	150	350	370	150	400	359	139	450	359	139	550
35002	-	-	-	425	118	350	425	118	350	455	148	400	-	-	-	-	-	-
35003	478.5	100	300	517.5	139	350	517.5	139	350	-	-	-	-	-	-	-	-	-
35004	539.5	-	-	578.5	-	-	583.5	-	-	-	-	-	-	-	-	-	-	-

PL	IEC ~ Kg											
	63	71	80	90	100	112	132	160	180	200	225	250
35001	-	-	-	-	-	-	-	204	204	209	215	227
35002	-	-	-	-	-	-	-	231	231	241	-	-
35003	230	230	232	232	233	233	237	247	247	-	-	-
35004	238	238	240	240	241	241	245	255	255	-	-	-

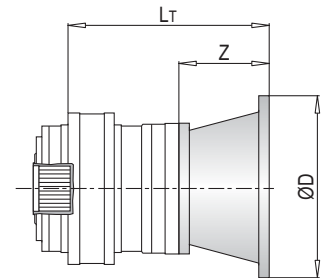

PL 35000 F - Giriş Milleri / Input Shafts / Antriebswellen / Alberi Entrata / Arbres D'entree / Ejes De Entrada

PL	EL C 28				EL C 42				EML 42				EML 1"3/8 Z6				EM 65				EM 1"3/8 Z6			
	L _T	Z	L	Ød	L _T	Z	L	Ød	L _T	Z	L	Ød	L _T	Z	L	Ød	L _T	Z	L	Ød	L _T	Z	L	Ød
35002	-	-	-	-	-	-	-	-	-	-	-	-	-	-	-	-	428.5	121.5	105	65	428.5	121.5	105	1"3/8
35003	442.5	64	50	28	442.5	64	82	42	472.5	94	82	42	472.5	94	106	1"3/8	500	-	-	-	500	-	-	-
35004	503.5	-	-	-	503.5	-	-	-	533.5	-	-	-	533.5	-	-	-	-	-	-	-	-	-	-	-

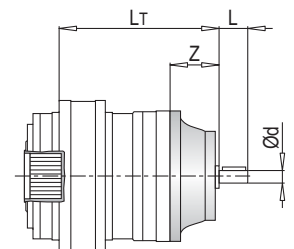

PL	EP 65				ET 90			
	L _T	Z	L	Ød	L _T	Z	L	Ød
35002	460	153	105	65	478.5	171.5	170	90
35003	531.5	-	-	-	-	-	-	-
35004	-	-	-	-	-	-	-	-

PL	~ Kg							
	EL C 28	EL C 42	EML 42	EML 1"3/8 Z6	EM 65	EM 1"3/8 Z6	EP 65	ET 90
35002	-	-	-	-	226.0	226.0	235.0	257.0
35003	230.5	231.0	234.0	234.0	242.0	242.0	251.0	-
35004	238.5	239.0	242.0	242.0	-	-	-	-

PL 35000 F - Sonsuz Dişli Redüktör Adaptörleri (PMRV/PRV) / Worm Gearbox Adaptors (PMRV/PRV) / Anschluss Für Schneckengetriebe (PMRV/PRV) / Predisposizioni Per Riduttori A Vite Senza Fine (PMRV/PRV) / Adaptation Pour Reducteurs A Vis Sans Fin (PMRV/PRV) / Acoplamiento Para Reductores De Tornillo Sin Fin (PMRV/PRV)

PL	PMRV/PRV 050					PMRV/PRV 063					PMRV/PRV 075				
	Lm	l	h	MA	G	Lm	l	h	MA	G	Lm	l	h	MA	G
35002	-					-					-				
35003	500	50	110	60	80	509.5	63	135	72	95	488.5	75	161	86	112.5
35004	561					570.5					549.5				

PL	PMRV/PRV 090					PMRV/PRV 110					PMRV/PRV 130				
	Lm	l	h	MA	G	Lm	l	h	MA	G	Lm	l	h	MA	G
35002	-					441	110	237.5	127.5	160	446.5	130	277.5	147.5	180
35003	498.5	90	193	103	129.5	512.5					518				
35004	559.5														

PL	PMRV/PRV 150				
	Lm	l	h	MA	G
35002	463				
35003	534.5	150	320	170	210
35004					

PL	PMRV/PRV ~ Kg						
	050	063	075	090	110	130	150
35002	-	-	-	-	255	272	308
35003	233	236.5	239	244	271	288	324
35004	241	244.5	247	252	-	-	-

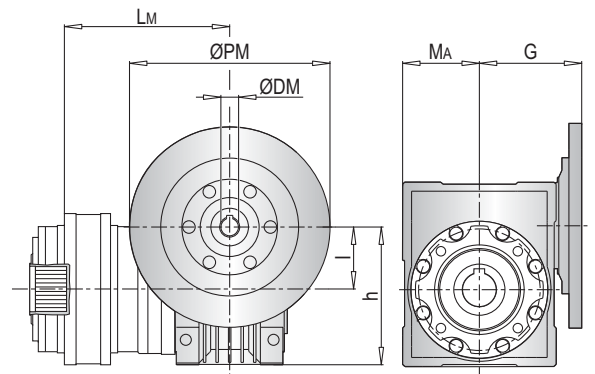

PLB 35000 F - Elektrik Motor Adaptörleri (IEC) / Electric Motor Couplings (IEC) / Anbauvorrichtung Für Elektromotore (IEC) / Predisposizioni Per Motori Elettrici (IEC) / Adaptations Pour Moteurs Electriques (IEC) / Acoplamientos Para Motores Eléctricos (IEC)

PLB	IEC 80				IEC 90				IEC 100				IEC 112			
	A	LT	Z	ØD	A	LT	Z	ØD	A	LT	Z	ØD	A	LT	Z	ØD
35002	-				-				-				-			
35003	-				-				-				-			
35004	480	296	56	200	480	296	56	200	480	306	66	250	480	306	66	250

PLB	IEC 132				IEC 160				IEC 180				IEC 200			
	A	LT	Z	ØD	A	LT	Z	ØD	A	LT	Z	ØD	A	LT	Z	ØD
35002	-				285	433	118	350	285	433	118	350	285	463	148	400
35003	-				442				442							
35004	480	340	100	300	480	379	139									

PLB	IEC ~ Kg								
	80	90	100	112	132	160	180	200	
35002	-	-	-	-	-	272	272	282	
35003	-	-	-	-	-	331	331	-	
35004	272	272	273	273	277	287	-	-	

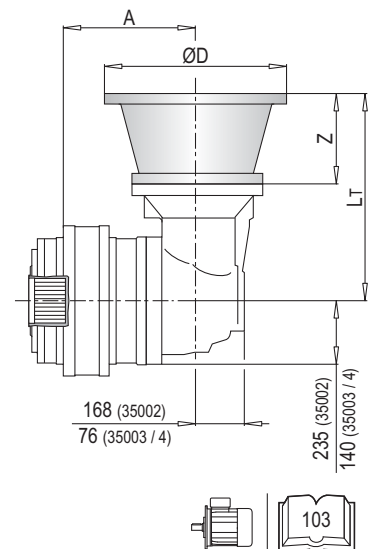

PLB 35000 F - Giriş Milleri / Input Shafts / Antriebswellen / Alberi Entrata / Arbres D'entree / Ejes De Entrada

PLB	EL C 28					EL C 42					EML 42					EML 1"3/8 Z6					EM 65									
	A	LT	Z	L	Ød	A	LT	Z	L	Ød	A	LT	Z	L	Ød	A	LT	Z	L	Ød	A	LT	Z	L	Ød					
35002	-					-					-					-					307	436.5								
35003	-					-					-					-					378.5	361.5	121.5	105	65					
35004	439.5	304	64	50	28	439.5	304	64	50	42	439.5	334	94	82	42	439.5	334	94	106	1"3/8	439.5									

PLB	EM 1"3/8 Z6					EP 65					PLB	~ Kg							
	A	LT	Z	L	Ød	A	LT	Z	L	Ød		EL C 28	EL C 42	EML 42	EML 1"3/8 Z6	EM 65	EM 1"3/8 Z6	EP 65	
35002	307	436.5				307	468				35002	-	-	-	-	267.0	267.0	276.0	
35003	378.5	361.5	121.5	105	1"3/8	378.5	393	153	105	65	35003	-	-	-	-	326.0	326.0	335.0	
35004	439.5					439.5					35004	270.5	271.0	274.0	274.0	282.0	282.0	291.0	

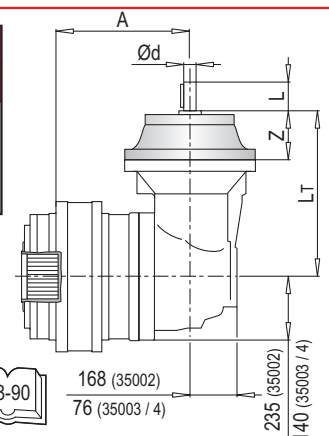

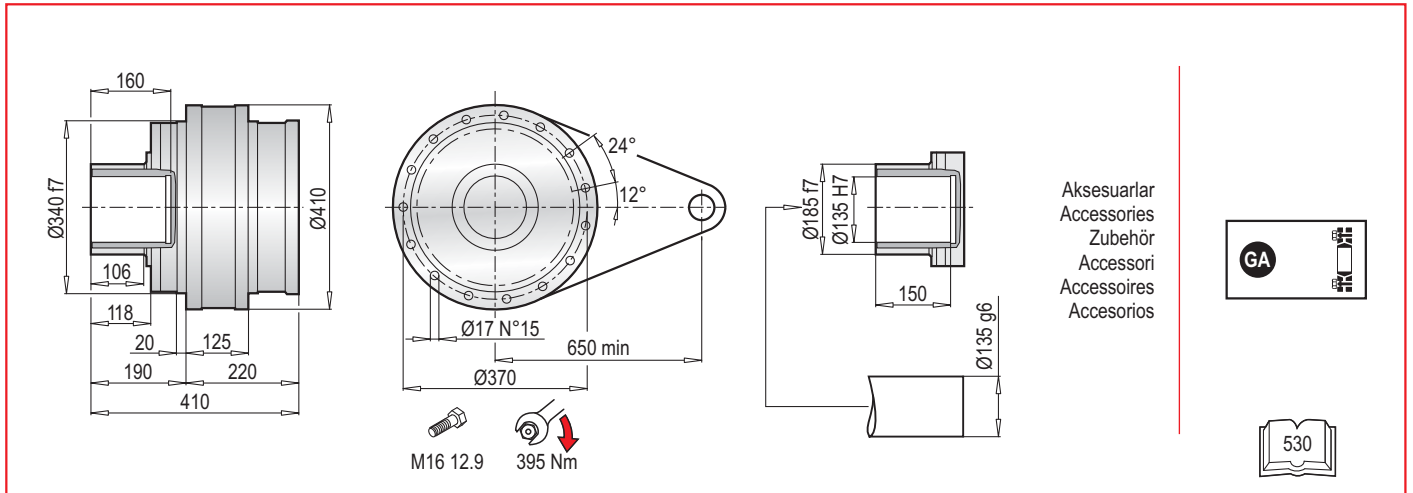

PL 35000 FS - Elektrik Motor Adaptörleri (IEC) / Electric Motor Couplings (IEC) / Anbauvorrichtung Für Elektromotore (IEC) / Predisposizioni Per Motori Elettrici (IEC) / Adaptations Pour Moteurs Electriques (IEC) / Acoplamientos Para Motores Eléctricos (IEC)

PL	IEC 63			IEC 71			IEC 80			IEC 90			IEC 100			IEC 112		
	L _T	Z	ØD	L _T	Z	ØD	L _T	Z	ØD	L _T	Z	ØD	L _T	Z	ØD	L _T	Z	ØD
35001	-	-	-	-	-	-	-	-	-	-	-	-	-	-	-	-	-	-
35002	-	-	-	-	-	-	-	-	-	-	-	-	-	-	-	-	-	-
35003	414.5	36	140	414.5	36	160	434.5	56	200	434.5	56	200	444.5	66	250	444.5	66	250
35004	475.5	-	-	475.5	-	-	495.5	-	-	495.5	-	-	505.5	-	-	505.5	-	-

PL	IEC 132			IEC 160			IEC 180			IEC 200			IEC 225			IEC 250		
	L _T	Z	ØD	L _T	Z	ØD	L _T	Z	ØD	L _T	Z	ØD	L _T	Z	ØD	L _T	Z	ØD
35001	-	-	-	370	150	-	370	150	-	370	150	400	359	139	450	359	139	550
35002	-	-	-	425	118	-	425	118	-	455	148	-	-	-	-	-	-	-
35003	478.5	100	300	517.5	139	350	517.5	139	350	-	-	-	-	-	-	-	-	-
35004	539.5	-	-	578.5	-	-	583.5	-	-	-	-	-	-	-	-	-	-	-

PL	IEC ~ Kg											
	63	71	80	90	100	112	132	160	180	200	225	250
35001	-	-	-	-	-	-	-	212	212	217	223	235
35002	-	-	-	-	-	-	-	239	239	249	-	-
35003	238	238	240	240	241	241	245	255	255	-	-	-
35004	246	246	248	248	249	249	253	263	263	-	-	-

PL 35000 FS - Giriş Milleri / Input Shafts / Antriebswellen / Alberi Entrada / Arbres D'entree / Ejes De Entrada

PL	EL C 28				EL C 42				EML 42				EML 1"3/8 Z6				EM 65				EM 1"3/8 Z6			
	L _T	Z	L	Ød	L _T	Z	L	Ød	L _T	Z	L	Ød	L _T	Z	L	Ød	L _T	Z	L	Ød	L _T	Z	L	Ød
35002	-	-	-	-	-	-	-	-	-	-	-	-	-	-	-	-	428.5	-	-	-	428.5	-	-	-
35003	442.5	64	50	28	442.5	64	82	42	472.5	94	82	42	472.5	94	106	1"3/8	500	121.5	105	65	500	121.5	105	1"3/8
35004	503.5	-	-	-	503.5	-	-	-	533.5	-	-	-	533.5	-	-	-	-	-	-	-	-	-	-	-

PL	EP 65				ET 90				PL	~ Kg							
	L _T	Z	L	Ød	L _T	Z	L	Ød		EL C 28	EL C 42	EML 42	EML 1"3/8 Z6	EM 65	EM 1"3/8 Z6	EP 65	ET 90
35002	460	-	-	-	478.5	171.5	170	90	35002	-	-	-	-	234.0	234.0	243.0	265.0
35003	531.5	153	105	65	-	-	-	-	35003	238.5	239.0	242.0	242.0	250.0	250.0	259.0	-
35004	-	-	-	-	-	-	-	-	35004	246.5	247.0	250.0	250.0	-	-	-	-

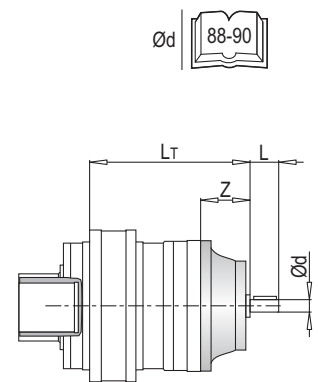
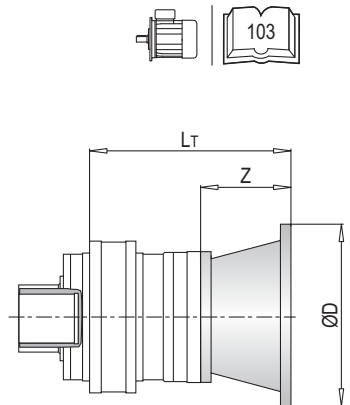

PL 35000 FS - Sonsuz Dişli Redüktör Adaptörleri (PMRV/PRV) / Worm Gearbox Adaptors (PMRV/PRV) / Anschluss Für Schneckengetriebe (PMRV/PRV) / Predisposizioni Per Riduttori A Vite Senza Fine (PMRV/PRV) / Adaptation Pour Reducteurs A Vis Sans Fin (PMRV/PRV) / Acoplamiento Para Reductores De Tornillo Sin Fin (PMRV/PRV)

PL	PMRV/PRV 050					PMRV/PRV 063					PMRV/PRV 075				
	Lm	l	h	MA	G	Lm	l	h	MA	G	Lm	l	h	MA	G
35002	-					-					-				
35003	500	50	110	60	80	509.5	63	135	72	95	488.5	75	161	86	112.5
35004	561					570.5					549.5				

PL	PMRV/PRV 090					PMRV/PRV 110					PMRV/PRV 130				
	Lm	l	h	MA	G	Lm	l	h	MA	G	Lm	l	h	MA	G
35002	-					441	110	237.5	127.5	160	446.5	130	277.5	147.5	180
35003	498.5	90	193	103	129.5	512.5					518				
35004	559.5														

PL	PMRV/PRV 150				
	Lm	l	h	MA	G
35002	463	150	320	170	210
35003	534.5				
35004					

PL	PMRV/PRV ~ Kg							
	050	063	075	090	110	130	150	
35002	-	-	-	-	263	280	316	
35003	241	244.5	247	252	279	296	332	
35004	249	252.5	255	260	-	-	-	

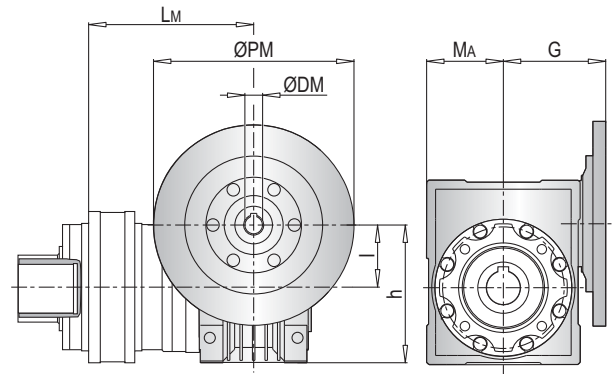

PLB 35000 FS - Elektrik Motor Adaptörleri (IEC) / Electric Motor Couplings (IEC) / Anbauvorrichtung Für Elektromotore (IEC) / Predisposizioni Per Motori Elettrici (IEC) / Adaptations Pour Moteurs Electriques (IEC) / Acoplamientos Para Motores Eléctricos (IEC)

PLB	IEC 80				IEC 90				IEC 100				IEC 112			
	A	LT	Z	ØD	A	LT	Z	ØD	A	LT	Z	ØD	A	LT	Z	ØD
35002	-				-				-				-			
35003	-				-				-				-			
35004	480	296	56	200	480	296	56	200	480	306	66	250	480	306	66	250

PLB	IEC 132				IEC 160				IEC 180				IEC 200			
	A	LT	Z	ØD	A	LT	Z	ØD	A	LT	Z	ØD	A	LT	Z	ØD
35002	-				285	433	118	350	285	433	118	350	285	463	148	400
35003	-				442				442							
35004	480	340	100	300	480	379	139									

PLB	IEC ~ Kg							
	80	90	100	112	132	160	180	200
35002	-	-	-	-	-	280	280	290
35003	-	-	-	-	-	339	339	-
35004	280	280	281	281	285	295	-	-

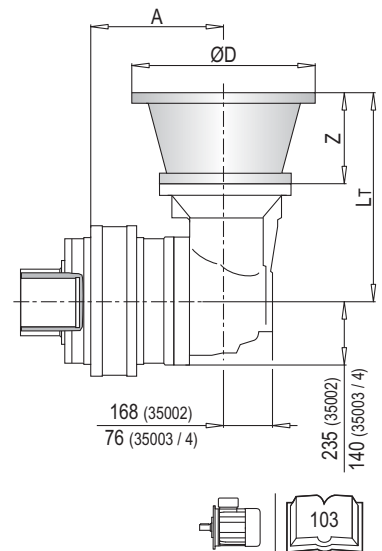

PLB 35000 FS - Giriş Milleri / Input Shafts / Antriebswellen / Alberi Entrata / Arbres D'entree / Ejes De Entrada

PLB	EL C 28					EL C 42					EML 42					EML 1"3/8 Z6					EM 65									
	A	LT	Z	L	Ød	A	LT	Z	L	Ød	A	LT	Z	L	Ød	A	LT	Z	L	Ød	A	LT	Z	L	Ød					
35002	-					-					-					-					307	436.5								
35003	-					-					-					-					378.5		121.5	105	65					
35004	439.5	304	64	50	28	439.5	304	64	82	42	439.5	334	94	82	42	439.5	334	94	82	1"3/8	439.5	361.5								

PLB	EM 1"3/8 Z6					EP 65					PLB	~ Kg							
	A	LT	Z	L	Ød	A	LT	Z	L	Ød		EL C 28	EL C 42	EML 42	EML 1"3/8 Z6	EM 65	EM 1"3/8 Z6	EP 65	
35002	307	436.5				307	468				35002	-	-	-	-	275.0	275.0	284.0	
35003	378.5		121.5	105	1"3/8	378.5		153	105	65	35003	-	-	-	-	334.0	334.0	343.0	
35004	439.5	361.5				439.5	393				35004	278.5	279.0	282.0	282.0	290.0	290.0	299.0	

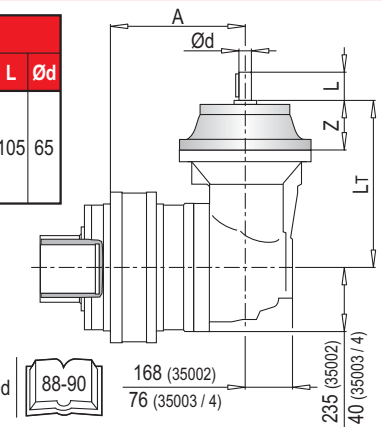

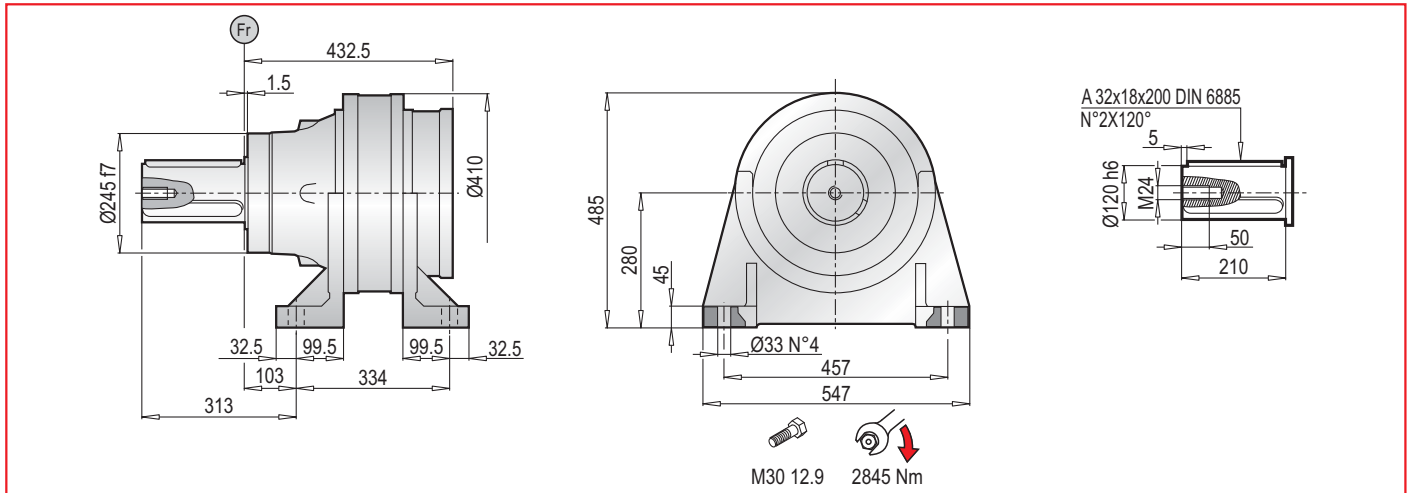

PL 35000 CPC - Elektrik Motor Adaptörleri (IEC) / Electric Motor Couplings (IEC) / Anbauvorrichtung Für Elektromotore (IEC) / Predisposizioni Per Motori Elettrici (IEC) / Adaptations Pour Moteurs Electriques (IEC) / Acoplamientos Para Motores Eléctricos (IEC)

PL	IEC 63			IEC 71			IEC 80			IEC 90			IEC 100			IEC 112		
	L _T	Z	ØD	L _T	Z	ØD	L _T	Z	ØD	L _T	Z	ØD	L _T	Z	ØD	L _T	Z	ØD
35001	-	-	-	-	-	-	-	-	-	-	-	-	-	-	-	-	-	-
35002	-	-	-	-	-	-	-	-	-	-	-	-	-	-	-	-	-	-
35003	627	36	140	627	36	160	647	56	200	647	56	200	657	66	250	657	66	250
35004	688	-	-	688	-	-	708	-	-	708	-	-	718	-	-	718	-	-

PL	IEC 132			IEC 160			IEC 180			IEC 200			IEC 225			IEC 250		
	L _T	Z	ØD	L _T	Z	ØD	L _T	Z	ØD	L _T	Z	ØD	L _T	Z	ØD	L _T	Z	ØD
35001	-	-	-	582.5	150	-	582.5	150	-	582.5	150	400	571.5	139	450	571.5	139	550
35002	-	-	-	637.5	118	-	637.5	118	-	667.5	148	-	-	-	-	-	-	-
35003	691	100	300	730	139	350	730	139	350	-	-	-	-	-	-	-	-	-
35004	752	-	-	791	-	-	791	-	-	-	-	-	-	-	-	-	-	-

PL	IEC ~ Kg											
	63	71	80	90	100	112	132	160	180	200	225	250
35001	-	-	-	-	-	-	-	301	301	306	293	324
35002	-	-	-	-	-	-	-	330	330	340	-	-
35003	329	329	331	331	332	332	336	346	346	-	-	-
35004	337	337	339	339	340	340	344	354	354	-	-	-

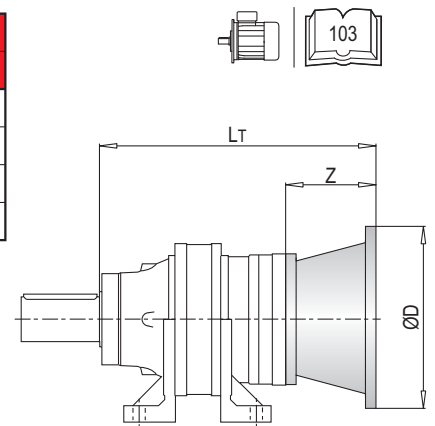

PL 35000 CPC - Giriş Milleri / Input Shafts / Antriebswellen / Alberi Entrata / Arbres D'entree / Ejes De Entrada

PL	EL C 28				EL C 42				EML 42				EML 1"3/8 Z6				EM 65				EM 1"3/8 Z6			
	L _T	Z	L	Ød	L _T	Z	L	Ød	L _T	Z	L	Ød	L _T	Z	L	Ød	L _T	Z	L	Ød	L _T	Z	L	Ød
35002	-	-	-	-	-	-	-	-	-	-	-	-	-	-	-	-	641	121.5	105	65	641	121.5	105	1"3/8
35003	655	64	50	28	655	64	82	42	685	94	82	42	685	94	106	1"3/8	712.5	-	-	-	712.5	-	-	-
35004	716	-	-	-	716	-	-	-	746	-	-	-	746	-	-	-	-	-	-	-	-	-	-	-

PL	EP 65				ET 90				PL	~ Kg							
	L _T	Z	L	Ød	L _T	Z	L	Ød		EL C 28	EL C 42	EML 42	EML 1"3/8 Z6	EM 65	EM 1"3/8 Z6	EP 65	ET 90
35002	672.5	153	105	65	691	171.5	170	90	35002	-	-	-	-	325.0	325.0	334.0	304.0
35003	744	-	-	-	-	-	-	-	35003	329.5	330.0	333.0	333.0	341.0	341.0	350.0	-
35004	-	-	-	-	-	-	-	-	35004	337.5	338.0	341.0	341.0	-	-	-	-

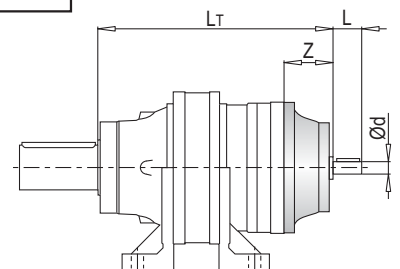

PL 35000 CPC - Sonsuz Dişli Redüktör Adaptörleri (PMRV/PRV) / Worm Gearbox Adaptors (PMRV/PRV) / Anschluss Für Schneckengetriebe (PMRV/PRV) / Predisposizioni Per Riduttori A Vite Senza Fine (PMRV/PRV) / Adaptation Pour Reducteurs A Vis Sans Fin (PMRV/PRV) / Acoplamiento Para Reductores De Tornillo Sin Fin (PMRV/PRV)

PL	PMRV/PRV 050					PMRV/PRV 063					PMRV/PRV 075				
	Lm	l	h	MA	G	Lm	l	h	MA	G	Lm	l	h	MA	G
35002	-					-					-				
35003	712.5	50	110	60	80	722	63	135	72	95	701	75	161	86	112.5
35004	773.5					783					762				

PL	PMRV/PRV 090					PMRV/PRV 110					PMRV/PRV 130				
	Lm	l	h	MA	G	Lm	l	h	MA	G	Lm	l	h	MA	G
35002	-					653.5	110	237.5	127.5	160	659	130	277.5	147.5	180
35003	711	90	193	103	129.5	725					730.5				
35004	772					-					-				

PL	PMRV/PRV 150				
	Lm	l	h	MA	G
35002	675.5				
35003	747	150	320	170	210
35004	-				

PL	PMRV/PRV ~ Kg						
	050	063	075	090	110	130	150
35002	-	-	-	-	354	371	407
35003	332	335.5	338	343	370	387	423
35004	340	363.5	346	351	-	-	-

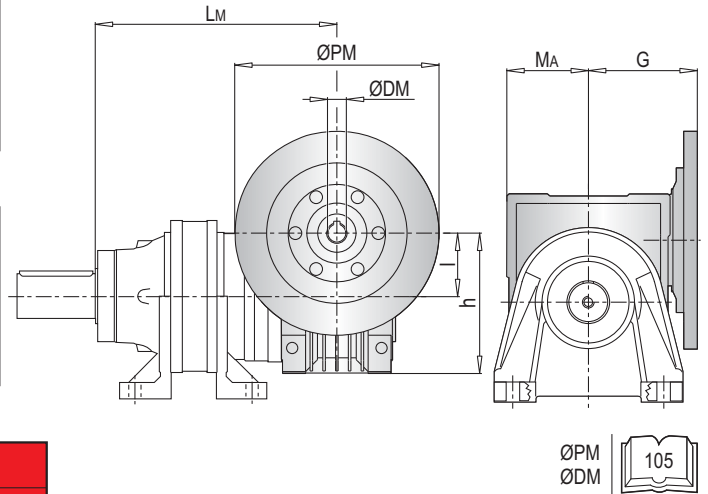

PLB 35000 CPC - Elektrik Motor Adaptörleri (IEC) / Electric Motor Couplings (IEC) / Anbauvorrichtung Für Elektromotore (IEC) / Predisposizioni Per Motori Elettrici (IEC) / Adaptations Pour Moteurs Electriques (IEC) / Acoplamientos Para Motores Eléctricos (IEC)

PLB	IEC 80				IEC 90				IEC 100				IEC 112			
	A	LT	Z	ØD	A	LT	Z	ØD	A	LT	Z	ØD	A	LT	Z	ØD
35002	-				-				-				-			
35003	-				-				-				-			
35004	692.5	296	56	200	692.5	296	56	200	692.5	306	66	250	692.5	306	66	250

PLB	IEC 132				IEC 160				IEC 180				IEC 200			
	A	LT	Z	ØD	A	LT	Z	ØD	A	LT	Z	ØD	A	LT	Z	ØD
35002	-				497.5	433	118	350	497.5	433	118	350	497.5	463	148	400
35003	-				654.5				654.5				-			
35004	692.5	340	100	300	692.5	379	139		-				-			

PLB	IEC ~ Kg							
	80	90	100	112	132	160	180	200
35002	-	-	-	-	-	372	372	400
35003	-	-	-	-	-	429	429	-
35004	371	371	372	372	376	295	-	-

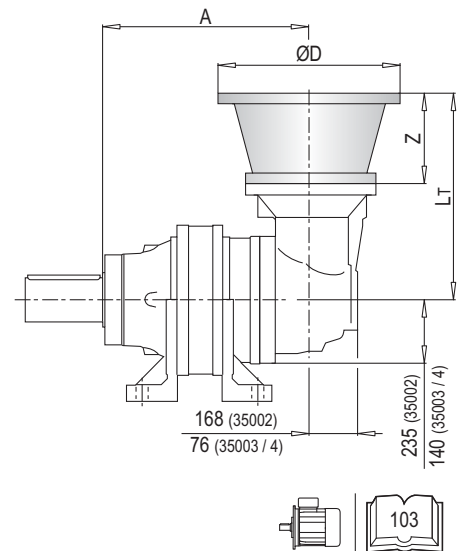

PLB 35000 CPC - Giriş Milleri / Input Shafts / Antriebswellen / Alberi Entrata / Arbres D'entree / Ejes De Entrada

PLB	EL C 28					EL C 42					EML 42					EML 1"3/8 Z6					EM 65									
	A	LT	Z	L	Ød	A	LT	Z	L	Ød	A	LT	Z	L	Ød	A	LT	Z	L	Ød	A	LT	Z	L	Ød					
35002	-					-					-					-					497.5	436.5								
35003	-					-					-					-					654.5					121.5	105	65		
35004	692.5	304	64	50	28	692.5	304	64	82	42	692.5	334	94	82	42	692.5	334	94	106	1"3/8	692.5	361.5								

PLB	EM 1"3/8 Z6					EP 65				
	A	LT	Z	L	Ød	A	LT	Z	L	Ød
35002	497.5	436.5				497.5	468			
35003	654.5		121.5	105	1"3/8	654.5	393	153	105	65
35004	692.5	361.5				692.5				

PLB	~ Kg							
	EL C 28	EL C 42	EML 42	EML 1"3/8 Z6	EM 65	EM 1"3/8 Z6	EP 65	
35002	-	-	-	-	367.0	367.0	398.0	
35003	-	-	-	-	424.0	424.0	455.0	
35004	369.5	370.0	373.0	373.0	381.0	381.0	412.0	

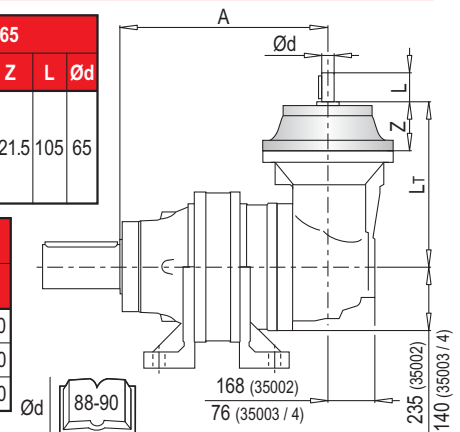

AKSESUARLAR / ACCESSORIES / ZUBEHÖR / ACCESSORI / ACCESSOIRES / ACCESORIOS

BS Spline kaplin / Splined bushing / Innenverzahnte Buchse
Boccola scanalata / Moyeu cannelé / Casquillo ranurado

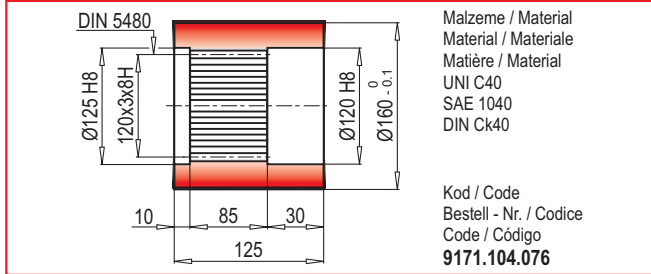

KB Spline mil / Splined rod / Außenverzahnte Welle
Barra scanalata / Arbre cannelé / Barra ranurada

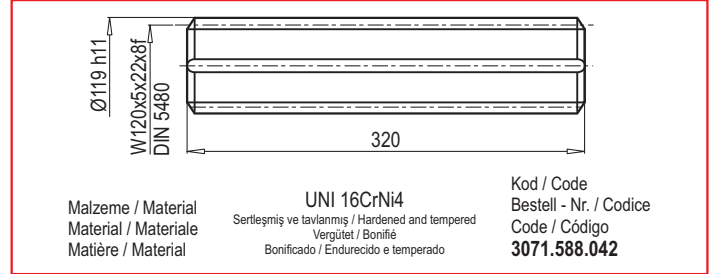

FL Flanş / Flange / Flansch
Flangia / Bride / Brida

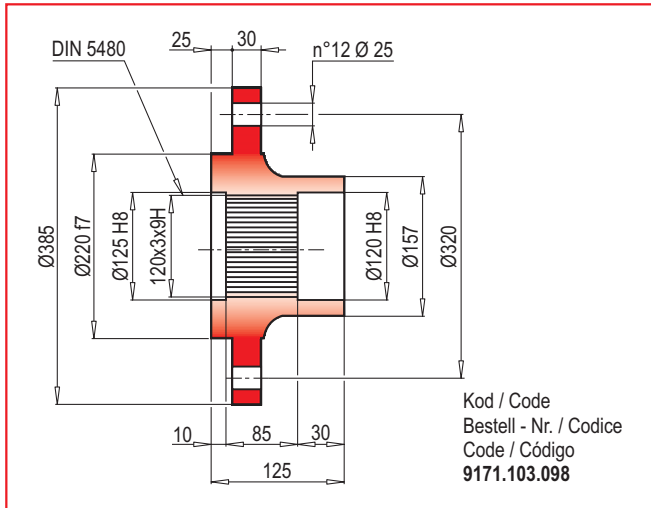

GA Konik sıkırtma / Shrink disc / Schrumpfscheibe
Giunto di attrito / Frette de serrage / Disco de contracción

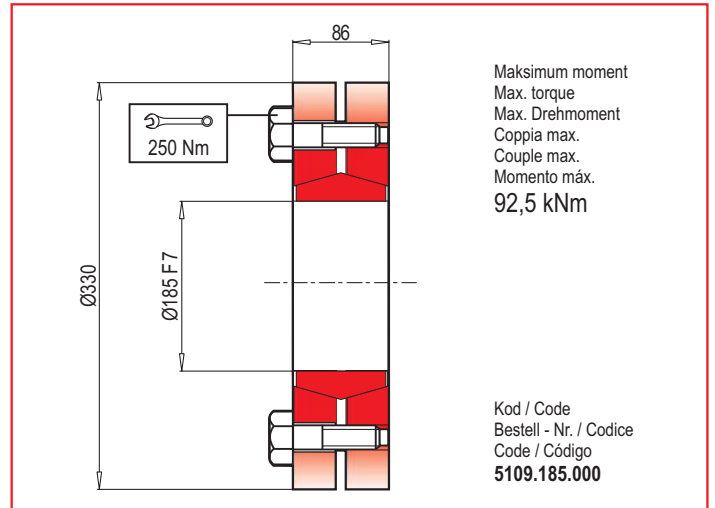

FF Sabitleme rondelası / Stop bottom plate / Endscheibe
Fondello di arresto / Bouchon de fermeture / Tapón de detención

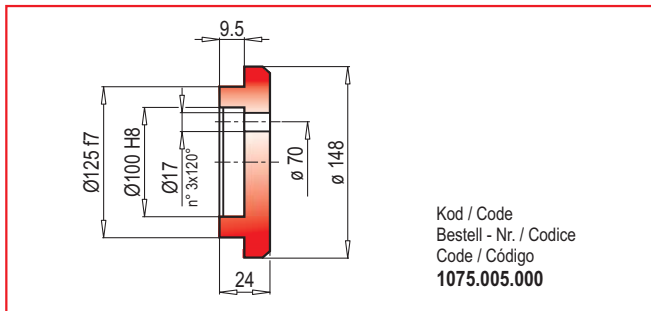

TR

RADYAL YÜKLER (Fr)

Aşağıdaki grafikler istenilen n_2xh değerinin elde edilmesi için gerekli olan radyal yükleri ve K faktörlerini göstermektedir.

EN

RADIAL LOADS (Fr)

The following curves show the radial loads and the K factors to obtain the required n_2xh value.

DE

RADIALLAST (Fr)

In den nachstehenden Diagrammen ist die Radiallast und der Koeffizient K dargestellt und kann mit dem gewünschten Wert n_2xh verglichen werden.

IT

CARICHI RADIALI (Fr)

Nei diagrammi seguenti sono riportati i carichi radiali e i coefficienti K per rapportarli al valore n_2xh desiderato.

FR

CHARGES RADIALES (Fr)

Dans les diagrammes suivants sont indiqués les charges radiales et les facteurs K de façon à obtenir la valeur n_2xh désirée.

ES

CARGAS RADIALES (Fr)

En los siguientes diagramas se indican las cargas radiales y los coeficientes K para obtener el valor requerido n_2xh .

M - CPC*

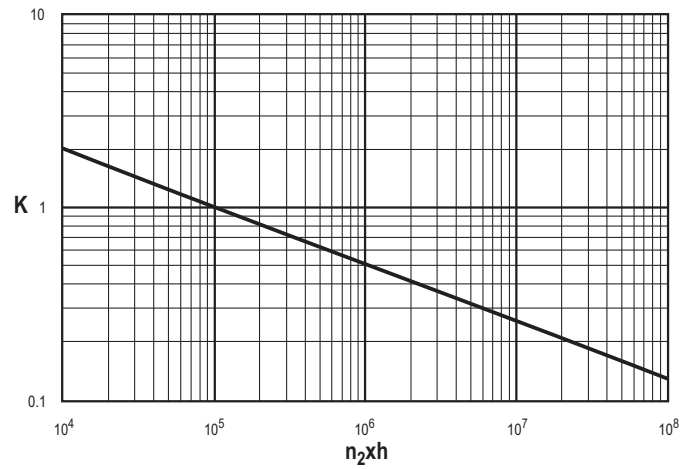
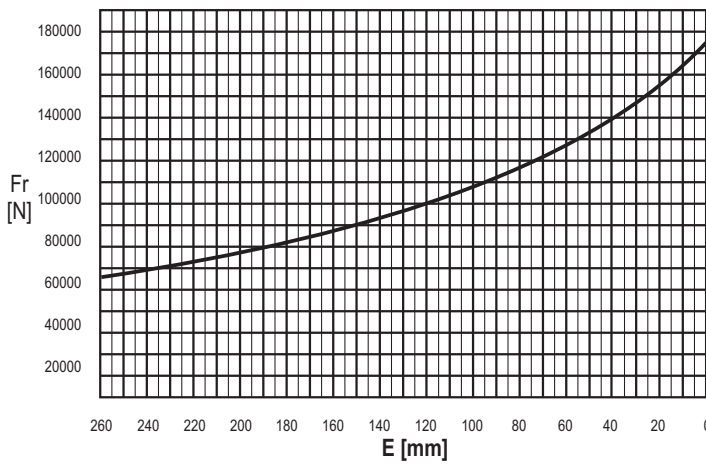

	$n \times h$				
	10^5	10^4	10^6	10^7	10^8
M	Fr		Fr • K		
CPC*	Fr • 0.75		Fr • K • 0.75		

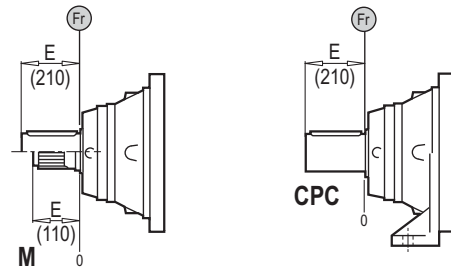

TR

EKSENEL YÜKLER (Fa)

Tabloda yer alan eksenel yük değerleri, çıkış tipine ve uygulamanın yük yönüne göre değişir.

EN

AXIAL LOADS (Fa)

The values of the axial loads in the table refer to the output versions and load direction of application.

DE

AXIALLAST (Fa)

Die dargestellten Werte der Axiallast basieren auf der Version und der applizierten Lastrichtung.

IT

CARICHI ASSIALI (Fa)

I valori dei carichi assiali indicati in tabella sono riferiti alle versioni e alla direzione di applicazione del carico.

FR

CHARGES AXIALES (Fa)

Les valeurs des charges axiales indiquées dans le tableau se réfèrent aux versions et à la direction d'application de la charge.

ES

CARGAS AXIALES (Fa)

Los valores de las cargas axiales indicados en la tabla se refieren a las versiones y a la dirección de aplicación de la carga.

Fa [N]	M	CPC	← →
		80000	
	100000	100000	

