

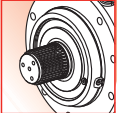





TEKNİK VERİLER / TECHNICAL DATA / TECHNISCHE DATEN / DATI TECNICI / DONNÉES TECHNIQUES / DATOS TÉCNICAS

	i_{ges}	M_{max} ($n_2 \times h: 20000$) (Nm)	OUTPUT		INPUT	
460001	3.83	694500	 Ø290	 W280X5X54X8f DIN 5480	 Ø28 - Ø42 Ø1"3/8 - Ø65 - Ø90	 Hydraulic Motor
460002	14.69 ... 16.87	694500	 Ø300	 N280X6X9H DIN 5480	 Electric Motor	 Worm gearboxes
460003	58.11 ... 101.20	693800				
460004	237.16 ... 683.10	640500			 Brake	
460005	780.54 ... 4952.48	558100				

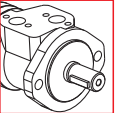
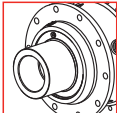
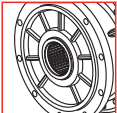
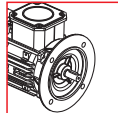
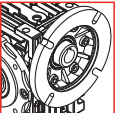
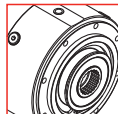
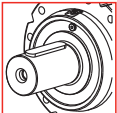
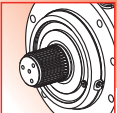
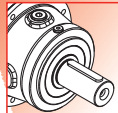
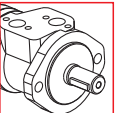
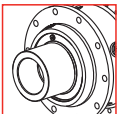
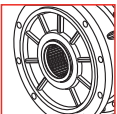
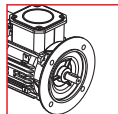
	i_{ges}	M_{max} ($n_2 \times h: 20000$) (Nm)	OUTPUT		INPUT	
460005	634.60 ... 3187.80	544400	 Ø290	 W280X5X54X8f DIN 5480	 Ø1"3/8 Ø65	 Hydraulic Motor
			 Ø300	 N280X6X9H DIN 5480	 Electric Motor	
					 Brake	

	Pt [kW]	n _{1max} [min ⁻¹]	i _{ges}	Mc [kNm]				Giriş- Input - Antrieb - Entrada - Entrée - Entrada				
				n ₂ x h	n ₂ x h	n ₂ x h	n ₂ x h				EL - EML EM - EP - ET	
				10.000	20.000	50.000	100.000					IEC (B5)
PL 460001	224	200	3.83	642.8	578.7	503.8	461.0	160 180	200 225	250 280	-	-
PL 460002	133	750	14.69 16.87	642.8 642.0	578.7 578.1	503.8 503.3	461.0 461.0	160 180	200 225	250 280	-	-
PL 460003	90	1500	58.11 66.70 74.39 85.39 101.20	603.6 642.0 441.9 495.0 394.8	534.3 578.1 391.1 438.1 349.5	454.6 503.3 332.7 372.8 297.4	402.5 450.8 294.6 330.0 263.3	160 180 200	225 250 280	-	ET 90	
PL 460004	73	2800	237.16 285.86 318.82 365.95 416.59 478.17 566.72 683.10	603.1 525.5 441.9 495.0 439.8 492.7 394.8 394.8	533.8 465.1 391.1 438.1 389.2 436.1 349.5 349.5	454.1 395.8 332.7 372.8 331.2 371.1 297.4 297.4	402.0 350.5 294.6 330.0 293.4 328.5 263.3 263.3	160 180 200 225 250 280	110 130 150	EM 65 EM 1"3/8 Z6 EP 65 ET 90		
PL 460005	59	2800	780.54 895.92 940.83 1079.90 1252.35 1382.46 1509.53 1647.22 1890.72 1972.45 2152.37 2470.55 2602.29 2869.02 3144.43 3466.73 4098.60 4314.66 4952.48	421.9 472.7 469.1 525.5 495.0 495.0 438.1 441.9 495.0 492.7 439.8 492.7 394.8 492.7 394.8 430.7 394.8 352.4 387.1	373.6 418.6 415.1 465.1 438.1 438.1 438.1 391.1 438.1 436.1 389.2 436.1 349.5 436.1 349.5 381.2 349.5 311.9 342.6	318.0 356.4 353.2 395.8 372.8 372.8 372.8 332.7 372.8 371.1 331.2 371.1 297.4 371.1 297.4 324.2 297.4 265.5 291.6	281.5 315.4 312.8 350.5 330.0 330.0 330.0 294.6 330.0 328.5 293.4 328.5 263.3 328.5 263.3 287.6 263.3 235.0 258.1	63 71 80 90 100 112 132 160 180	050 063 075 090 110 130 150	EL C 28 EL C 42 EML 42 EML 1"3/8 Z6 EM 65 EM 1"3/8 Z6 EP 65		

	Pt [kW]	n _{1max} [min ⁻¹]	i _{ges}	Mc [kNm]				Giriş- Input - Antrieb - Entrada - Entrée - Entrada	
				n ₂ x h	n ₂ x h	n ₂ x h	n ₂ x h		
				10.000	20.000	50.000	100.000	IEC (B5)	EL - EML EM - EP - ET
PLB 460005	52	2500	634.60	444.9	361.5	274.7	223.2	80 90 100 112 132 160 180	EM 65 EM 1 ³ / ₈ Z6 EP 65
			728.41	490.0	398.1	302.5	245.8		
			764.92	469.1	412.0	313.0	254.4		
			877.99	525.5	453.7	344.8	280.1		
			932.49	495.0	438.1	359.7	292.2		
			1123.98	495.0	438.1	372.8	330.0		
			1234.33	441.9	391.1	297.5	241.5		
			1334.00	509.7	413.8	314.2	255.1		
			1468.67	492.7	436.1	371.1	328.5		
			1707.75	495.0	438.1	372.8	303.2		
			1944.08	439.8	389.2	331.2	293.4		
			2231.46	492.7	436.1	371.1	328.5		
			2644.69	394.8	349.5	297.4	263.3		
			3187.80	394.8	349.5	297.4	263.3		



$$M_{\max} = M_C \times 1.2$$

(n₂ x h = 20.000)

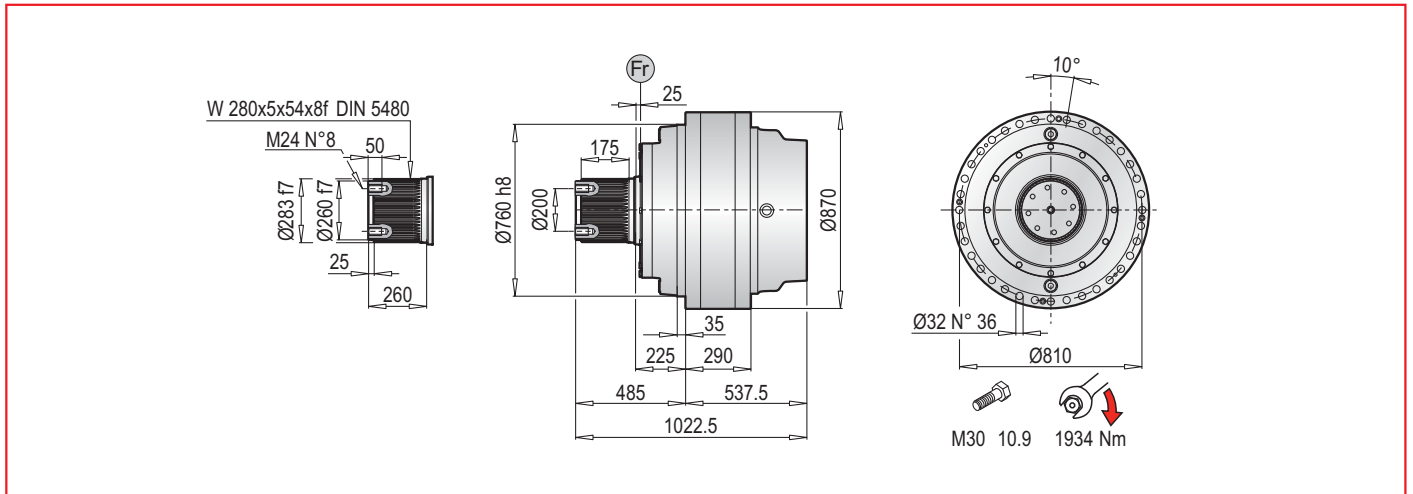

PL 460000 MS - Elektrik Motor Adaptörleri (IEC) / Electric Motor Couplings (IEC) / Anbauvorrichtung Für Elektromotore (IEC) / Predisposizioni Per Motori Elettrici (IEC) / Adaptations Pour Moteurs Electriques (IEC) / Acoplamientos Para Motores Eléctricos (IEC)

PL	IEC 63			IEC 71			IEC 80			IEC 90			IEC 100			IEC 112			IEC 132						
	L _T	Z	ØD	L _T	Z	ØD	L _T	Z	ØD	L _T	Z	ØD	L _T	Z	ØD	L _T	Z	ØD	L _T	Z	ØD				
460001	-	-	-	-	-	-	-	-	-	-	-	-	-	-	-	-	-	-	-	-	-	-	-	-	
460002	-	-	-	-	-	-	-	-	-	-	-	-	-	-	-	-	-	-	-	-	-	-	-	-	
460003	-	-	-	-	-	-	-	-	-	-	-	-	-	-	-	-	-	-	-	-	-	-	-	-	
460004	-	-	-	-	-	-	-	-	-	-	-	-	-	-	-	-	-	-	-	-	-	-	-	-	
460005	1320	36	140	1320	36	160	1340	56	200	1340	56	200	1350	66	250	1350	66	250	1384	100	300				

PL	IEC 160			IEC 180			IEC 200			IEC 225			IEC 250			IEC 280						
	L _T	Z	ØD	L _T	Z	ØD	L _T	Z	ØD	L _T	Z	ØD	L _T	Z	ØD	L _T	Z	ØD				
460001	687.5	-	-	687.5	-	-	687.5	-	-	676.5	-	-	676.5	-	-	676.5	-	-				
460002	1034.5	150	-	1034.5	150	-	1034.5	150	400	1023.5	-	-	1023.5	139	550	1023.5	139	550				
460003	1255.5	-	350	1255.5	-	350	1255.5	-	-	1244.5	139	450	1244.5	-	-	1244.5	-	-				
460004	1330.5	118	-	1330.5	118	-	1360.5	148	-	1351.5	-	-	1361	148.5	-	1361	148.5	-				
460005	1423	139	-	1423	139	-	-	-	-	-	-	-	-	-	-	-	-	-				

PL	IEC ~ Kg												
	63	71	80	90	100	112	132	160	180	200	225	250	280
460001	-	-	-	-	-	-	-	2085	2085	2090	2096	2108	2120
460002	-	-	-	-	-	-	-	2490	2490	2495	2501	2513	2525
460003	-	-	-	-	-	-	-	2606	2606	2611	2617	2629	2641
460004	-	-	-	-	-	-	-	2610	2610	2620	2625	2666	2668
460005	2607	2607	2609	2609	2610	2610	2614	2624	2624	-	-	-	-

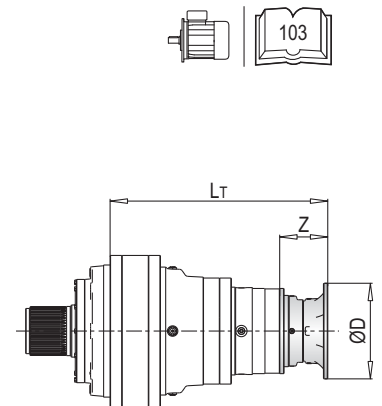

PL 460000 MS - Giriş Milleri / Input Shafts / Antriebswellen / Alberi Entrata / Arbres D'entree / Ejes De Entrada

PL	EL C 28				EL C 42				EML 42				EML 1"3/8 Z6				EM 65				EM 1"3/8 Z6			
	L _T	Z	L	Ød	L _T	Z	L	Ød	L _T	Z	L	Ød	L _T	Z	L	Ød	L _T	Z	L	Ød	L _T	Z	L	Ød
460003	-	-	-	-	-	-	-	-	-	-	-	-	-	-	-	-	-	-	-	-	-	-	-	-
460004	-	-	-	-	-	-	-	-	-	-	-	-	-	-	-	-	1334	121.5	105	65	1334	121.5	105	1"3/8
460005	1348	64	50	28	1348	64	82	42	1378	94	82	42	1378	94	106	1"3/8	1405.5	121.5	105	65	1405.5	121.5	105	1"3/8

PL	EP 65				ET 90				PL	~ Kg							
	L _T	Z	L	Ød	L _T	Z	L	Ød		EL C 28	EL C 42	EML 42	EML 1"3/8 Z6	EM 65	EM 1"3/8 Z6	EP 65	ET 90
460003	-	-	-	-	1277	171.5	170	90	460003	-	-	-	-	-	-	-	2609
460004	1365.5	153	105	65	1384	-	-	-	460004	-	-	-	-	2605	2605	2614	2636
460005	1437	-	-	-	-	-	-	-	460005	2608	2608	2611	2611	2619	2619	2628	-

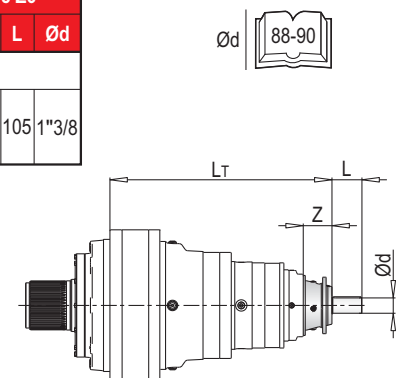

PL 460000 MS - Sonsuz Dişli Redüktör Adaptörleri (PMRV/PRV) / Worm Gearbox Adaptors (PMRV/PRV) / Anschluss Für Schneckengetriebe (PMRV/PRV) / Predisposizioni Per Riduttori A Vite Senza Fine (PMRV/PRV) / Adaptation Pour Reducteurs A Vis Sans Fin (PMRV/PRV) / Acoplamiento Para Reductores De Tornillo Sin Fin (PMRV/PRV)

PL	PMRV/PRV 050					PMRV/PRV 063					PMRV/PRV 075				
	Lm	I	h	MA	G	Lm	I	h	MA	G	Lm	I	h	MA	G
460004	-					-					-				
460005	1405.5	50	110	60	80	1415	63	113	72	95	1394	75	161	86	112.5

PL	PMRV/PRV 090					PMRV/PRV 110					PMRV/PRV 130				
	Lm	I	h	MA	G	Lm	I	h	MA	G	Lm	I	h	MA	G
460004	-					1346.5	110	237.5	127.5	160	1352	130	277.5	147.5	180
460005	1404	90	193	103	129.5	1418					1423.5				

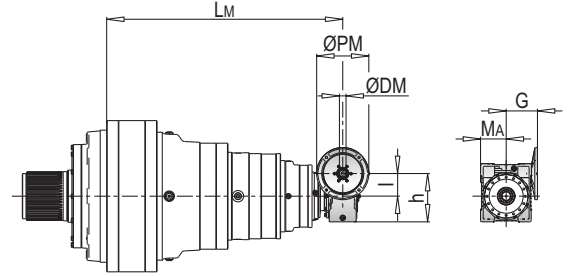

PL	PMRV/PRV 150				
	Lm	I	h	MA	G
460004	1368.5				
460005	1440	150	320	170	210

PL	PMRV/PRV ~ Kg						
	050	063	075	090	110	130	150
460004	-	-	-	-	2634	2651	2687
460005	2610	2614	2616	2621	2648	2665	2701

PLB 460000 MS - Elektrik Motor Adaptörleri (IEC) / Electric Motor Couplings (IEC) / Anbauvorrichtung Für Elektromotore (IEC) / Predisposizioni Per Motori Elettrici (IEC) / Adaptations Pour Moteurs Electriques (IEC) / Acoplamientos Para Motores Eléctricos (IEC)

PLB	IEC 80				IEC 90				IEC 100				IEC 112			
	A	L _T	Z	ØD	A	L _T	Z	ØD	A	L _T	Z	ØD	A	L _T	Z	ØD
460005	1300.5	296	56	200	1300.5	296	56	200	1300.5	306	66	250	1300.5	306	66	250

PLB	IEC 132				IEC 160				IEC 180			
	A	L _T	Z	ØD	A	L _T	Z	ØD	A	L _T	Z	ØD
460005	1300.5	340	100	300	1300.5	379	139	350	1300.5	379	139	350

PLB	IEC ~ Kg						
	80	90	100	112	132	160	180
460005	2609	2609	2610	2610	2614	2624	2624

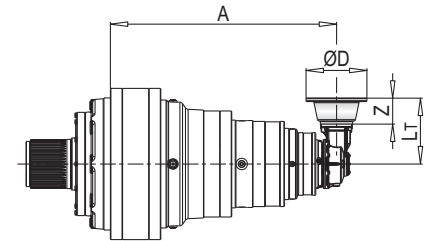

PLB 460000 MS - Giriş Milleri / Input Shafts / Antriebswellen / Alberi Entrata / Arbres D'entree / Ejes De Entrada

PLB	EM 65					EM 1"3/8 Z6					EP 65				
	A	L _T	Z	L	Ød	A	L _T	Z	L	Ød	A	L _T	Z	L	Ød
460005	1300.5	1405.5	121.5	105	65	1300.5	1405.5	121.5	105	1"3/8	1300.5	1437	153	105	65

PLB	~ Kg		
	EM 65	EM 1"3/8 Z6	EP 65
460005	2619	2619	2627

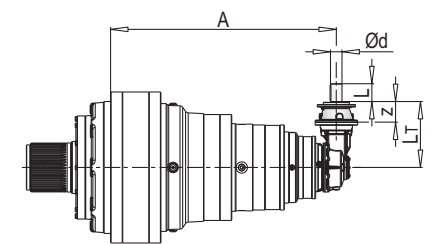

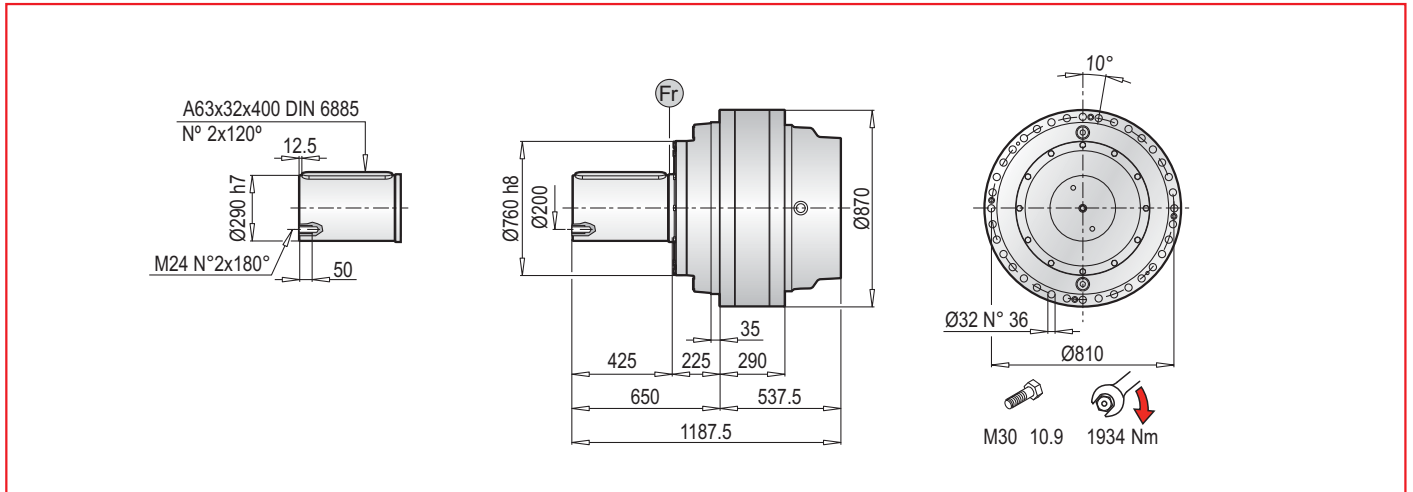

PL 460000 MC - Elektrik Motor Adaptörleri (IEC) / Electric Motor Couplings (IEC) / Anbauvorrichtung Für Elektromotore (IEC) / Predisposizioni Per Motori Elettrici (IEC) / Adaptations Pour Moteurs Electriques (IEC) / Acoplamientos Para Motores Eléctricos (IEC)

PL	IEC 63			IEC 71			IEC 80			IEC 90			IEC 100			IEC 112			IEC 132						
	L _T	Z	ØD	L _T	Z	ØD	L _T	Z	ØD	L _T	Z	ØD	L _T	Z	ØD	L _T	Z	ØD	L _T	Z	ØD				
460001	-	-	-	-	-	-	-	-	-	-	-	-	-	-	-	-	-	-	-	-	-	-	-	-	
460002	-	-	-	-	-	-	-	-	-	-	-	-	-	-	-	-	-	-	-	-	-	-	-	-	
460003	-	-	-	-	-	-	-	-	-	-	-	-	-	-	-	-	-	-	-	-	-	-	-	-	
460004	-	-	-	-	-	-	-	-	-	-	-	-	-	-	-	-	-	-	-	-	-	-	-	-	
460005	1320	36	140	1320	36	160	1340	56	200	1340	56	200	1350	66	250	1350	66	250	1384	100	300				

PL	IEC 160			IEC 180			IEC 200			IEC 225			IEC 250			IEC 280					
	L _T	Z	ØD	L _T	Z	ØD	L _T	Z	ØD	L _T	Z	ØD	L _T	Z	ØD	L _T	Z	ØD			
460001	687.5	-	-	687.5	-	-	687.5	-	-	676.5	-	-	676.5	-	-	676.5	-	-	676.5	-	-
460002	1034.5	150	-	1034.5	150	-	1034.5	150	400	1023.5	139	450	1023.5	139	550	1023.5	139	550	1023.5	139	550
460003	1255.5	-	350	1255.5	-	350	1255.5	-	-	1244.5	-	-	1244.5	-	-	1244.5	-	-	1244.5	-	-
460004	1330.5	118	-	1330.5	118	-	1360.5	148	-	1351.5	-	-	1361	148.5	-	1361	148.5	-	1361	148.5	-
460005	1423	139	-	1423	139	-	-	-	-	-	-	-	-	-	-	-	-	-	-	-	-

PL	IEC ~ Kg												
	63	71	80	90	100	112	132	160	180	200	225	250	280
460001	-	-	-	-	-	-	-	2085	2085	2090	2096	2108	2120
460002	-	-	-	-	-	-	-	2490	2490	2495	2501	2513	2525
460003	-	-	-	-	-	-	-	2606	2606	2611	2617	2629	2641
460004	-	-	-	-	-	-	-	2610	2610	2620	2625	2666	2668
460005	2607	2607	2609	2609	2610	2610	2614	2624	2624	-	-	-	-

PL 460000 MC - Giriş Milleri / Input Shafts / Antriebswellen / Alberi Entrata / Arbres D'entree / Ejes De Entrada

PL	EL C 28				EL C 42				EML 42				EML 1"3/8 Z6				EM 65				EM 1"3/8 Z6			
	L _T	Z	L	Ød	L _T	Z	L	Ød	L _T	Z	L	Ød	L _T	Z	L	Ød	L _T	Z	L	Ød	L _T	Z	L	Ød
460003	-	-	-	-	-	-	-	-	-	-	-	-	-	-	-	-	-	-	-	-	-	-	-	-
460004	-	-	-	-	-	-	-	-	-	-	-	-	-	-	-	-	1334	121.5	105	65	1334	121.5	105	1"3/8
460005	1348	64	50	28	1348	64	82	42	1378	94	82	42	1378	94	106	1"3/8	1405.5	121.5	105	65	1405.5	121.5	105	1"3/8

PL	EP 65				ET 90				PL	~ Kg							
	L _T	Z	L	Ød	L _T	Z	L	Ød		EL C 28	EL C 42	EML 42	EML 1"3/8 Z6	EM 65	EM 1"3/8 Z6	EP 65	ET 90
460003	-	-	-	-	1277	-	-	-	460003	-	-	-	-	-	-	-	2609
460004	1365.5	-	-	-	1384	171.5	170	90	460004	-	-	-	-	2605	2605	2614	2636
460005	1437	153	105	65	-	-	-	-	460005	2608	2608	2611	2611	2619	2619	2628	-

PL 460000 MC - Sonsuz Dişli Redüktör Adaptörleri (PMRV/PRV) / Worm Gearbox Adaptors (PMRV/PRV) / Anschluss Für Schneckengetriebe (PMRV/PRV) / Predisposizioni Per Riduttori A Vite Senza Fine (PMRV/PRV) / Adaptation Pour Reducteurs A Vis Sans Fin (PMRV/PRV) / Acoplamiento Para Reductores De Tornillo Sin Fin (PMRV/PRV)

PL	PMRV/PRV 050					PMRV/PRV 063					PMRV/PRV 075				
	Lm	I	h	MA	G	Lm	I	h	MA	G	Lm	I	h	MA	G
460004	-					-					-				
460005	1405.5	50	110	60	80	1415	63	113	72	95	1394	75	161	86	112.5

PL	PMRV/PRV 090					PMRV/PRV 110					PMRV/PRV 130					
	Lm	I	h	MA	G	Lm	I	h	MA	G	Lm	I	h	MA	G	
460004	-					1346.5	110	237.5	127.5	160	1352	130	277.5	147.5	180	
460005	1404	90	193	103	129.5	1418					1423.5					

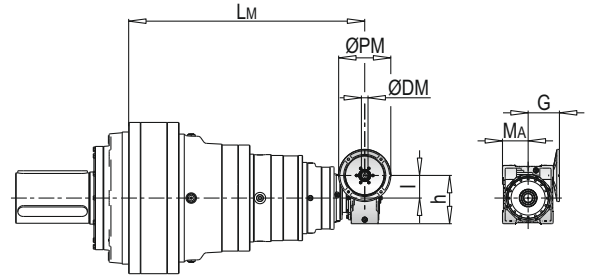

PL	PMRV/PRV 150				
	Lm	I	h	MA	G
460004	1368.5				
460005	1440	150	320	170	210

PL	PMRV/PRV ~ Kg						
	050	063	075	090	110	130	150
460004	-	-	-	-	2634	2651	2687
460005	2610	2614	2616	2621	2648	2665	2701

PLB 460000 MC - Elektrik Motor Adaptörleri (IEC) / Electric Motor Couplings (IEC) / Anbauvorrichtung Für Elektromotore (IEC) / Predisposizioni Per Motori Elettrici (IEC) / Adaptations Pour Moteurs Electriques (IEC) / Acoplamientos Para Motores Eléctricos (IEC)

PLB	IEC 80				IEC 90				IEC 100				IEC 112			
	A	L _T	Z	ØD	A	L _T	Z	ØD	A	L _T	Z	ØD	A	L _T	Z	ØD
460005	1300.5	296	56	200	1300.5	296	56	200	1300.5	306	66	250	1300.5	306	66	250

PLB	IEC 132				IEC 160				IEC 180			
	A	L _T	Z	ØD	A	L _T	Z	ØD	A	L _T	Z	ØD
460005	1300.5	340	100	300	1300.5	379	139	350	1300.5	379	139	350

PLB	IEC ~ Kg						
	80	90	100	112	132	160	180
460005	2609	2609	2610	2610	2614	2624	2624

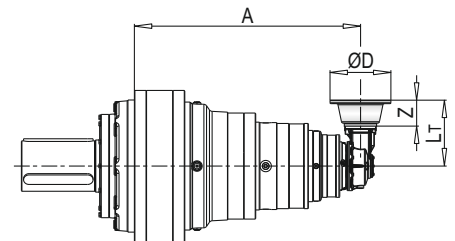

PLB 460000 MC - Giriş Milleri / Input Shafts / Antriebswellen / Alberi Entrata / Arbres D'entree / Ejes De Entrada

PLB	EM 65					EM 1"3/8 Z6					EP 65				
	A	L _T	Z	L	Ød	A	L _T	Z	L	Ød	A	L _T	Z	L	Ød
460005	1300.5	1405.5	121.5	105	65	1300.5	1405.5	121.5	105	1"3/8	1300.5	1437	153	105	65

PLB	~ Kg		
	EM 65	EM 1"3/8 Z6	EP 65
460005	2619	2619	2627

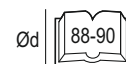
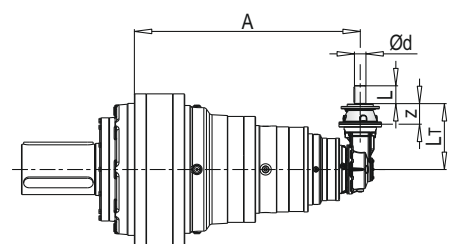

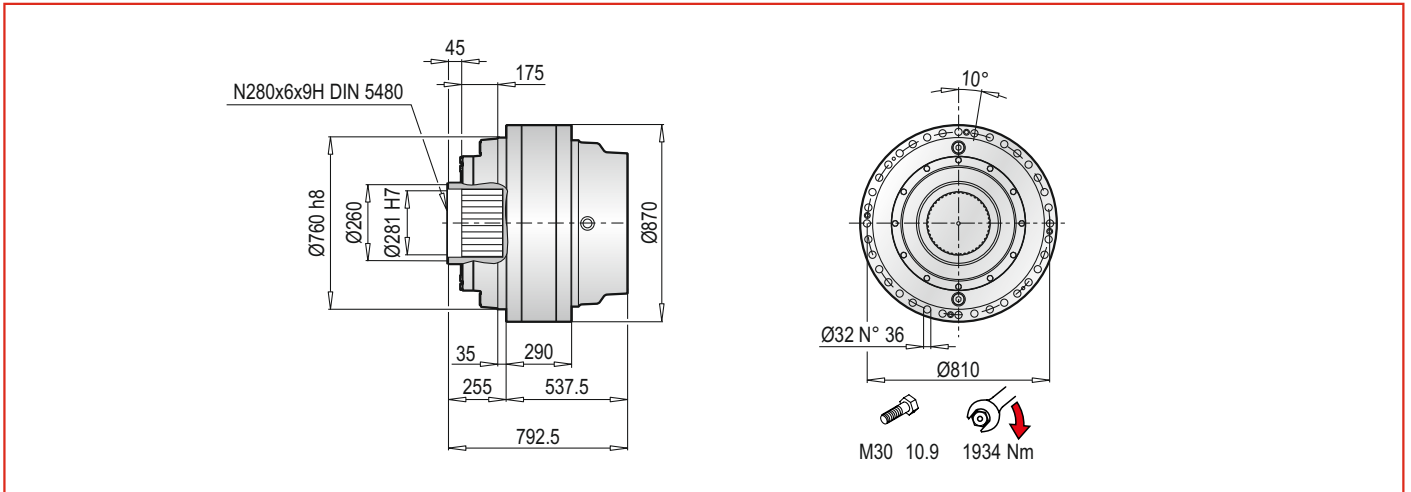

PL 460000 F - Elektrik Motor Adaptörleri (IEC) / Electric Motor Couplings (IEC) /Anbauvorrichtung Für Elektromotore (IEC) / Predisposizioni Per Motori Elettrici (IEC) / Adaptations Pour Moteurs Electriques (IEC) /Acoplamientos Para Motores Eléctricos (IEC)

PL	IEC 63			IEC 71			IEC 80			IEC 90			IEC 100			IEC 112			IEC 132						
	L _T	Z	ØD	L _T	Z	ØD	L _T	Z	ØD	L _T	Z	ØD	L _T	Z	ØD	L _T	Z	ØD	L _T	Z	ØD				
460001	-	-	-	-	-	-	-	-	-	-	-	-	-	-	-	-	-	-	-	-	-	-	-	-	
460002	-	-	-	-	-	-	-	-	-	-	-	-	-	-	-	-	-	-	-	-	-	-	-	-	
460003	-	-	-	-	-	-	-	-	-	-	-	-	-	-	-	-	-	-	-	-	-	-	-	-	
460004	-	-	-	-	-	-	-	-	-	-	-	-	-	-	-	-	-	-	-	-	-	-	-	-	
460005	1320	36	140	1320	36	160	1340	56	200	1340	56	200	1350	66	250	1350	66	250	1384	100	300				

PL	IEC 160			IEC 180			IEC 200			IEC 225			IEC 250			IEC 280					
	L _T	Z	ØD	L _T	Z	ØD	L _T	Z	ØD	L _T	Z	ØD	L _T	Z	ØD	L _T	Z	ØD			
460001	687.5	-	-	687.5	-	-	687.5	-	-	676.5	-	-	676.5	-	-	676.5	-	-			
460002	1034.5	150	-	1034.5	150	-	1034.5	150	400	1023.5	139	450	1023.5	139	550	1023.5	139	550			
460003	1255.5	-	350	1255.5	-	350	1255.5	-	-	1244.5	-	-	1244.5	-	-	1244.5	-	-			
460004	1330.5	118	-	1330.5	118	-	1360.5	148	-	1351.5	-	-	1361	148.5	-	1361	148.5	-			
460005	1423	139	-	1423	139	-	-	-	-	-	-	-	-	-	-	-	-	-			

PL	IEC ~ Kg												
	63	71	80	90	100	112	132	160	180	200	225	250	280
460001	-	-	-	-	-	-	-	1935	1935	1940	1946	1958	1970
460002	-	-	-	-	-	-	-	2340	2340	2345	2351	2363	2375
460003	-	-	-	-	-	-	-	2456	2456	2461	2467	2479	2491
460004	-	-	-	-	-	-	-	2460	2460	2470	2475	2516	2518
460005	2457	2457	2459	2459	2460	2460	2464	2474	2474	-	-	-	-

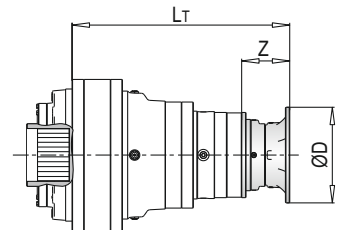

PL 460000 F - Giriş Milleri / Input Shafts / Antriebswellen / Alberi Entrata / Arbres D'entree / Ejes De Entrada

PL	EL C 28				EL C 42				EML 42				EML 1"3/8 Z6				EM 65				EM 1"3/8 Z6			
	L _T	Z	L	Ød	L _T	Z	L	Ød	L _T	Z	L	Ød	L _T	Z	L	Ød	L _T	Z	L	Ød	L _T	Z	L	Ød
460003	-	-	-	-	-	-	-	-	-	-	-	-	-	-	-	-	-	-	-	-	-	-	-	-
460004	-	-	-	-	-	-	-	-	-	-	-	-	-	-	-	-	1334	121.5	105	65	1334	121.5	105	1"3/8
460005	1348	64	50	28	1348	64	82	42	1378	94	82	42	1378	94	106	1"3/8	1405.5	121.5	105	65	1405.5	121.5	105	1"3/8

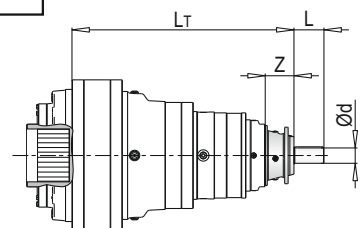

PL	EP 65				ET 90				PL	~ Kg							
	L _T	Z	L	Ød	L _T	Z	L	Ød		EL C 28	EL C 42	EML 42	EML 1"3/8 Z6	EM 65	EM 1"3/8 Z6	EP 65	ET 90
460003	-	-	-	-	1277	-	-	-	460003	-	-	-	-	-	-	-	2459
460004	1365.5	-	-	-	1384	171.5	170	90	460004	-	-	-	-	2455	2455	2464	2486
460005	1437	153	105	65	-	-	-	-	460005	2458	2458	2461	2461	2469	2469	2478	-

PL 460000 F - Sonsuz Dişli Redüktör Adaptörleri (PMRV/PRV) / Worm Gearbox Adaptors (PMRV/PRV) / Anschluss Für Schneckengetriebe (PMRV/PRV) / Predisposizioni Per Riduttori A Vite Senza Fine (PMRV/PRV) / Adaptation Pour Reducteurs A Vis Sans Fin (PMRV/PRV) / Acoplamiento Para Reductores De Tornillo Sin Fin (PMRV/PRV)

PL	PMRV/PRV 050					PMRV/PRV 063					PMRV/PRV 075				
	Lm	I	h	MA	G	Lm	I	h	MA	G	Lm	I	h	MA	G
460004	-					-					-				
460005	1405.5	50	110	60	80	1415	63	113	72	95	1394	75	161	86	112.5

PL	PMRV/PRV 090					PMRV/PRV 110					PMRV/PRV 130					
	Lm	I	h	MA	G	Lm	I	h	MA	G	Lm	I	h	MA	G	
460004	-					1346.5	110	237.5	127.5	160	1352	130	277.5	147.5	180	
460005	1404	90	193	103	129.5	1418					1423.5					

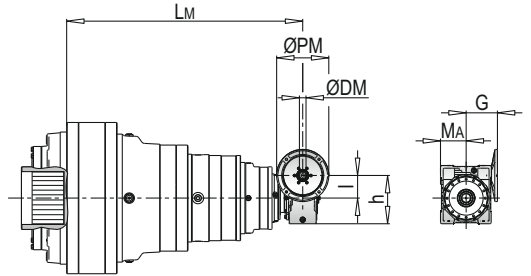

PL	PMRV/PRV 150				
	Lm	I	h	MA	G
460004	1368.5				
460005	1440	150	320	170	210

PL	PMRV/PRV ~ Kg						
	050	063	075	090	110	130	150
460004	-	-	-	-	2484	2501	2537
460005	2460	2464	2466	2471	2498	2515	2551

PLB 460000 F - Elektrik Motor Adaptörleri (IEC) / Electric Motor Couplings (IEC) / Anbauvorrichtung Für Elektromotore (IEC) / Predisposizioni Per Motori Elettrici (IEC) / Adaptations Pour Moteurs Electriques (IEC) / Acoplamientos Para Motores Eléctricos (IEC)

PLB	IEC 80				IEC 90				IEC 100				IEC 112			
	A	L _T	Z	ØD	A	L _T	Z	ØD	A	L _T	Z	ØD	A	L _T	Z	ØD
460005	1300.5	296	56	200	1300.5	296	56	200	1300.5	306	66	250	1300.5	306	66	250

PLB	IEC 132				IEC 160				IEC 180			
	A	L _T	Z	ØD	A	L _T	Z	ØD	A	L _T	Z	ØD
460005	1300.5	340	100	300	1300.5	379	139	350	1300.5	379	139	350

PLB	IEC ~ Kg						
	80	90	100	112	132	160	180
460005	2459	2459	2460	2460	2464	2474	2474

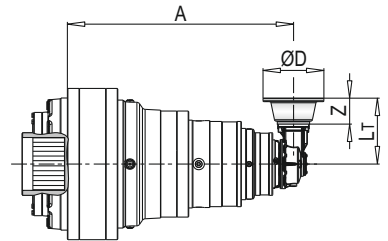

PLB 460000 F - Giriş Milleri / Input Shafts / Antriebswellen / Alberi Entrata / Arbres D'entree / Ejes De Entrada

PLB	EM 65					EM 1"3/8 Z6					EP 65				
	A	L _T	Z	L	Ød	A	L _T	Z	L	Ød	A	L _T	Z	L	Ød
460005	1300.5	1405.5	121.5	105	65	1300.5	1405.5	121.5	105	1"3/8	1300.5	1437	153	105	65

PLB	~ Kg		
	EM 65	EM 1"3/8 Z6	EP 65
460005	2469	2469	2477

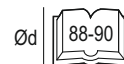
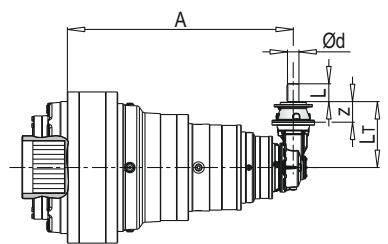

PL 460000 FS - Sonsuz Dişli Redüktör Adaptörleri (PMRV/PRV) / Worm Gearbox Adaptors (PMRV/PRV) / Anschluss Für Schneckengetriebe (PMRV/PRV) / Predisposizioni Per Riduttori A Vite Senza Fine (PMRV/PRV) / Adaptation Pour Reducteurs A Vis Sans Fin (PMRV/PRV) / Acoplamiento Para Reductores De Tornillo Sin Fin (PMRV/PRV)

PL	PMRV/PRV 050					PMRV/PRV 063					PMRV/PRV 075				
	Lm	I	h	MA	G	Lm	I	h	MA	G	Lm	I	h	MA	G
460004	-					-					-				
460005	1405.5	50	110	60	80	1415	63	113	72	95	1394	75	161	86	112.5

PL	PMRV/PRV 090					PMRV/PRV 110					PMRV/PRV 130					
	Lm	I	h	MA	G	Lm	I	h	MA	G	Lm	I	h	MA	G	
460004	-					1346.5	110	237.5	127.5	160	1352	130	277.5	147.5	180	
460005	1404	90	193	103	129.5	1418					1423.5					

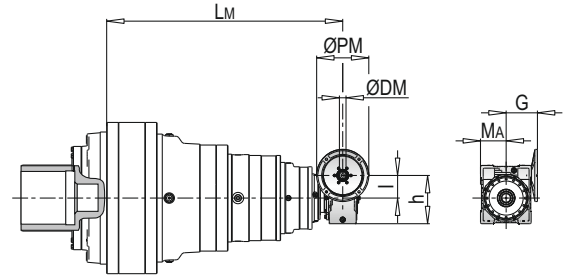

PL	PMRV/PRV 150				
	Lm	I	h	MA	G
460004	1368.5				
460005	1440	150	320	170	210

PL	PMRV/PRV ~ Kg						
	050	063	075	090	110	130	150
460004	-	-	-	-	2522	2539	2575
460005	2498	2502	2502	2507	2536	2553	2589

PLB 460000 FS - Elektrik Motor Adaptörleri (IEC) / Electric Motor Couplings (IEC) / Anbauvorrichtung Für Elektromotore (IEC) / Predisposizioni Per Motori Elettrici (IEC) / Adaptations Pour Moteurs Electriques (IEC) / Acoplamientos Para Motores Eléctricos (IEC)

PLB	IEC 80				IEC 90				IEC 100				IEC 112			
	A	L _T	Z	ØD	A	L _T	Z	ØD	A	L _T	Z	ØD	A	L _T	Z	ØD
460005	1300.5	296	56	200	1300.5	296	56	200	1300.5	306	66	250	1300.5	306	66	250

PLB	IEC 132				IEC 160				IEC 180			
	A	L _T	Z	ØD	A	L _T	Z	ØD	A	L _T	Z	ØD
460005	1300.5	340	100	300	1300.5	379	139	350	1300.5	379	139	350

PLB	IEC ~ Kg						
	80	90	100	112	132	160	180
460005	2497	2497	2498	2498	2502	2512	2512

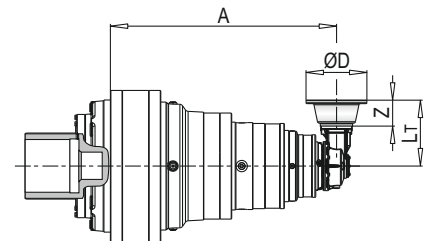

PLB 460000 FS - Giriş Milleri / Input Shafts / Antriebswellen / Alberi Entrada / Arbres D'entree / Ejes De Entrada

PLB	EM 65					EM 1"3/8 Z6					EP 65				
	A	L _T	Z	L	Ød	A	L _T	Z	L	Ød	A	L _T	Z	L	Ød
460005	1300.5	1405.5	121.5	105	65	1300.5	1405.5	121.5	105	1"3/8	1300.5	1437	153	105	65

PLB	~ Kg		
	EM 65	EM 1"3/8 Z6	EP 65
460005	2507	2507	2515

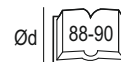
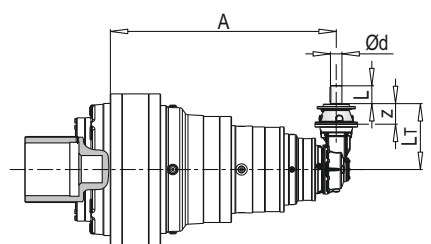

AKSESUARLAR / ACCESSORIES / ZUBEHÖR / ACCESSORI / ACCESSOIRES / ACCESORIOS

GA Konik sıkırma / Shrink disc / Schrumpfscheibe
Giunto di attrito / Frette de serrage / Disco de contracción

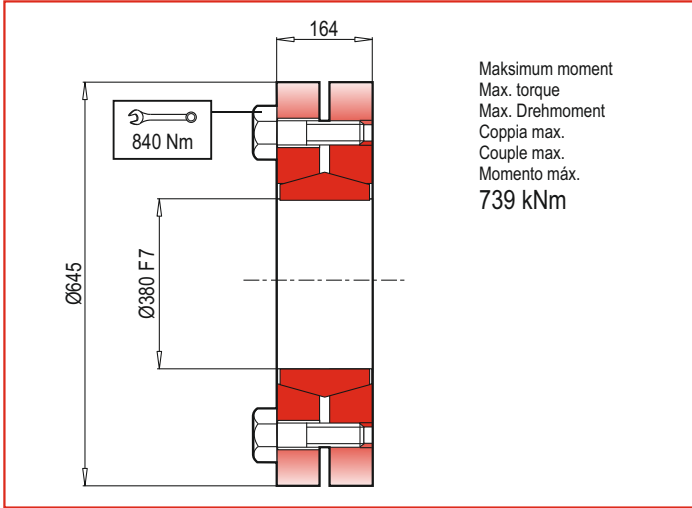

TR

RADYAL YÜKLER (Fr)

Aşağıdaki grafikler istenilen n_2xh değerinin elde edilmesi için gerekli olan radyal yükleri ve K faktörlerini göstermektedir.

EN

RADIAL LOADS (Fr)

The following curves show the radial loads and the K factors to obtain the required n_2xh value.

DE

RADIALLAST (Fr)

In den nachstehenden Diagrammen ist die Radiallast und der Koeffizient K dargestellt und kann mit dem gewünschten Wert n_2xh verglichen werden.

IT

CARICHI RADIALI (Fr)

Nei diagrammi seguenti sono riportati i carichi radiali e i coefficienti K per rapportarli al valore n_2xh desiderato.

FR

CHARGES RADIALES (Fr)

Dans les diagrammes suivants sont indiqués les charges radiales et les facteurs K de façon à obtenir la valeur n_2xh désirée.

ES

CARGAS RADIALES (Fr)

En los siguientes diagramas se indican las cargas radiales y los coeficientes K para obtener el valor requerido n_2xh .

M

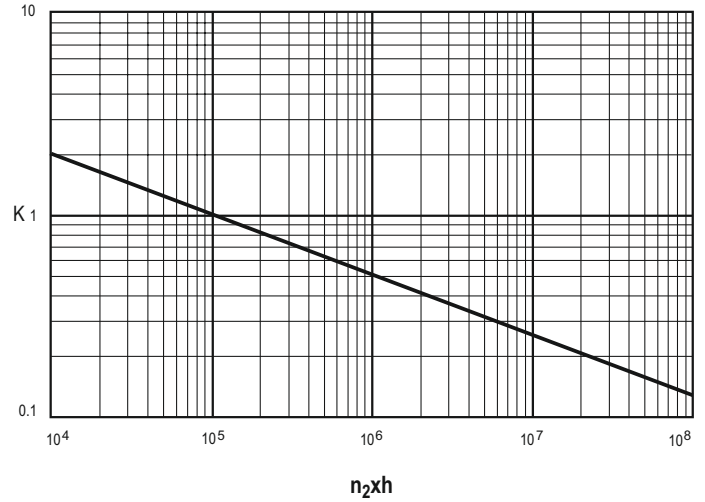
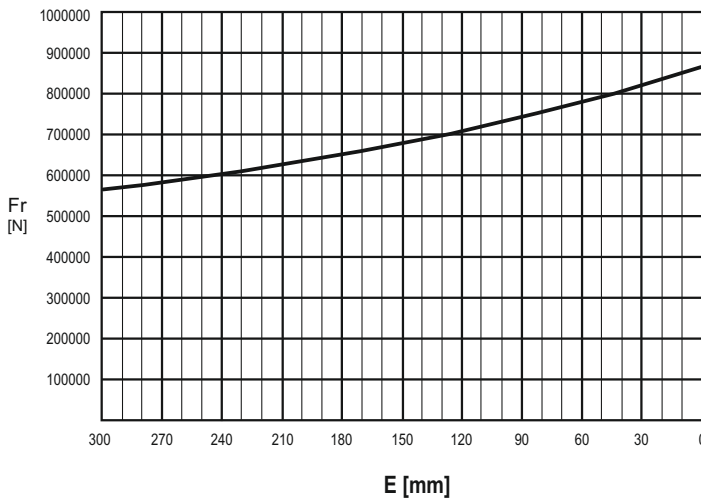

	n_2xh				
	10^5	10^4	10^6	10^7	10^8
M	Fr				Fr • K

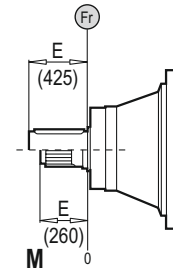

TR

EKSENEL YÜKLER (Fa)

Tabloda yer alan eksenel yük değerleri, çıkış tipine ve uygulamanın yük yönüne göre değişir.

EN

AXIAL LOADS (Fa)

The values of the axial loads in the table refer to the output versions and load direction of application.

DE

AXIALLAST (Fa)

Die dargestellten Werte der Axiallast basieren auf der Version und der applizierten Lastrichtung.

IT

CARICHI ASSIALI (Fa)

I valori dei carichi assiali indicati in tabella sono riferiti alle versioni e alla direzione di applicazione del carico.

FR

CHARGES AXIALES (Fa)

Les valeurs des charges axiales indiquées dans le tableau se réfèrent aux versions et à la direction d'application de la charge.

ES

CARGAS AXIALES (Fa)

Los valores de las cargas axiales indicados en la tabla se refieren a las versiones y a la dirección de aplicación de la carga.

Fa [N]	M	
	240000	←
160500	→	

