

TEKNİK VERİLER / TECHNICAL DATA / TECHNISCHE DATEN / DATI TECNICI / DONNÉES TECHNIQUES / DATOS TÉCNICAS

	$i_{ges}$	$M_{max}$ ( $n_2 \times h: 20000$ ) (Nm)
620001	3.84	1323900
620002	14.13 ... 18.97	933100
620003	54.07 ... 72.58	884500
620004	216.27 ... 453.62	884500
620005	792.99 ... 3175.35	884500

OUTPUT

INPUT

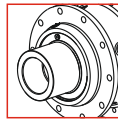
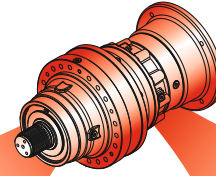

Ø320

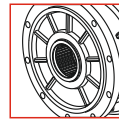

N300X8X9H  
DIN 5480

PL

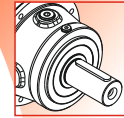

Ø28 - Ø42  
Ø1"3/8 - Ø65 - Ø90

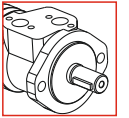

Hydraulic  
Motor

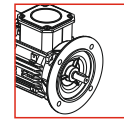

Electric  
Motor

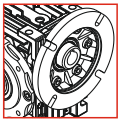

Worm  
gearboxes

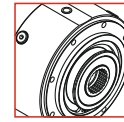

Brake

OUTPUT

INPUT

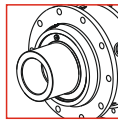
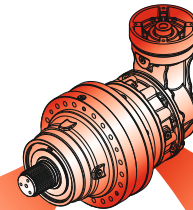

Ø320

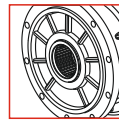

N300X8X9H  
DIN 5480

PLB



Ø1"3/8  
Ø65

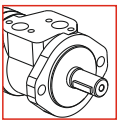

Hydraulic  
Motor

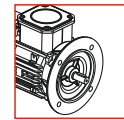



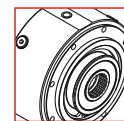



Electric  
Motor

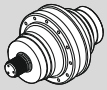

Brake

	$i_{ges}$	$M_{max}$ ( $n_2 \times h: 20000$ ) (Nm)
620005	863.53 ... 2116.90	709200

	Pt [kW]	n <sub>1max</sub> [min <sup>-1</sup> ]	i <sub>ges</sub>	Mc [kNm]				Giriş- Input - Antrieb - Entrata - Entrée - Entrada				
				n <sub>2</sub> x h	n <sub>2</sub> x h	n <sub>2</sub> x h	n <sub>2</sub> x h				EL - EML EM - EP - ET	
				10.000	20.000	50.000	100.000					160 180
<b>PL 620001</b>	324	100	3.84	972.1	875.3	762.0	706.5	160 180	200 225	250 280	-	-
<b>PL 620002</b>	185	200	14.13 18.97	729.3 525.0	622.1 472.8	472.6 411.6	383.8 370.7	160 180	200 225	250 280	-	-
<b>PL 620003</b>	129	1200	54.07 72.58	666.3 525.0	589.7 472.8	472.6 411.6	383.8 370.7	160 180	200 225	250 280	-	-
<b>PL 620004</b>	98	2000	216.27 281.15 290.32 337.92 377.41 453.62	666.3 666.3 525.0 516.9 525.0 525.0	589.7 589.7 472.8 457.6 472.8 472.8	472.6 472.6 411.6 389.4 411.6 411.6	383.8 383.8 370.7 344.6 370.7 370.7	160 180 200 225 250 280	110 130 150		ET 90	
<b>PL 620005</b>	81	2800	792.99 957.76 1030.88 1245.09 1405.75 1663.28 1887.06 1959.94 2631.00 3175.35	601.8 549.4 666.3 666.3 599.1 525.0 525.0 516.9 525.0 525.0	532.7 486.4 589.7 589.7 530.4 472.8 472.8 457.6 472.8 472.8	453.0 413.6 472.6 472.6 451.2 411.6 411.6 389.4 411.6 411.6	383.8 366.5 383.8 383.8 383.8 370.7 370.7 344.6 370.7 370.7	160 180 200 225 250 280	050 063 075 090 110 130 150		EM 65 EM 1"3/8 Z6 EP 65	

	Pt [kW]	n <sub>1max</sub> [min <sup>-1</sup> ]	i <sub>ges</sub>	Mc [kNm]				Giriş- Input - Antrieb - Entrada - Entrée - Entrada	
				n <sub>2</sub> x h	n <sub>2</sub> x h	n <sub>2</sub> x h	n <sub>2</sub> x h		
				10.000	20.000	50.000	100.000	IEC (B5)	EL - EML EM - EP - ET
<b>PLB 620005</b>	75	2500	863.53	552.0	448.5	340.8	276.9	160 180 200 225 250 280	EM 65 EM 1 <sup>3</sup> / <sub>8</sub> Z6 EP 65
			1037.90	516.9	457.6	387.6	315.0		
			1159.20	525.0	472.8	411.6	340.3		
			1312.03	503.8	409.0	310.6	252.1		
			1393.26	525.0	472.8	411.6	370.7		
			1576.96	516.9	457.6	353.2	286.7		
			1761.26	525.0	472.8	381.6	309.9		
2116.90	525.0	472.8	411.6	352.4					



$$M_{\max} = M_C \times 1.5$$

(n<sub>2</sub> x h = 20.000)

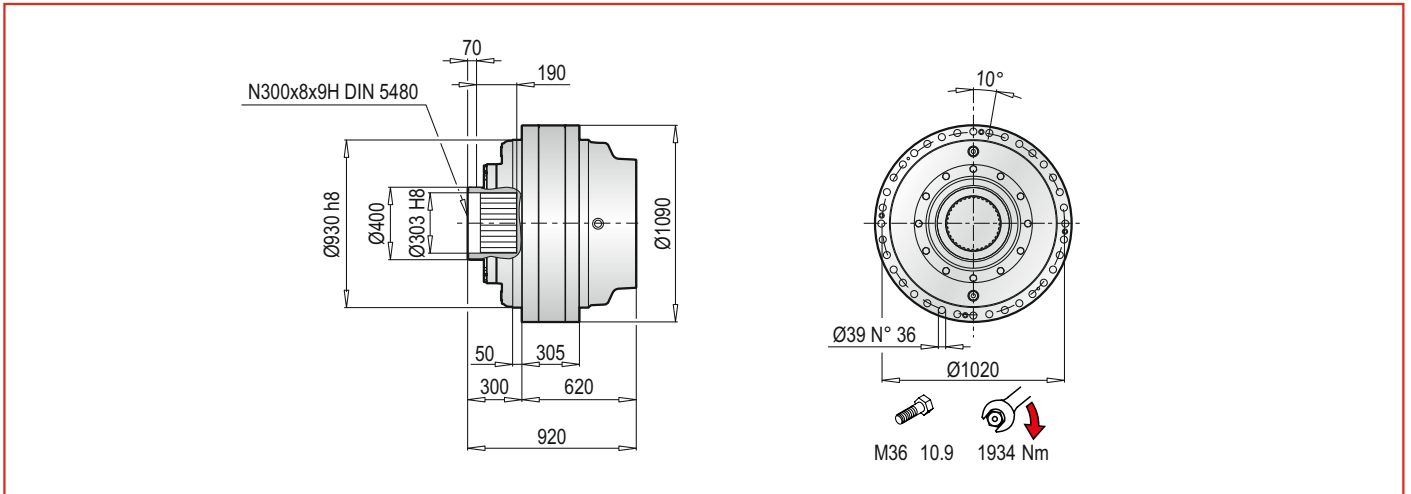

**PL 620000 F - Elektrik Motor Adaptörleri (IEC) / Electric Motor Couplings (IEC) /Anbauvorrichtung Für Elektromotore (IEC) / Predisposizioni Per Motori Elettrici (IEC) / Adaptations Pour Moteurs Electriques (IEC) /Acoplamientos Para Motores Eléctricos (IEC)**

PL	IEC 160			IEC 180			IEC 200			IEC 225			IEC 250			IEC 280		
	L <sub>T</sub>	Z	ØD	L <sub>T</sub>	Z	ØD	L <sub>T</sub>	Z	ØD	L <sub>T</sub>	Z	ØD	L <sub>T</sub>	Z	ØD	L <sub>T</sub>	Z	ØD
620001	770			770			770			759			759			759		
620002	1053.5	150	350	1053.5	150	350	1053.5	150	400	1042.5	139	450	1042.5	139	550	1042.5	139	550
620003	1274.5			1274.5			1274.5			1263.5			1263.5			1263.5		
620004	1381.5			1381.5			1381.5			1370.5			1370.5			1370.5		
620005	1421	118		1421	118		1451	148		1442			1451.5	148.5		1451.5	148.5	

PL	IEC ~ Kg					
	160	180	200	225	250	280
620001	3260	3260	3265	3271	3283	3295
620002	3770	3770	3775	3781	3793	3805
620003	3965	3965	3970	3976	3988	4000
620004	4024	4024	4029	4035	4047	4059
620005	4022	4022	4032	4037	4078	4080

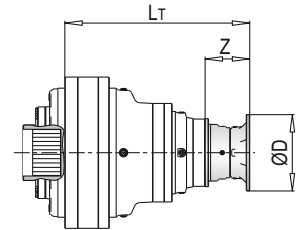

**PL 620000 F - Giriş Milleri / Input Shafts / Antriebswellen / Alberi Entrata / Arbres D'entree / Ejes De Entrada**

PL	EL C 28				EL C 42				EML 42				EML 1"3/8 Z6				EM 65				EM 1"3/8 Z6			
	L <sub>T</sub>	Z	L	Ød	L <sub>T</sub>	Z	L	Ød	L <sub>T</sub>	Z	L	Ød	L <sub>T</sub>	Z	L	Ød	L <sub>T</sub>	Z	L	Ød	L <sub>T</sub>	Z	L	Ød
620003	-	-	-	-	-	-	-	-	-	-	-	-	-	-	-	-	-	-	-	-	-	-	-	-
620004	-	-	-	-	-	-	-	-	-	-	-	-	-	-	-	-	-	-	-	-	-	-	-	-
620005	-	64	50	28	-	64	82	42	-	94	82	42	-	94	106	1"3/8	1424.5	121.5	105	65	1424.5	121.5	105	1"3/8

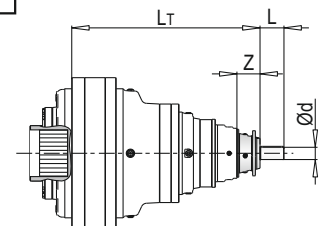

PL	EP 65				ET 90			
	L <sub>T</sub>	Z	L	Ød	L <sub>T</sub>	Z	L	Ød
620003	-	-	-	-	-	-	-	-
620004	-	153	106	65	1403	171.5	170	90
620005	1456	153	106	65	-	-	-	-

PL	~ Kg							
	EL C 28	EL C 42	EML 42	EML 1"3/8 Z6	EM 65	EM 1"3/8 Z6	EP 65	ET 90
620003	-	-	-	-	-	-	-	-
620004	-	-	-	-	-	-	-	4027
620005	-	-	-	-	4017	4017	4026	-

**PL 620000 F** - Sonsuz Dişli Redüktör Adaptörleri (PMRV/PRV) / Worm Gearbox Adaptors (PMRV/PRV) / Anschluss Für Schneckengetriebe (PMRV/PRV) / Predisposizioni Per Riduttori A Vite Senza Fine (PMRV/PRV) / Adaptation Pour Reducteurs A Vis Sans Fin (PMRV/PRV) / Acoplamiento Para Reductores De Tornillo Sin Fin (PMRV/PRV)

PL	PMRV/PRV 050					PMRV/PRV 063					PMRV/PRV 075				
	L <sub>M</sub>	I	h	M <sub>A</sub>	G	L <sub>M</sub>	I	h	M <sub>A</sub>	G	L <sub>M</sub>	I	h	M <sub>A</sub>	G
620004	-					-					-				
620005	1424.5	50	110	60	80	1434	63	113	72	95	1413	75	161	86	112.5

PL	PMRV/PRV 090					PMRV/PRV 110					PMRV/PRV 130					
	L <sub>M</sub>	I	h	M <sub>A</sub>	G	L <sub>M</sub>	I	h	M <sub>A</sub>	G	L <sub>M</sub>	I	h	M <sub>A</sub>	G	
620004	-					1365.5	110	237.5	127.5	160	1371	130	277.5	147.5	180	
620005	1423	90	193	103	129.5	1437					1442.5					

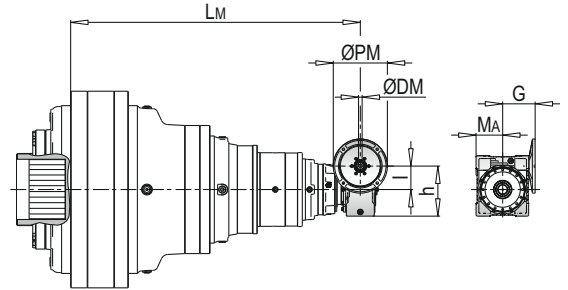

PL	PMRV/PRV 150				
	L <sub>M</sub>	I	h	M <sub>A</sub>	G
620004	1387.5				
620005	1459	150	320	170	210

PL	PMRV/PRV ~ Kg						
	050	063	075	090	110	130	150
620004	-	-	-	-	4025	4042	4078
620005	4008	4012	4014	4019	4046	4063	4099

**PLB 620000 F** - Elektrik Motor Adaptörleri (IEC) / Electric Motor Couplings (IEC) / Anbauvorrichtung Für Elektromotore (IEC) / Predisposizioni Per Motori Elettrici (IEC) / Adaptations Pour Moteurs Electriques (IEC) / Acoplamientos Para Motores Eléctricos (IEC)

PLB	IEC 160				IEC 180				IEC 200				IEC 225			
	A	L <sub>T</sub>	Z	ØD	A	L <sub>T</sub>	Z	ØD	A	L <sub>T</sub>	Z	ØD	A	L <sub>T</sub>	Z	ØD
620005	1366.5	1421	118	350	1366.5	1421	118	350	1366.5	1451	148	400	1366.5	1442	139	450

PLB	IEC 250				IEC 280			
	A	L <sub>T</sub>	Z	ØD	A	L <sub>T</sub>	Z	ØD
620005	1366.5	1451.5	148.5	550	1366.5	1451.5	148.5	550

PLB	IEC ~ Kg					
	160	180	200	225	250	280
620005	4022	4022	4032	4037	4078	4090

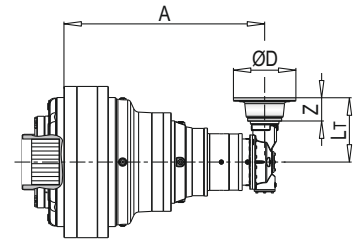

**PLB 620000 F** - Giriş Milleri / Input Shafts / Antriebswellen / Alberi Entrata / Arbres D'entree / Ejes De Entrada

PLB	EM 65					EM 1"3/8 Z6					EP 65				
	A	L <sub>T</sub>	Z	L	Ød	A	L <sub>T</sub>	Z	L	Ød	A	L <sub>T</sub>	Z	L	Ød
620005	1366.5	436.5	121.5	105	65	1366.5	436.5	121.5	105	1"3/8	1366.5	468	153	105	65

PLB	~ Kg		
	EM 65	EM 1"3/8 Z6	EP 65
620005	4017	4017	4026

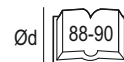
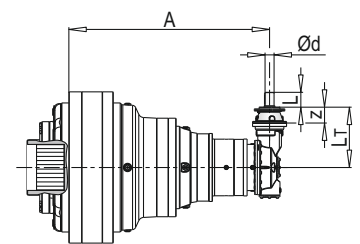

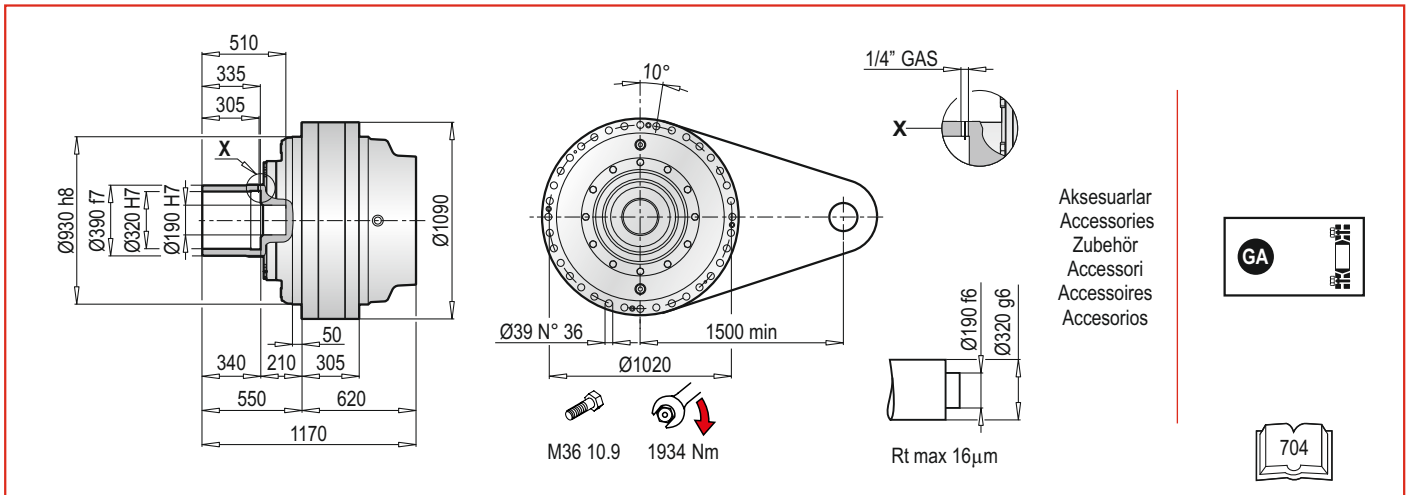

**PL 620000 FS - Elektrik Motor Adaptörleri (IEC) / Electric Motor Couplings (IEC) / Anbauvorrichtung Für Elektromotore (IEC) / Predisposizioni Per Motori Elettrici (IEC) / Adaptations Pour Moteurs Electriques (IEC) / Acoplamientos Para Motores Eléctricos (IEC)**

PL	IEC 160			IEC 180			IEC 200			IEC 225			IEC 250			IEC 280			
	L <sub>T</sub>	Z	ØD	L <sub>T</sub>	Z	ØD	L <sub>T</sub>	Z	ØD	L <sub>T</sub>	Z	ØD	L <sub>T</sub>	Z	ØD	L <sub>T</sub>	Z	ØD	
620001	770			770			770			759			759			759			
620002	1053.5	150		1053.5	150		1053.5	150	400	1042.5	139	450	1042.5	139	550	1042.5	139	550	
620003	1274.5		350	1274.5		350	1274.5			1263.5			1263.5			1263.5			
620004	1381.5			1381.5			1381.5			1370.5			1370.5			1370.5			
620005	1421	118		1421	118		1451	148		1442	139		1451.5	148.5		1451.5	148.5		

PL	IEC ~ Kg					
	160	180	200	225	250	280
620001	3317	3317	3322	3328	3340	3352
620002	3827	3827	3832	3838	3850	3862
620003	4022	4022	4027	4033	4045	4057
620004	4081	4081	4086	4092	4104	4116
620005	4079	4079	4089	4094	4135	4137

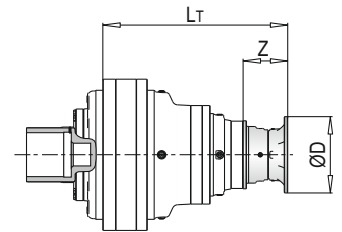
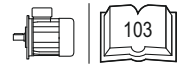

**PL 620000 FS - Giriş Milleri / Input Shafts / Antriebswellen / Alberi Entrata / Arbres D'entree / Ejes De Entrada**

PL	EL C 28				EL C 42				EML 42				EML 1"3/8 Z6				EM 65				EM 1"3/8 Z6			
	L <sub>T</sub>	Z	L	Ød	L <sub>T</sub>	Z	L	Ød	L <sub>T</sub>	Z	L	Ød	L <sub>T</sub>	Z	L	Ød	L <sub>T</sub>	Z	L	Ød	L <sub>T</sub>	Z	L	Ød
620003	-	-	-	-	-	-	-	-	-	-	-	-	-	-	-	-	-	-	-	-	-	-	-	-
620004	-	-	-	-	-	-	-	-	-	-	-	-	-	-	-	-	-	-	-	-	-	-	-	-
620005	-	64	50	28	-	64	82	42	-	94	82	42	-	94	106	1"3/8	1424.5	121.5	105	65	1424.5	121.5	105	1"3/8

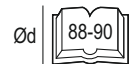

PL	EP 65				ET 90			
	L <sub>T</sub>	Z	L	Ød	L <sub>T</sub>	Z	L	Ød
620003	-	-	-	-	-	-	-	-
620004	-	-	-	-	1403	171.5	170	90
620005	1456	153	105	65	-	-	-	-

PL	~ Kg							
	EL C 28	EL C 42	EML 42	EML 1"3/8 Z6	EM 65	EM 1"3/8 Z6	EP 65	ET 90
620003	-	-	-	-	-	-	-	-
620004	-	-	-	-	-	-	-	4084
620005	-	-	-	-	4074	4074	4083	-

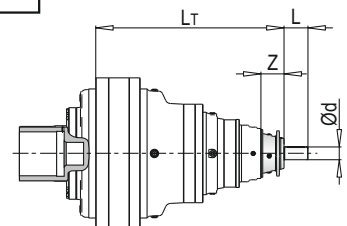

**PL 620000 FS** - Sonsuz Dişli Redüktör Adaptörleri (PMRV/PRV) / Worm Gearbox Adaptors (PMRV/PRV) / Anschluss Für Schneckengetriebe (PMRV/PRV) / Predisposizioni Per Riduttori A Vite Senza Fine (PMRV/PRV) / Adaptation Pour Reducteurs A Vis Sans Fin (PMRV/PRV) / Acoplamiento Para Reductores De Tornillo Sin Fin (PMRV/PRV)

PL	PMRV/PRV 050					PMRV/PRV 063					PMRV/PRV 075				
	L <sub>M</sub>	I	h	M <sub>A</sub>	G	L <sub>M</sub>	I	h	M <sub>A</sub>	G	L <sub>M</sub>	I	h	M <sub>A</sub>	G
620004	-					-					-				
620005	1424.5	50	110	60	80	1434	63	113	72	95	1413	75	161	86	112.5

PL	PMRV/PRV 090					PMRV/PRV 110					PMRV/PRV 130				
	L <sub>M</sub>	I	h	M <sub>A</sub>	G	L <sub>M</sub>	I	h	M <sub>A</sub>	G	L <sub>M</sub>	I	h	M <sub>A</sub>	G
620004	-					1365.5	110	237.5	127.5	160	1371	130	277.5	147.5	180
620005	1423	90	193	103	129.5	1437					1442.5				

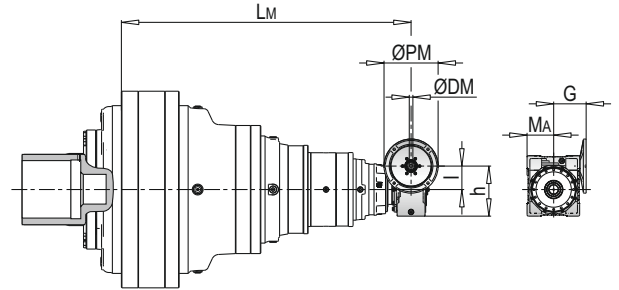

PL	PMRV/PRV 150				
	L <sub>M</sub>	I	h	M <sub>A</sub>	G
620004	1387.5				
620005	1459	150	320	170	210

PL	PMRV/PRV ~ Kg						
	050	063	075	090	110	130	150
620004	-	-	-	-	4082	4099	4135
620005	4065	4069	4071	4075	4103	4120	4156

**PLB 620000 FS** - Elektrik Motor Adaptörleri (IEC) / Electric Motor Couplings (IEC) / Anbauvorrichtung Für Elektromotore (IEC) / Predisposizioni Per Motori Elettrici (IEC) / Adaptations Pour Moteurs Electriques (IEC) / Acoplamientos Para Motores Eléctricos (IEC)

PLB	IEC 160				IEC 180				IEC 200			
	A	L <sub>T</sub>	Z	ØD	A	L <sub>T</sub>	Z	ØD	A	L <sub>T</sub>	Z	ØD
620005	1366.5	1421	118	350	1366.5	1421	118	350	1366.5	1451	148	400

PLB	IEC 225				IEC 250			
	A	L <sub>T</sub>	Z	ØD	A	L <sub>T</sub>	Z	ØD
620005	1366.5	1442	139	450	1366.5	1451.5	148.5	550

PLB	IEC ~ Kg				
	160	180	200	225	250
620005	4079	4079	4089	4094	4135

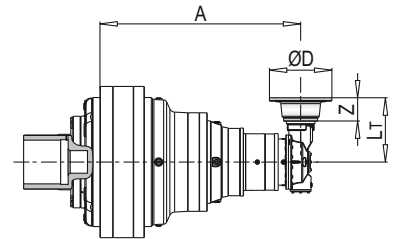

**PLB 620000 F** - Giriş Milleri / Input Shafts / Antriebswellen / Alberi Entrata / Arbres D'entree / Ejes De Entrada

PLB	EM 65					EM 1"3/8 Z6					EP 65				
	A	L <sub>T</sub>	Z	L	Ød	A	L <sub>T</sub>	Z	L	Ød	A	L <sub>T</sub>	Z	L	Ød
620005	1366.5	436.5	121.5	105	65	1366.5	436.5	121.5	105	1"3/8	1366.5	468	153	105	65

PLB	~ Kg		
	EM 65	EM 1"3/8 Z6	EP 65
620005	4074	4074	4083

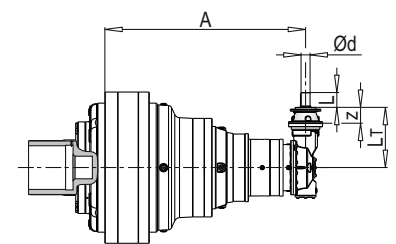

AKSESUARLAR / ACCESSORIES / ZUBEHÖR / ACCESSORI / ACCESSOIRES / ACCESORIOS

**GA** Konik sıkırma / Shrink disc / Schrumpfscheibe  
Giunto di attrito / Frette de serrage / Disco de contracción

